

Driver and Event

Name

Date

Event

Weather

Result

Track Conditions

Surface

Grip Level

Track Condition

COUGAR^{SV}
Takes 2wd to the next level

Driver Notes

Electrics and Gearing

E.S.C

Servo

Receiver

Batteries

Motor

Spur Pinion

Ext Gears 34/22 ☐

33/23 ☐

32/24 ☐

Wheels and Tyres

Rear Wheels

Rear Tyre

Rear Insert

Front Wheels

Front Tyre

Front Insert

Differential Height

High ☐

Low ☐

Topdeck

Stiff ☐

Medium ☐

Soft ☐

Rear Shocks

Oil Spring

Ball Short ☐

Socket Long ☐

Piston Holes 2 ☐ 3 ☐ 4 ☐ 5 ☐ 6 ☐

Shock Length



Front Shocks

Oil Spring

Piston Holes 2 ☐ 3 ☐ 4 ☐ 5 ☐ 6 ☐

Shock Length



Rear Suspension

Anti roll bar No ☐ 1.20 ☐ 1.40 ☐ 1.60 ☐

Strap 3° ☐ 4° ☐ 5° ☐

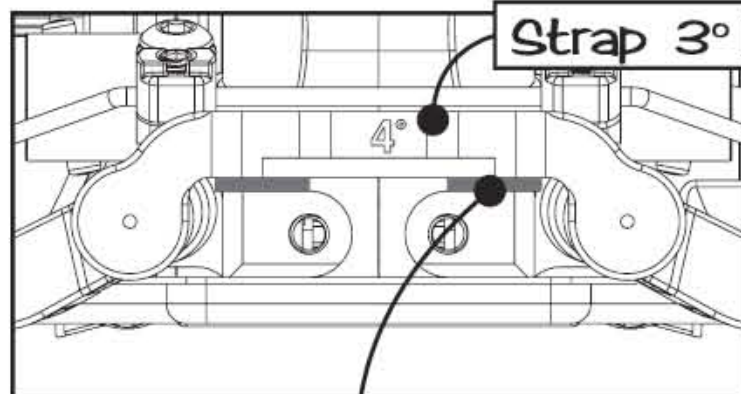

Link Washers mm

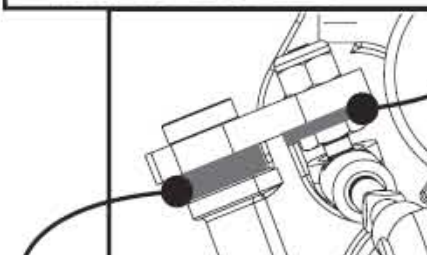

Antisquat Washers mm

Link Washers mm

Shock Postion Front ☐ Rear ☐

Wheelbase Short ☐ Med ☐ Long ☐

Rear Camber at Ride Height

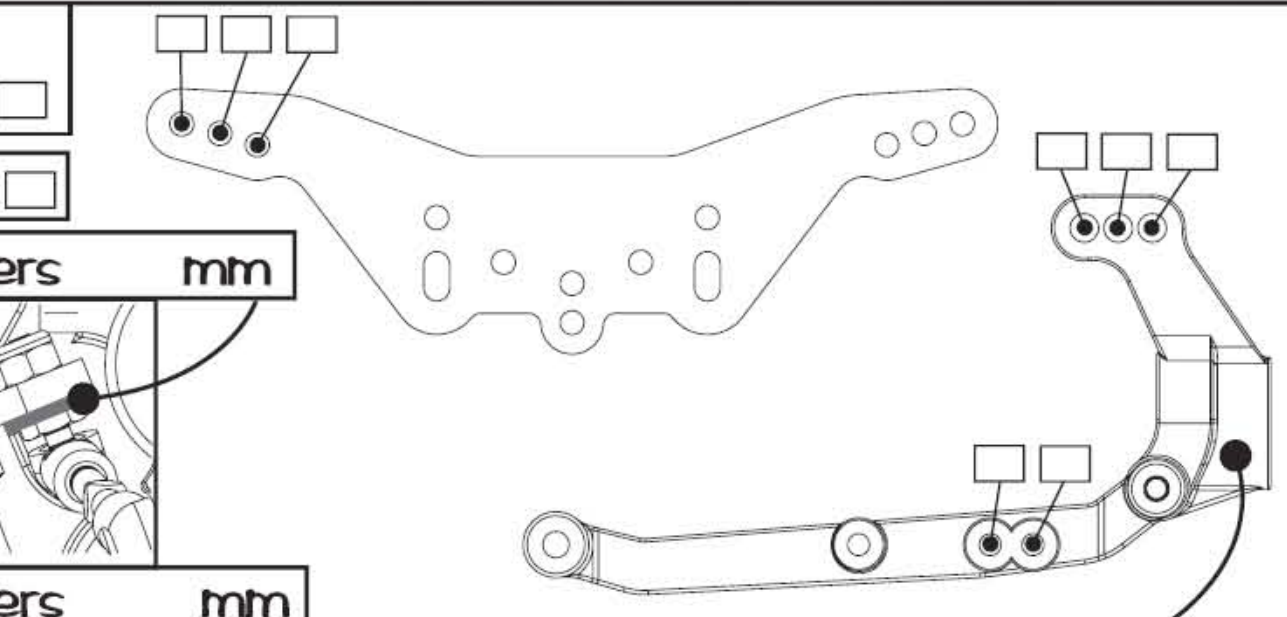

Rear Hub Carrier Alloy ☐ Std ☐

Alloy Hub Carrier +1° ☐ -1° ☐

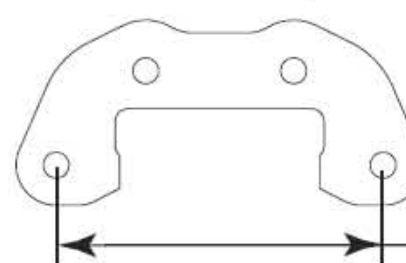

49 ☐ 44 ☐ 39 ☐ 34 ☐

Front Suspension

Link Washers mm

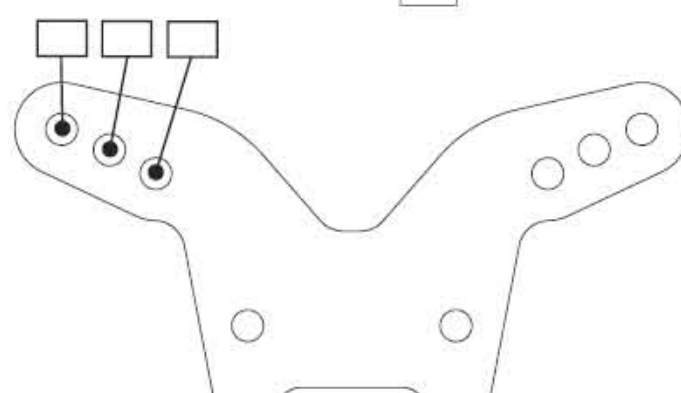
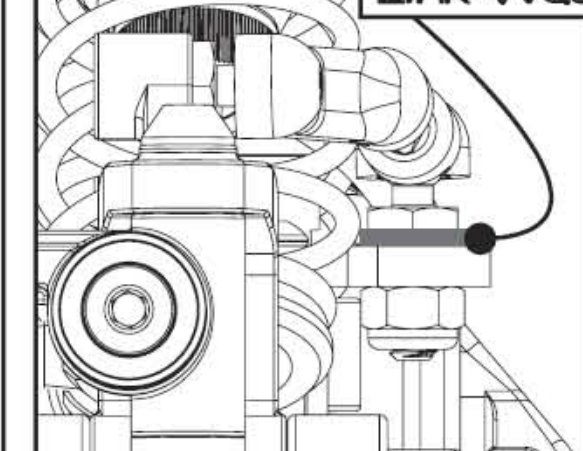

Yoke 0° ☐ 5° ☐

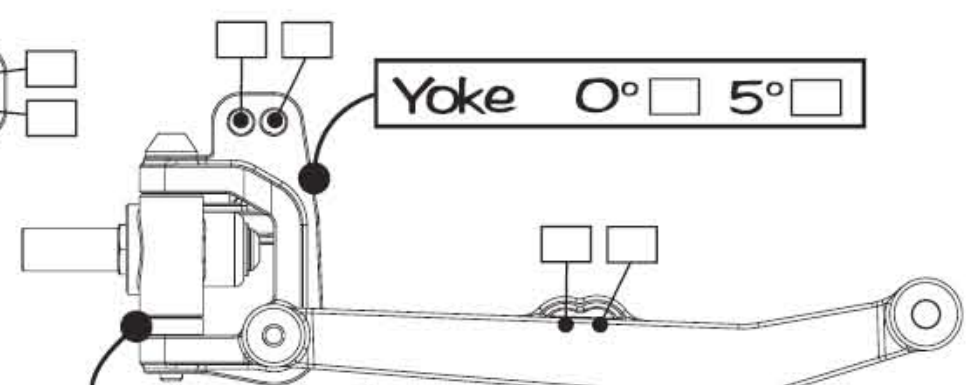

Hub Carrier High ☐ Low ☐

Front Camber at Ride Height

Front Toe In

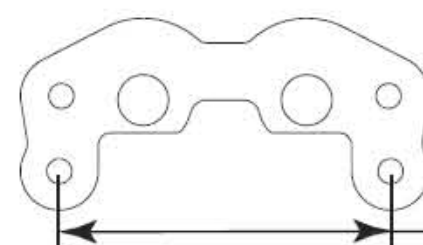

50.5 ☐ 45.5 ☐ 40.5 ☐