

U4160 - Rear Alloy Block Conversion Set - CAT K1

The alloy rear block conversion gives the car more options for the rear anti-squat and toe in, as well as increasing strength of the suspension mounts. Increasing toe in will increase straight line drive and rotation through the corners. Increasing anti-squat will reduce weight transfer on acceleration, increasing on power steering. Reducing anti-squat will make the car go over bumps better.

CAT K1

Step 1

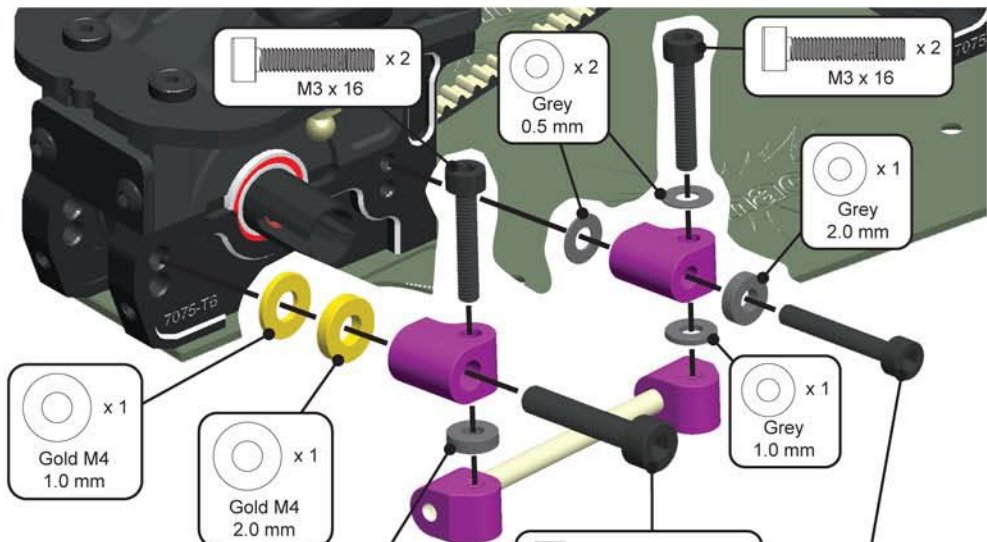

Step 2

