

Name: <u>Tom Owen</u>		Date: <u>09/03/14</u>	Event: <u>Club Night</u>
City: <u>Caldicot</u>		State: <u>N/A</u>	
Track Conditions: <input checked="" type="checkbox"/> Indoor <input type="checkbox"/> Tight <input type="checkbox"/> Smooth <input type="checkbox"/> Hard Packed <input type="checkbox"/> Blue Groove <input type="checkbox"/> Wet <input type="checkbox"/> Grass <input type="checkbox"/> Low Bite <input type="checkbox"/> High Bite <input type="checkbox"/> Outdoor <input type="checkbox"/> Open <input type="checkbox"/> Rough <input type="checkbox"/> Loose/Loamy <input type="checkbox"/> Dry <input type="checkbox"/> Dusty <input type="checkbox"/> Astro Turf <input type="checkbox"/> Med Bite <input type="checkbox"/> Other <u>Carpet and polish</u>			
Track: <u>Indoor, Offroad,</u>			

Front Suspension

Toe: -1 deg

Ride Height: 18mm

Camber: -2 deg

Caster: 10° 15° 20°

Sway Bar: none, see notes

Oil: 32.5

Piston: 1.6mm

Spring: Standard Low Freq. Color: Blue

Shock Limiters: 2mm

Shock Location: 2-inside

Bump Steer Ball Stud: Standard Low Mount

Bumper Steer Spacers: _____

Camber Link: 3

Ackermann: B

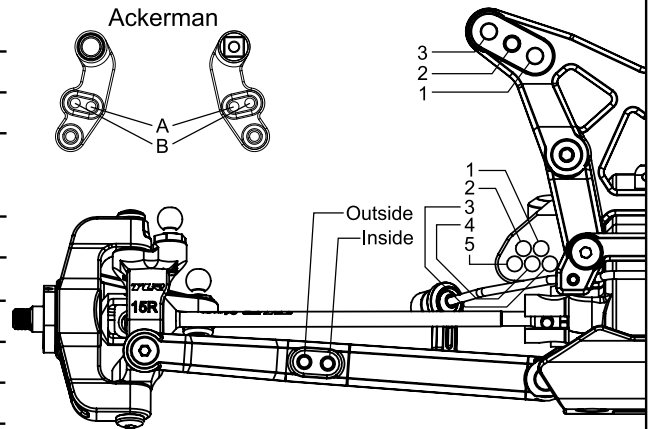

Notes: Too much grip with new tires, use anti-roll bars front and back to tame the car, remove when the tires wear in a little.

Rear Suspension

Toe: 3 deg

Anti-Squat: _____

Roll Center: Low Roll Center (LRC) High Roll Center (HRC)

Ride Height: 19mm

Camber: -2 deg

Rear Hub Spacing: Middle

Hex Width: Kit

Sway Bar: none, see notes

Oil: 25

Piston: 1.7

Spring: Standard Low Freq. Color: Yellow

Shock Limiters: None

Camber Link: 3

Shock Locations: Inside

Wing/Wickerbill: Kit

Battery Position: Back

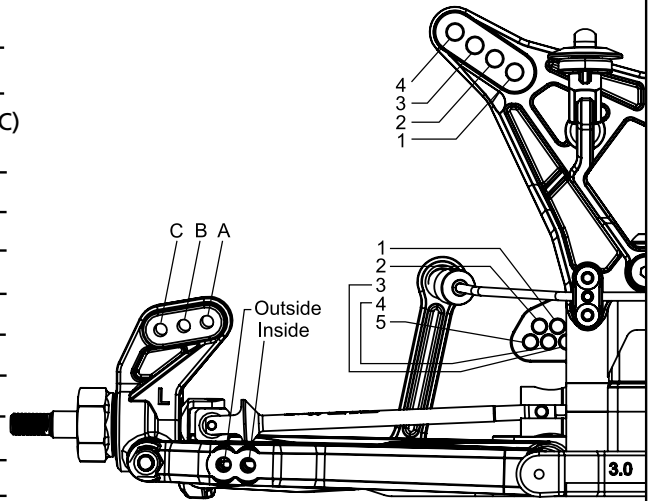

Electronics

Radio: futaba 3vcs Timing Advance: _____

Servo: savox 1258 Throttle/Brake Expo: _____

ESC: Hobbywing v3.1 Servo Expo: _____

Initial Brake: _____ Throttle/Brake EPA: _____

Drag Brake: _____ Motor: 5.5T

Throttle Profile: _____ Pinion: kit Spur: Kit

Battery: _____

Tires	Compound	Insert	Additive
Front: <u>Schu mini pin</u>	<u>yellow</u>	<u>med</u>	_____
Rear: <u>Schu mini pin</u>	<u>yellow</u>	<u>med</u>	_____

Notes: Inside and outside row cut off front, outside row cut off back, med anti roll bar connected front and back when tires are brand new!