

Name: <u>Martin Sørlie</u>		Date: <u>02.03.14</u>	Event: <u>Norgescup 1</u>
City: <u>Oslo</u>		State: _____	
Track Conditions: <input type="checkbox"/> Indoor <input checked="" type="checkbox"/> Outdoor <input checked="" type="checkbox"/> Tight <input type="checkbox"/> Open <input type="checkbox"/> Smooth <input checked="" type="checkbox"/> Rough <input checked="" type="checkbox"/> Hard Packed <input type="checkbox"/> Loose/Loamy <input type="checkbox"/> Blue Groove <input type="checkbox"/> Dry <input checked="" type="checkbox"/> Wet <input type="checkbox"/> Dusty <input type="checkbox"/> Grass <input checked="" type="checkbox"/> Astro Turf <input type="checkbox"/> Low Bite <input checked="" type="checkbox"/> Med Bite <input type="checkbox"/> High Bite <input type="checkbox"/> Other _____			

Front Suspension

Toe: 0

Ride Height: 17mm

Camber: 1

Caster: 10° 15° 20°

Sway Bar: _____

Oil: 30

Piston: 2x1.6

Spring: Standard Low Freq. Color: Silver

Shock Limiters: 2mm

Shock Location: 2-Outside

Bump Steer Ball Stud: Standard Low Mount

Bumper Steer Spacers: 3mm

Camber Link: 3

Ackermann: Std.

Notes: Tight clicker with hardest spring.

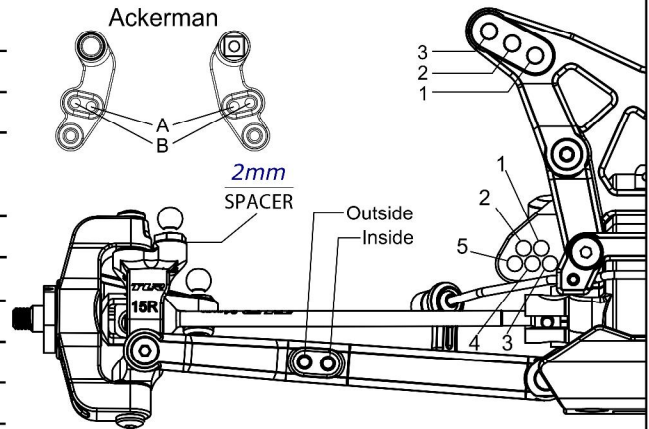

- TLR331012 Aluminum Servo Mount
- TLR334007 Aluminum Front Spindle
- TLR334009 Aluminum Steering Bellcrank

Rear Suspension

Toe: 3

Anti-Squat: 2

Roll Center: Low Roll Center (LRC) High Roll Center (HRC)

Ride Height: 19mm

Camber: 1

Rear Hub Spacing: Middle

Hex Width: Std.

Sway Bar: Yellow

Oil: 25

Piston: 2x1.7

Spring: Standard Low Freq. Color: Yellow

Shock Limiters: 0

Camber Link: 5-C

Shock Locations: 3-inside

Wing/Wickerbill: Cut by lowest line

Battery Position: Forward

Notes: _____

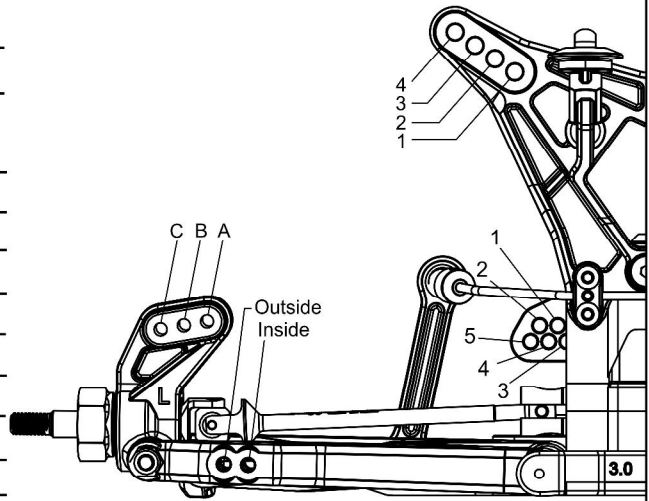

- TLR334008 Aluminum Rear Hub

Editable by Arn0 at Pelitrc.com

Electronics

Radio: <u>Spektrum DX4R Pro</u>	Timing Advance: _____
Servo: <u>Spektrum S6090</u>	Throttle/Brake Expo: _____
ESC: <u>Absima Revenge CTS10</u>	Servo Expo: _____
Initial Brake: <u>Drag</u>	Throttle/Brake EPA: _____
Drag Brake: <u>4%</u>	Motor: <u>Absima Revenge CTM 5.5 Turn</u>
Throttle Profile: <u>5</u>	Pinion: <u>18</u> Spur: <u>84</u>
	Battery: <u>Yuntong 4800 Mah Saddle</u>

Tires

	Compound	Insert	Additive
Front: <u>Ballistic Minispikes</u>	<u>Green</u>	<u>Schu Medium</u>	_____
Rear: <u>Ballistic Minispikes</u>	<u>Green</u>	<u>Schu Medium</u>	_____

Notes: Quite easy to drive, should have had a 6.5 turn. Would like more rear end support, yet more steering/rotation.