



NAME Leon McIntosh		DATE 2014-11-05	TRACK Lake Park
CITY Tampa	COUNTRY USA		EVENT Outdoor - Supercup
TRACTION LEVEL <input type="radio"/> HIGH <input checked="" type="radio"/> MEDIUM <input type="radio"/> LOW		TRACK TYPE <input checked="" type="radio"/> OPEN <input type="radio"/> MEDIUM <input type="radio"/> TIGHT	TRACK SIZE <input checked="" type="radio"/> LARGE <input type="radio"/> MEDIUM <input type="radio"/> SMALL
CONDITIONS <input checked="" type="checkbox"/> WET <input checked="" type="checkbox"/> DUSTY <input type="checkbox"/> LOOMY <input checked="" type="checkbox"/> DRY <input checked="" type="checkbox"/> GROOVED <input type="checkbox"/> ROUGH		SURFACE <input type="checkbox"/> INDOORS <input type="checkbox"/> GRAVEL <input type="checkbox"/> CARPET <input checked="" type="checkbox"/> OUTDOORS <input type="checkbox"/> ASTRO <input type="checkbox"/> ASPHALT	

Front Suspension

Toe: 0 to -1

Ride Height: 20.5mm

Camber: -2

Caster: ☐ 10° ☒ 15° ☐ 20°

Sway Bar: none

Oil: 35 wt TLR oil

Piston: 1.6 x 2

Spring: ☒ Standard ☐ Low Freq. Color: truck green

Shock Limiters: 2mm

Shock Location: 1 -inside

Bump Steer Ball Stud: ☒ Standard ☐ Low Mount

Bumper Steer Spacers: 2mm

Camber Link: 1

Ackermann: B

Ackerman

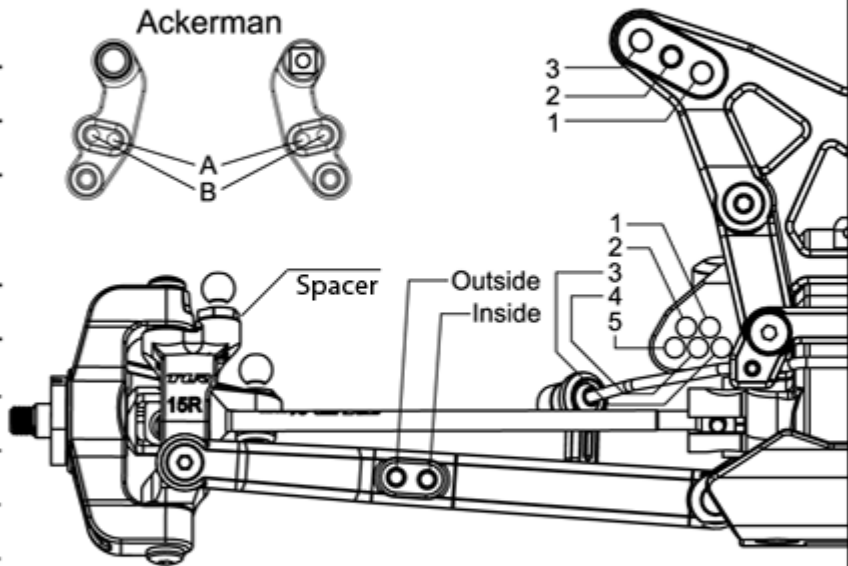
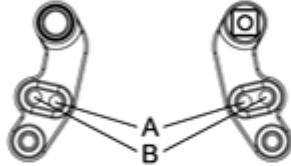

Notes: Changed front oil, piston, and spring to accommodate slippery conditions and still have steering.

Rear Suspension

Toe: 3 degrees

Anti-Squat: 2 degrees

Roll Center: ☒ Low Roll Center (LRC) ☐ High Roll Center (HRC)

Ride Height: 21 mm

Camber: -2

Rear Hub Spacing: Middle

Hex Width: +1.5mm

Sway Bar: Pink

Oil: 32.5 wt.

Piston: 1.6x2

Spring: ☐ Standard ☒ Low Freq. Color: Red

Shock Limiters: None, unscrewed 2mm

Camber Link: 2 - B

Shock Locations: 2 - Outside

Wing/Wickerbill: Stock, 1/4"

Battery Position: Shorty left

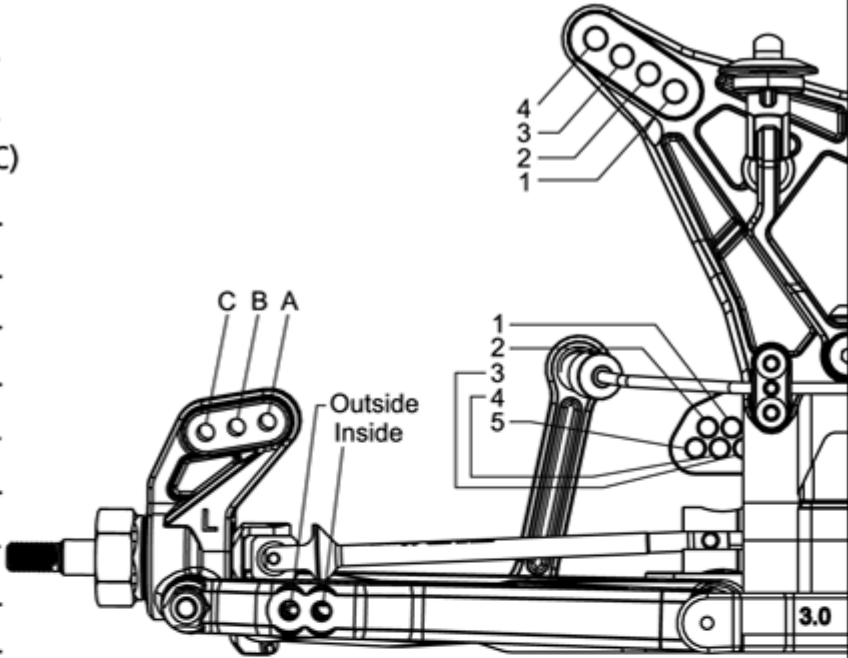

Electronics

Radio: DX4R

Servo: _____

ESC: Hobbywing V3.1

Initial Brake: _____

Drag Brake: _____

Throttle Profile: _____

Timing Advance: _____

Throttle/Brake Expo: -15/0

Servo Expo: _____

Throttle/Brake EPA: _____

Motor: Trinity D4 6.5T

Pinion: 17 Spur: _____

Battery: Trinity 100C Shorty

Notes: Probably should have went to a softer rear swaybar. would have helped as the tires wore during the race.

Tires	Compound	Insert	Additive
Front: <u>Proline Scrub</u>	<u>M3</u>	<u>Closed Cell</u>	<u>sticky kicks blue</u>
Rear: <u>Proline Suburb</u>	<u>M4</u>	<u>Closed Cell</u>	<u>sticky kicks blue</u>

Notes: Car was really good and fast. TQ'd and finished 2nd. Super easy to drive only got a little squirrely around the 3-4 minute mark as the tires wore. could probably have softened the rear a touch to help with this. Need to try the 2.5 degree rear toe block as well.