

Name: Richard Taylor

Date: October 2013

Event: Chadderton

City: State:

Track:

Track Conditions: Indoor Tight Smooth Hard Packed Blue Groove Wet Grass Low Bite High Bite
 Outdoor Open Rough Loose/Loamy Dry Dusty Astro Turf Med Bite Other Gym Floor (Slippery)

Front Suspension

Toe: 0 degree
 Ride Height: 23mm
 Camber: -1.5degree
 Caster: 0° 5° Trail: 2mm 4mm
 Kick Angle: 20° 25° 30°
 Sway Bar: N/A
 Oil: 35wt
 Piston: 54 x 4
 Spring: Standard Low Freq. Color: Blue
 Front Pivot: Aluminum Plastic HRC
 Kick Shim: Brass Plastic
 Shock Limiters: 2mm
 Shock Location: 2 - Outside
 Bump Steer Ball Stud: Standard Low Mount
 Bumper Steer Spacers: 0mm
 Ackermann Ball Stud: Standard Low Mount
 Ackermann Spacers: 0 Washers
 Camber Link: 1 - B

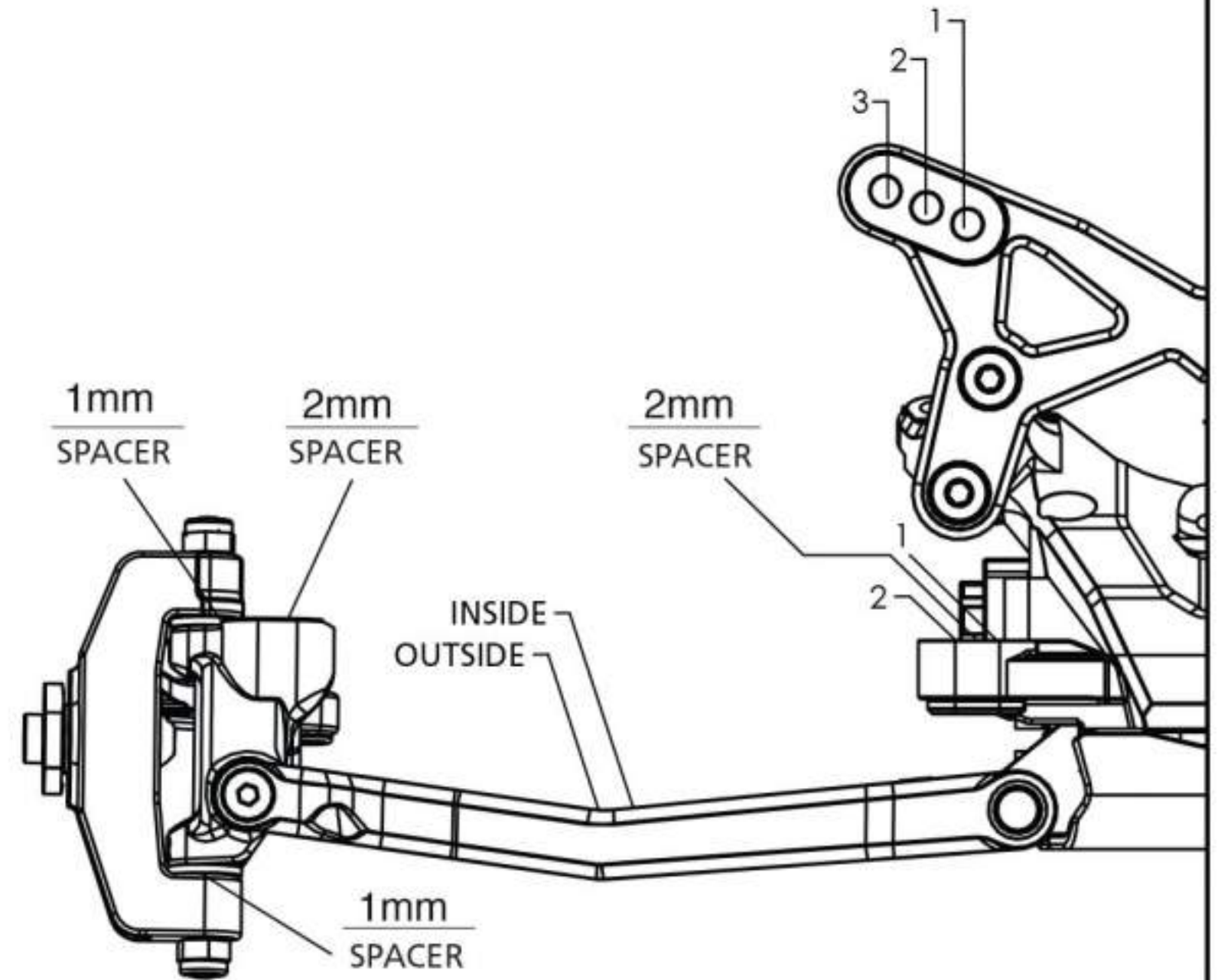

Notes: ESC Mounted on Chassis behind Servo

Ball Diff used

Rear Suspension

Chassis Configuration: Rear Motor Mid Motor
 Toe: 3 Degree
 Anti-Squat: 2 degree
 Roll Center: Low Roll Center (LRC) High Roll Center (HRC)
 Ride Height: 23mm
 Camber: -1 degrees
 Rear Hub Spacing: Short
 Hex Width: Kit
 Sway Bar: N/A
 Oil: 25wt
 Piston: 54 x 4
 Spring: Standard Low Freq. Color: Yellow LF
 Shock Limiters: 0mm
 Camber Link: 1 - D
 Shock Locations: 2 - Middle
 Wing/Wickerbill: Cut to bottom line on 2.0 Wing
 Battery Position: Saddle

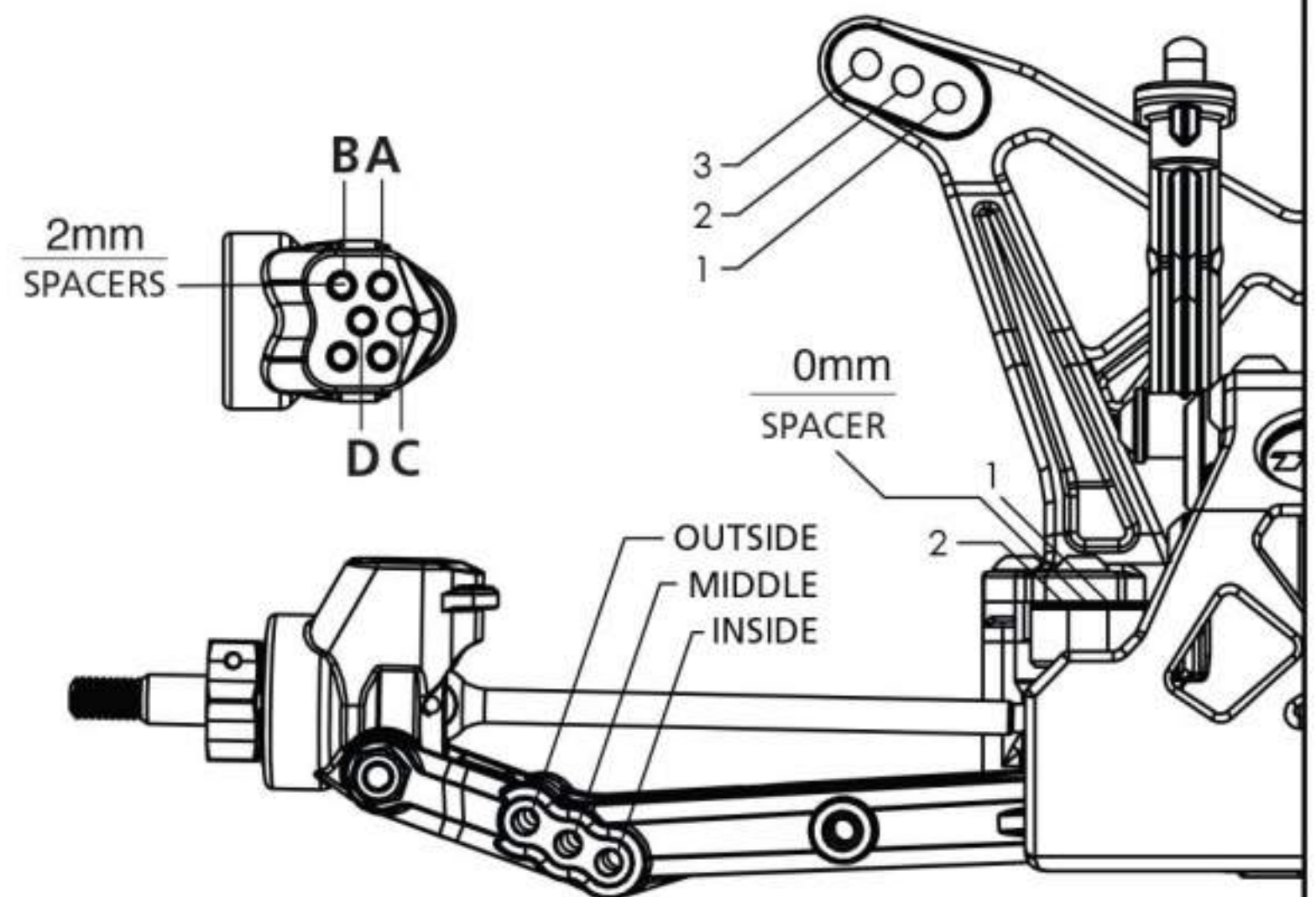

Electronics

Radio: _____ Timing Advance: _____
 Servo: _____ Throttle/Brake Expo: _____
 ESC: _____ Servo Expo: _____
 Initial Brake: _____ Throttle/Brake EPA: _____
 Drag Brake: _____ Motor: 7.5
 Throttle Profile: _____ Pinion: 20 Spur: 76
 Battery: _____

Weight Placement (Mark with "X")



Weight of each piece 40g oz./g

Tires	Compound	Insert	Additive
Front: <u>D Boots</u>	_____	<u>Losi Cloud</u>	_____
Rear: <u>D Boots</u>	_____	<u>Losi Cloud</u>	_____
Notes: _____	_____	_____	_____