

Name: 榎本 圭介 Date: 2014/7/1 Event: \_\_\_\_\_  
 City: \_\_\_\_\_ State: \_\_\_\_\_ Track: YATABEアリーナ

Track Conditions:  Indoor  Tight  Smooth  Hard Packed  Blue Groove  Wet  Grass  Low Bite  High Bite  
 Outdoor  Open  Rough  Loose/Loamy  Dry  Dusty  Astro Turf  Med Bite  Other \_\_\_\_\_

**Front Suspension**

Toe: -1°  
 Ride Height: 18mm  
 Camber: -1°  
 Caster:  0°  5° Trail:  2mm  4mm  
 Kick Angle:  20°  25°  30°  
 Sway Bar: No  
 Oil: 40  
 Piston: 1.7x2  
 Spring:  Standard  Low Freq. Color: GREEN  
 Front Pivot:  Aluminum  Plastic  HRC  
 Kick Shim:  Brass  Plastic  
 Shock Limiters: 1mm  
 Shock Location: 1-Inside  
 Bump Steer Ball Stud:  Standard  Low Mount  
 Bumper Steer Spacers: 1mm  
 Ackermann Ball Stud:  Standard  Low Mount  
 Ackermann Spacers: 0mm  
 Camber Link: 1-Inside

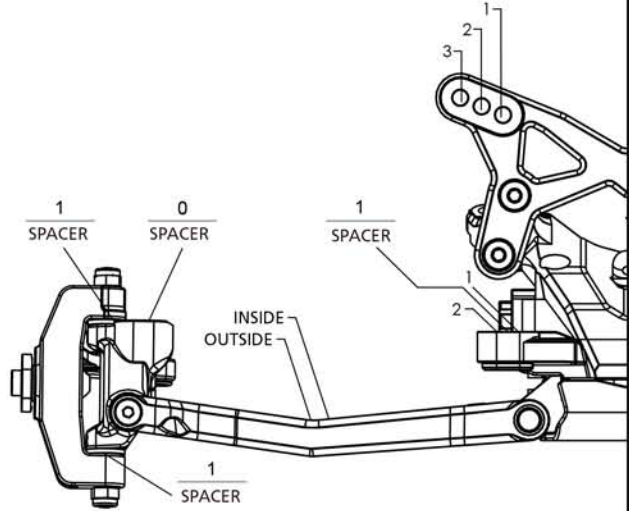

Notes: TLR1550, TLR1557, TLR2059, TLR331010  
 TLR331011, TLR334005使用

**Rear Suspension**

Chassis Configuration:  Rear Motor  Mid Motor  
 Toe: 2.5°  
 Anti-Squat: 1°  
 Roll Center:  Low Roll Center (LRC)  High Roll Center (HRC)  
 Ride Height: 18mm  
 Camber: -1°  
 Rear Hub Spacing: 2mm Front, 2mm Rear  
 Hex Width: +0.75  
 Sway Bar: No  
 Oil: 35  
 Piston: 1.7x2  
 Spring:  Standard  Low Freq. Color: PINK  
 Shock Limiters: 3mm  
 Camber Link: 2-C  
 Shock Locations: 1-Middle  
 Wing/Wickerbill: 6.5  
 Battery Position: \_\_\_\_\_

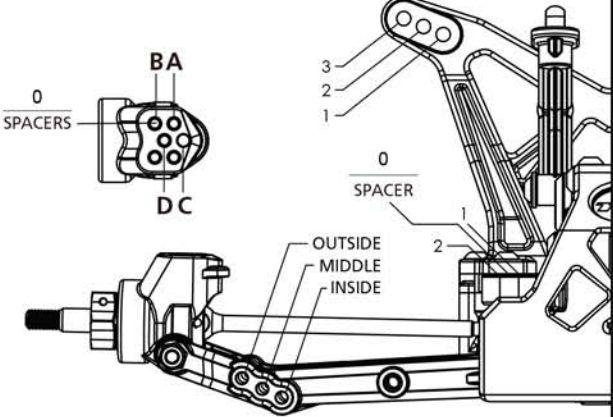

**Electronics**

Radio: 4PKS-R Timing Advance: \_\_\_\_\_  
 Servo: BLS471SV Throttle/Brake Expo: \_\_\_\_\_  
 ESC: Reventon-PRO Servo Expo: \_\_\_\_\_  
 Initial Brake: \_\_\_\_\_ Throttle/Brake EPA: \_\_\_\_\_  
 Drag Brake: \_\_\_\_\_ Motor: SP V3.0 6.5R  
 Throttle Profile: \_\_\_\_\_ Pinion: 22 Spur: 82  
 Battery: \_\_\_\_\_

Weight Placement (Mark with "X")  
  
 Weight of each piece \_\_\_\_\_ oz./g

Tires Compound Insert Additive  
 Front: YAU-6770 \_\_\_\_\_ No \_\_\_\_\_  
 Rear: YAU-6608 \_\_\_\_\_ YAU-6734 \_\_\_\_\_  
 Notes: LOSA2954(オイル6000使用)  
TLR2061, TLR2931, TLR334014使用