

Name: 榎本 圭介		Date: 2014/03/29	Event:
City: _____ State: _____		Track: YATABEアリーナ	
Track Conditions: <input checked="" type="checkbox"/> Indoor <input type="checkbox"/> Tight <input type="checkbox"/> Smooth <input type="checkbox"/> Hard Packed <input type="checkbox"/> Blue Groove <input type="checkbox"/> Wet <input type="checkbox"/> Grass <input type="checkbox"/> Low Bite <input type="checkbox"/> High Bite			
<input type="checkbox"/> Outdoor <input type="checkbox"/> Open <input type="checkbox"/> Rough <input type="checkbox"/> Loose/Loamy <input type="checkbox"/> Dry <input type="checkbox"/> Dusty <input checked="" type="checkbox"/> Astro Turf <input type="checkbox"/> Med Bite <input type="checkbox"/> Other _____			

Front Suspension

Toe: -1°
 Ride Height: 17mm
 Camber: -1°
 Caster: 0° 5° Trail: 2mm 4mm
 Kick Angle: 20° 25° 30°
 Sway Bar: No
 Oil: 37.5
 Piston: 1.3X2
 Spring: Standard Low Freq. Color: Red
 Front Pivot: Aluminum Plastic HRC
 Kick Shim: Brass Plastic
 Shock Limiters: 2mm
 Shock Location: 2-inside
 Bump Steer Ball Stud: Standard Low Mount
 Bumper Steer Spacers: 1mm
 Ackermann Ball Stud: Standard Low Mount
 Ackermann Spacers: 0
 Camber Link: 1-A

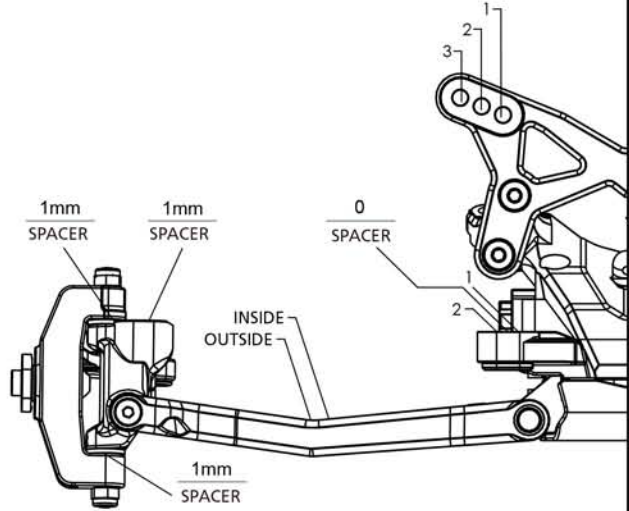

Notes: TLR1550,TLR1557,TLR2059,TLR331007, TLR331010,TLR331011,TLR334005を使用

Rear Suspension

Chassis Configuration: Rear Motor Mid Motor
 Toe: 3°
 Anti-Squat: 0
 Roll Center: Low-Roll Center (LRC) High Roll Center (HRC)
 Ride Height: 17mm
 Camber: -1°
 Rear Hub Spacing: 2mm Front, 2mm Rear
 Hex Width: Std
 Sway Bar: No
 Oil: 37.5
 Piston: 1.6x2
 Spring: Standard Low Freq. Color: Yellow
 Shock Limiters: 3mm
 Camber Link: 1-C
 Shock Locations: 1-inside
 Wing/Wickerbill: 6.5
 Battery Position: _____

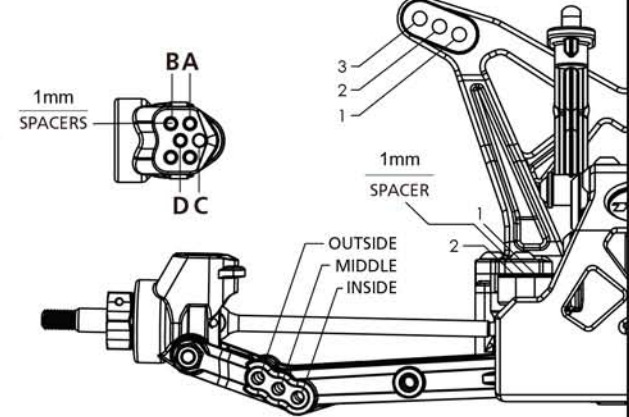

Electronics

Radio: <u>4PKS-R</u>	Timing Advance: _____
Servo: <u>BLS451</u>	Throttle/Brake Expo: _____
ESC: <u>REVENTON-PRO</u>	Servo Expo: _____
Initial Brake: _____	Throttle/Brake EPA: _____
Drag Brake: _____	Motor: <u>SP 6.5R</u>
Throttle Profile: _____	Pinion: <u>21</u> Spur: <u>78</u>
	Battery: <u>LRP4500</u>

Weight Placement (Mark with "X")  Weight of each piece <u>122</u> oz./g	Tires	Compound	Insert	Additive
	Front: <u>YAU-6770</u>	<u>Yellow</u>	<u>NO</u>	_____
	Rear: <u>YAU-6608</u>	<u>Yellow</u>	<u>AKA</u>	_____
Notes: <u>LOSA2954, TLR2061, TLR334014を使用</u>				