

FRONT:

RIDE HEIGHT 22mm
 CAMBER -1
 TOE 0
 BUMPSTEER 0
 CAMBER LINK 2 + 1mm Spacer
 SPINDLE POSITION A + 2mm Spacer
 KICK ANGLE 25 deg
 PIVOT 25 deg
 SHOCK LOCATION 2 - Middle
 PISTON 6 x 56 hole
 OIL 25 weight
 LIMITING 1mm
 SPRING F4
 TIRE Schumacher Green MiniSpike
 INSERT Losi Firm

REAR:

RIDE HEIGHT 22mm
 CAMBER -1
 PIVOT TOE 3.5 deg
 ANTI SQUAT 2 deg
 CAMBER LINK 2 + 1mm Spacer
 HUB POSITION C/B - Middle Row + 3mm spacer
 SHOCK LOCATION 2 - Inside
 PISTON 6 x 55 hole
 OIL 30 weight
 LIMITING 0
 SPRING R2
 TIRE Schumacher Green Minispikes
 INSERT Losi Firm (should use Soft)
 DRIVESHAFT Kit RCD
 DIFF TENSION _____
 GEARING 21/76
 MOTOR Xcelorin 6.5T
 BATTERY Yuntong 5000mAh 50C LiPo Saddles

22 Set-up

Mid Motor

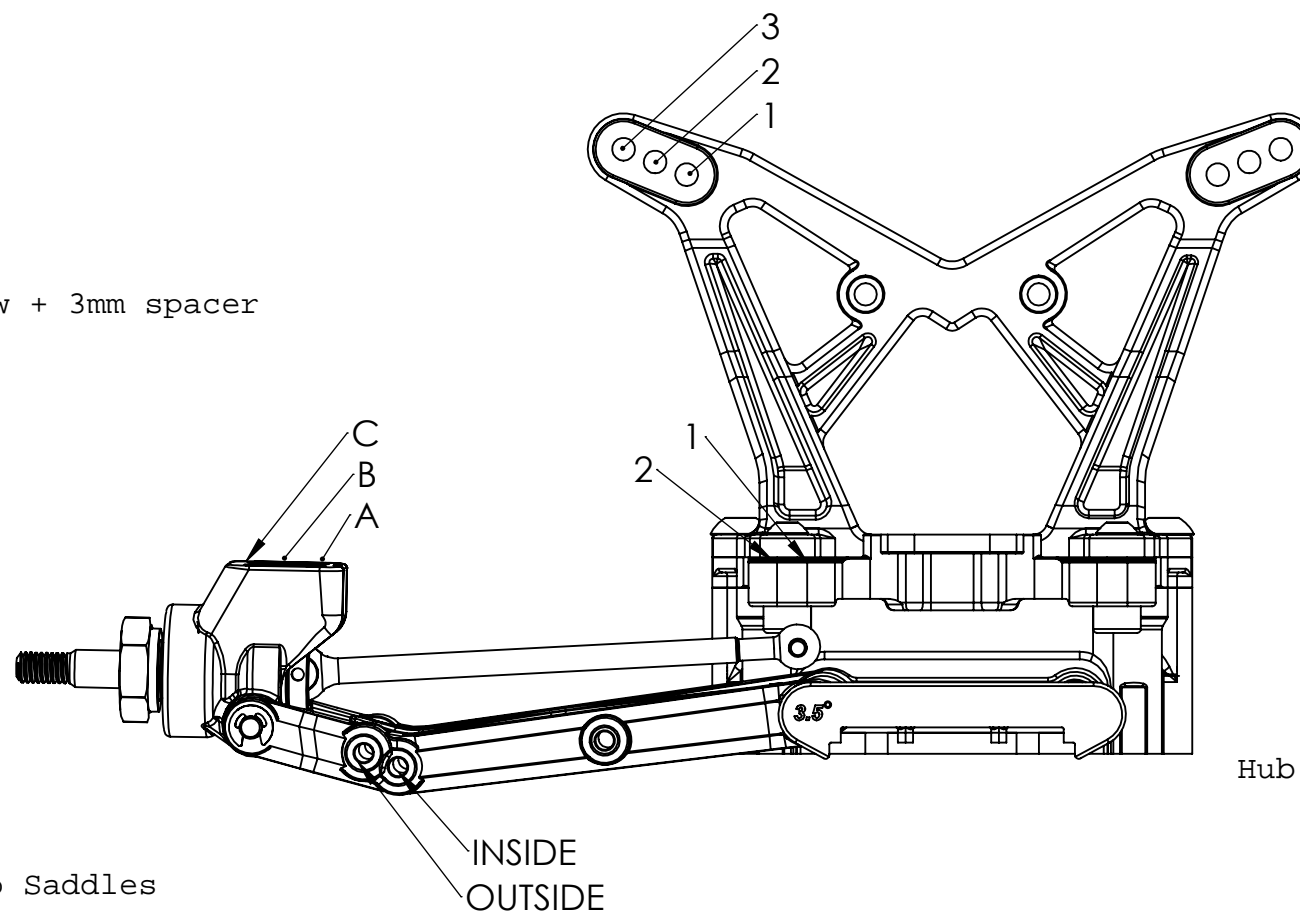
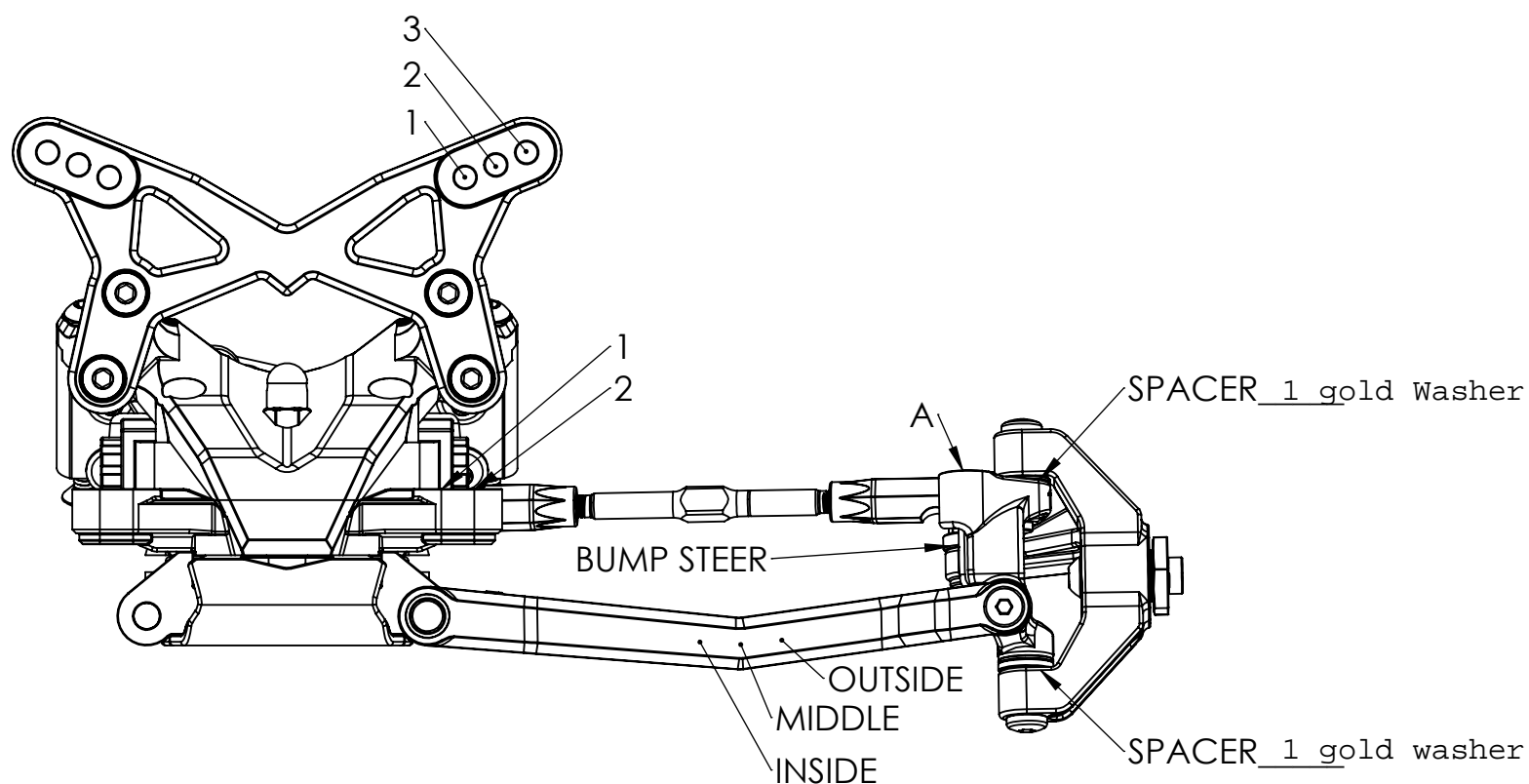

Hub spaced full forward - SWB

DATE 28-September-2010
 LOCATION EPR
 SURFACE Astroturf / Concrete
 TEMPERATURE 13° C
 TIME _____
 DRIVER Andy
 WEATHER Overcast

Track was Damp and Greasy all day.

COMMENTS:

Added 42g weight at back of rear shock tower.
 Used 100g brass weight plate under battery

LAP1	_____	LAP11	_____
LAP2	_____	LAP12	_____
LAP3	_____	LAP13	_____
LAP4	_____	LAP14	_____
LAP5	_____	LAP15	_____
LAP6	_____	LAP16	_____
LAP7	_____	LAP17	_____
LAP8	_____	LAP18	_____
LAP9	_____	LAP19	_____
LAP10	_____	LAP20	_____

TOTAL RUN TIME 100 laps
 TOTAL TIME ON CAR 50-60 mins.

Wing: Losi Aurora Rear wing - 5mm Gurney

Castle MMP ESC on Chassis plate behind Low Profile Servo (SmartSense mode + 20deg motor timing)