



# Setup Sheet

Track: \_\_\_\_\_

Driver: Todd Hodge

- Indoor
- Outdoor

- Smooth
- Rough

- Slippery
- High-Bite
- Blue-Groove

Date: Mar 8, 2000

- Tight /  Open

## FRONT SUSPENSION (Circle or Check the Appropriate Settings)

Toe  In 1 °  
 Out

Ride Height Arms Level

Camber  - 1/2 °  
 +

Caster  Stock          °  
 Other

Sway Bar  No          size  
 Yes

# of washers under steering / tie-rod ball studs  
Spindle ball stud: 1  
Bellcrank ball stud: 1

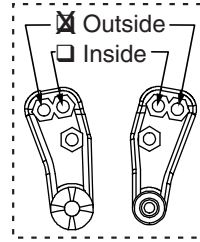

# of washers under ball stud: 2

- 1
- 2
- 3
- 4

### Front Shocks

Oil: 30 wt Losi

Piston: 56  Standard /  Drilled

Spring: Silver

Limiters:  Inside- A spacer  Outside- none

### Spindle Location

- Top
- Middle
- Bottom

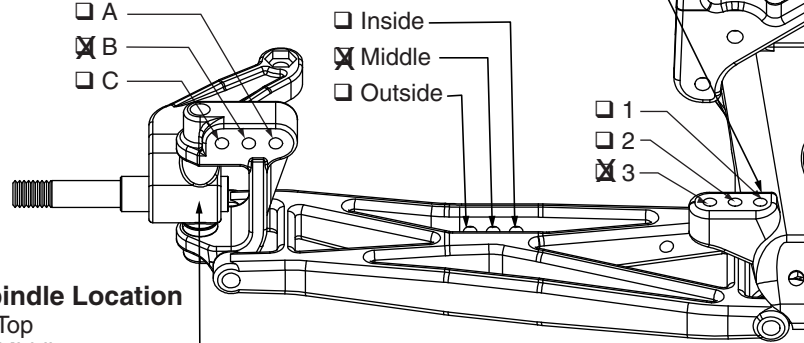

## REAR SUSPENSION

Toe-In  Inside 3 °  
 Outside

Pivot Support 2 deg  No Shim  
 Shim Under Front  
 Shim Under Rear > # of shims: \_\_\_\_\_

Ride Height Bones Level

Camber  - 1/2 °  
 +

Drive Shafts  Dogbones  Aluminum  
 CVDs  Steel

Rear Hub Spacing  Forward  
 Center  
 Rear

Outdrives  Steel  
 Plastic

Sway Bar  No          size  
 Yes

### Rear Shocks

Oil: 30 wt Losi

Piston: 56  Standard /  Drilled

Spring: Red

Limiters:  Inside- none  Outside- none

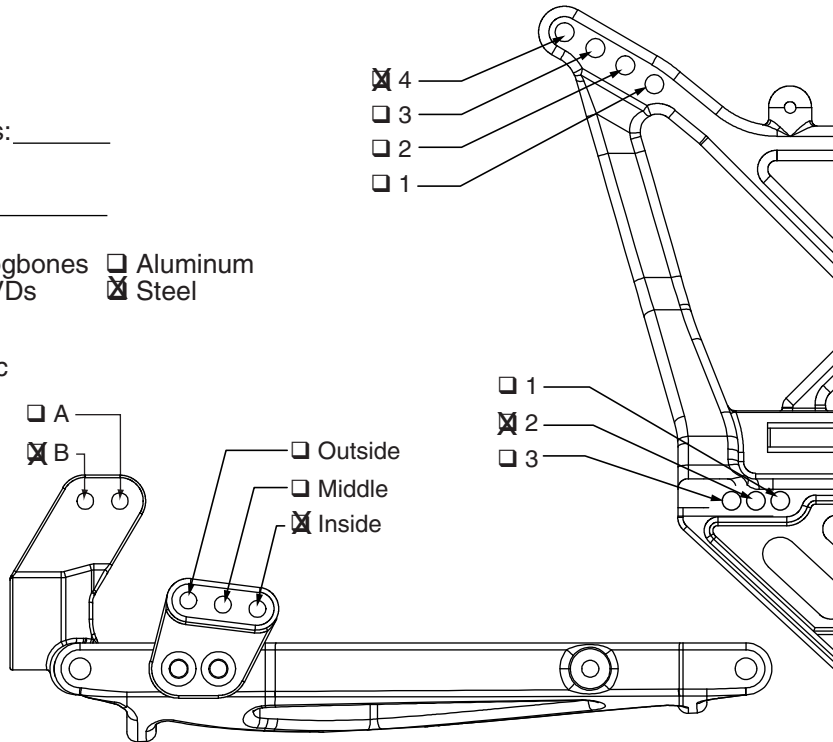

Tires Front: Losi 8 Rib

Compound Red

Foam Losi Firm

Motor: 10x2 D4 Pinion/Spur: 15 86

Tires Rear: Losi Taper Pin

Compound Red

Foam Bomb 2 Firm

Battery Position: Middle

Notes: \_\_\_\_\_