

Name: <u>Dan Coleman</u>		Date: <u>7/18/2007</u>	Event: <u>SRS Scottsdale</u>
City: _____	State: _____	Track: _____	
Track <input type="checkbox"/> Indoor <input type="checkbox"/> Tight <input type="checkbox"/> Smooth <input type="checkbox"/> Hard Packed <input type="checkbox"/> Blue Groove <input checked="" type="checkbox"/> Wet <input type="checkbox"/> Low Bite <input type="checkbox"/> High Bite Conditions <input checked="" type="checkbox"/> Outdoor <input checked="" type="checkbox"/> Open <input checked="" type="checkbox"/> Rough <input checked="" type="checkbox"/> Loose/Loamy <input type="checkbox"/> Dry <input type="checkbox"/> Dusty <input checked="" type="checkbox"/> Med Bite <input type="checkbox"/> Other _____			

Front Suspension

Toe: 0.5° Toe-In
 Ride Height: 23mm
 Camber: -1°
 Caster: 30° (stock)
 Sway Bar: no
 Oil: 27.5
 Piston: 56
 Spring: silver
 Limiters: 0
 Spindle Height: middle
 Axle Spacer: narrow
 Steering Type: _____
 Bump Steer: 0
 Camber Link: 2A/2
 Shock Location: 2-outside
 VLA: short
 Front Wing: none

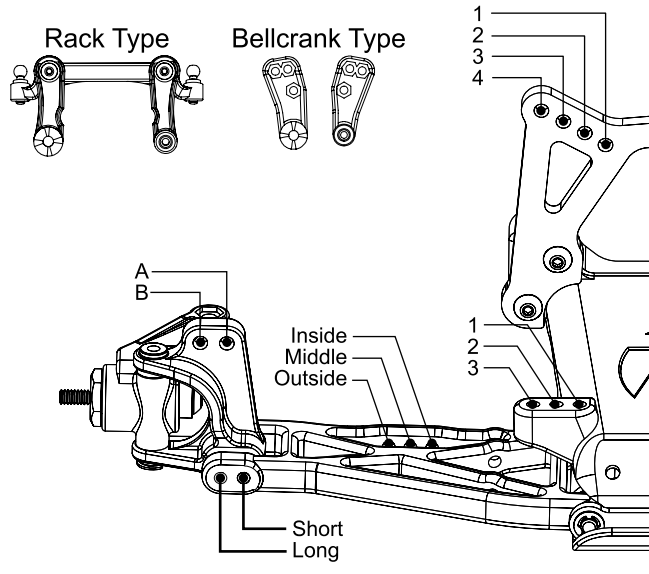

Notes: _____

Rear Suspension

Toe: 3° Block, 0° Hubs
 Pivot Support: 2° Pivot, 0 Shims (2° total)
 Ride Height: 24mm
 Camber: -1°
 Rear Hub Spacing: middle
 Drive Shafts/Outdrives: aluminum CVD's/steel outdrives
 Sway Bar: no
 Oil: 27.5
 Piston: 56
 Spring: white
 Limiters: 0
 Camber Link: 2B/3
 Shock Location: 2-middle
 VLA: short
 Wing Position/Mount: Forward/Bottom
 Body & Wing Type: XXX-CR/XXX-CR (Dual Wing)
 Battery Position: Forward

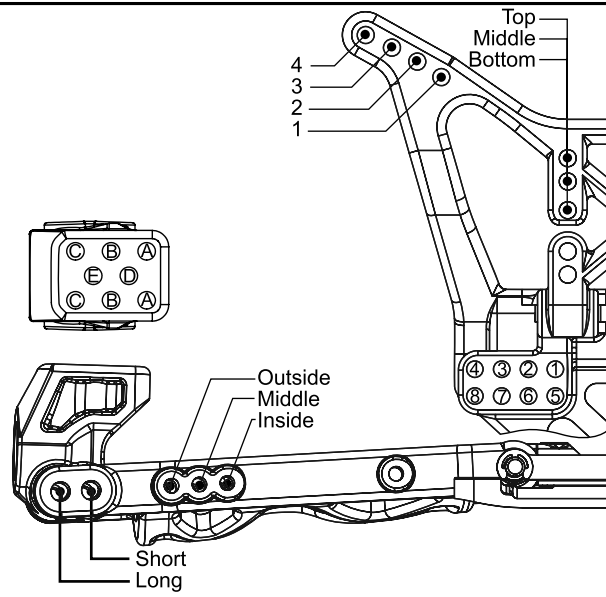

Notes: _____

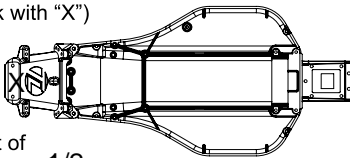
Weight Placement (Mark with "X")  Weight of each piece <u>1/2</u> oz.	Tires: _____	Type: _____	Compound: _____	Insert: _____	Additive: _____	Motor: <u>Checkpoint</u>
	Front: <u>4 Rib wide</u>	<u>M3</u>	_____	_____	_____	Spur: <u>78</u>
	Rear: <u>Holeshot</u>	<u>M3</u>	_____	_____	_____	Pinon: <u>23</u>
Notes: _____						