

Name: <u>Travis Amezcua</u>		Date: <u>7/8/2006</u>	Event: <u>Hot Rod Hobbies Shootout</u>
City: <u>Saugus</u>		State: <u>CA</u>	
Track: <u>Hot Rod Hobbies</u>			
Track	<input type="checkbox"/> Indoor	<input type="checkbox"/> Tight	<input checked="" type="checkbox"/> Smooth
Conditions	<input checked="" type="checkbox"/> Outdoor	<input checked="" type="checkbox"/> Open	<input type="checkbox"/> Rough
	<input checked="" type="checkbox"/> Hard Packed	<input checked="" type="checkbox"/> Blue Groove	<input type="checkbox"/> Wet
	<input type="checkbox"/> Loose/Loamy	<input type="checkbox"/> Dry	<input type="checkbox"/> Low Bite
			<input checked="" type="checkbox"/> High Bite
			<input type="checkbox"/> Dusty
			<input type="checkbox"/> Med Bite
			<input type="checkbox"/> Other _____

Front Suspension

Toe: 0.5° Toe-Out

Ride Height: 23mm

Camber: -1°

Caster: 30° (stock)

Sway Bar: no

Oil: 30

Piston: 57

Spring: blue

Limiters: .060

Spindle Height: top

Axle Spacer: narrow

Steering Type: _____

Bump Steer: .090

Camber Link: 1A/0

Shock Location: 3-middle

VLA: long

Front Wing: none

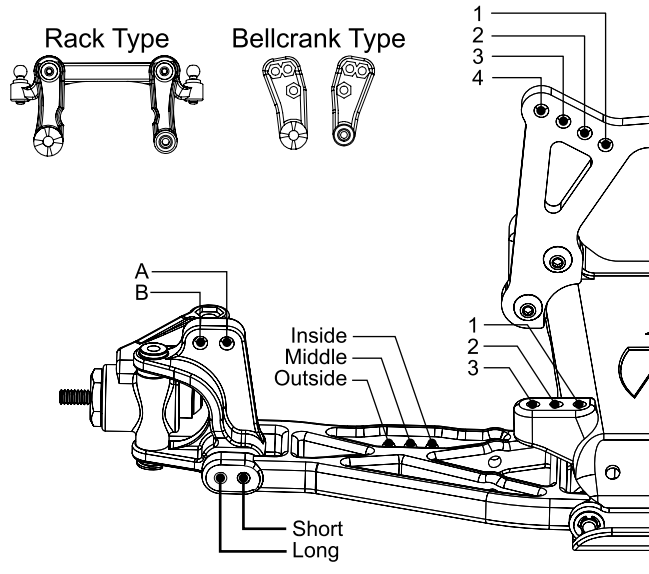

Notes: 27° kickup (.050 under front 2 screws = .050).
Short neck ball stud for inner front camber link.

Rear Suspension

Toe: 3° Block, 0° Hubs

Pivot Support: 2° Pivot, 1 Shims (3° total)

Ride Height: 23mm

Camber: -2°

Rear Hub Spacing: back°

Drive Shafts/Outdrives: steel bones/steel outdrives

Sway Bar: no

Oil: 20

Piston: 2-hole 54

Spring: white

Limiters: 0

Camber Link: 3B/3

Shock Location: 2-outside

VLA: short

Wing Position/Mount: Forward/Bottom

Body & Wing Type: XXX-CR/XXX-CR (Dual Wing)

Battery Position: Forward

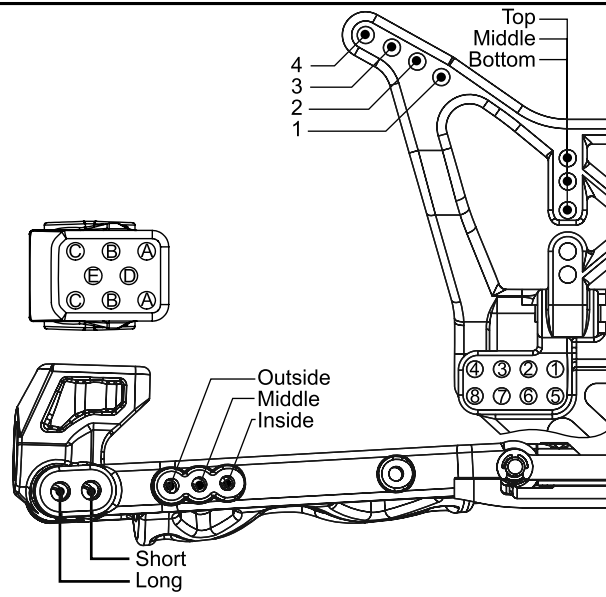

Notes: 1 strip for wicker on rear wing. Shock ends
unscrewed one turn.

Weight Placement
(Mark with "X")

Tires: Type _____ Compound _____ Insert _____ Additive _____ Motor: _____

Front: Taper Pin Red Stock _____ Spur: 78

Rear: X-2000 Red Stock _____ Pinon: 22

Notes: _____

Weight of each piece 1/2 oz.