

TENLOS SETUP SHEET XXX CR

Name: Brandon Rohde

Date: 11/2/2006

Event: WI Off-Road Champs

City: Brookfield

State: WI

Track: Trackside Hobbies

Track Indoor Tight Smooth Hard Packed Blue Groove Wet Low Bite High Bite
 Conditions Outdoor Open Rough Loose/Loamy Dry Dusty Med Bite Other Super Incredible High Bite

Front Suspension

Toe: 0° Toe
 Ride Height: 23mm
 Camber: -1°
 Caster: 30° (stock)
 Sway Bar: no
 Oil: 25
 Piston: 57
 Spring: orange
 Limiters: 0
 Spindle Height: bottom
 Axle Spacer: narrow
 Steering Type: _____
 Bump Steer: .030
 Camber Link: 2A/2
 Shock Location: 2-middle
 VLA: short
 Front Wing: none

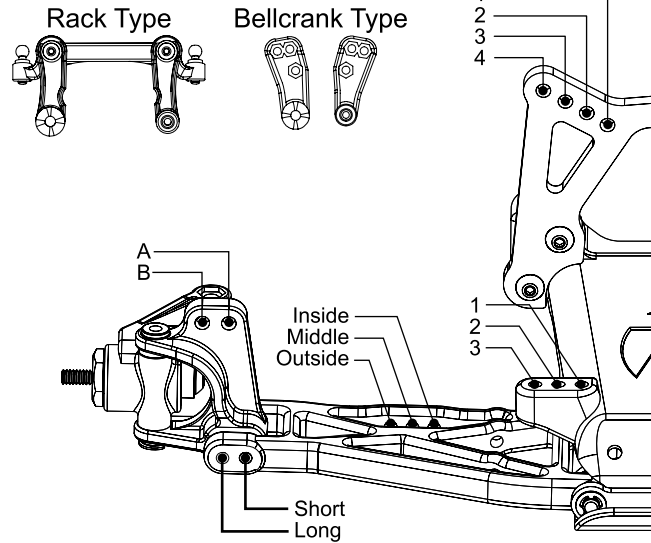

Notes: Should have switched to 27.5wt and silver springs

Rear Suspension

Toe: 3° Block, 0° Hubs
 Pivot Support: 2° Pivot, 1 Shims (3° total)
 Ride Height: 24mm
 Camber: -1°
 Rear Hub Spacing: 3/4 back (.090 front, .030 back)
 Drive Shafts/Outdrives: steel bones/steel outdrives
 Sway Bar: .050
 Oil: 17.5
 Piston: 57
 Spring: white
 Limiters: .090
 Camber Link: 2B/5
 Shock Location: 2-middle
 VLA: short
 Wing Position/Mount: Forward/Bottom
 Body & Wing Type: XXX-CR/XXX-CR (Dual Wing)
 Battery Position: Forward

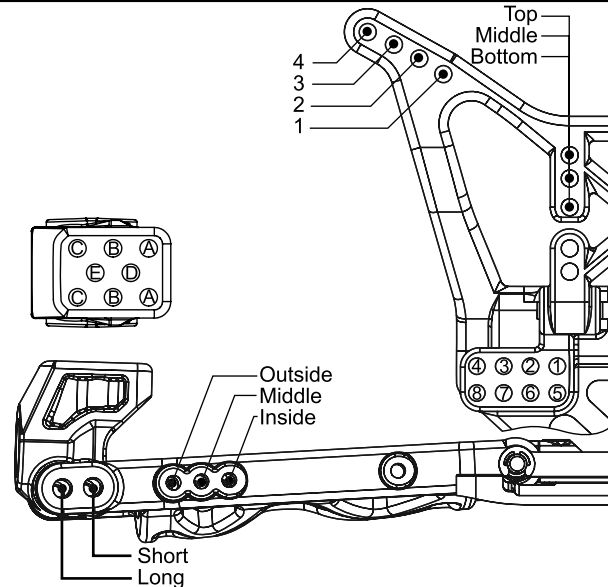

Notes: Inside rear wheel lifted in turns, needed more support in front as mentioned above

Weight Placement
(Mark with "X")

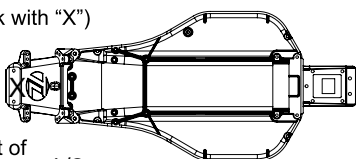

Weight of each piece 1/2 oz.

Tires:	Type	Compound	Insert	Additive	Motor:
Front:	<u>7202</u>	<u>Pink</u>	<u>3/4 Gray</u>	<u>Zip Free</u>	<u>12x1</u>
Rear:	<u>Taper Pin</u>	<u>Pink</u>	<u>Gray</u>	<u>Zip Free</u>	<u>Spur: 78</u>
					<u>Pinon: 22</u>

Notes: The car was really good, but it would have been off the hook good if the front was a little stiffer