



Setup Sheet

Driver: Richard Cree

Date: 1/21/04

Track: General Grass Setup

- | | | |
|---|--|--------------------------------------|
| <input type="checkbox"/> Indoor | <input checked="" type="checkbox"/> Smooth | <input type="checkbox"/> Slippery |
| <input checked="" type="checkbox"/> Outdoor | <input type="checkbox"/> Rough | <input type="checkbox"/> High-Bite |
| <input type="checkbox"/> Tight / | <input checked="" type="checkbox"/> Open | <input type="checkbox"/> Blue-Groove |

FRONT SUSPENSION (Circle or Check the Appropriate Settings)

Toe In 0°
 Out 0°

Ride Height Arms Level

Camber - 1/2°
 +

Caster Stock 30°
 Other

Sway Bar No
 Yes size: _____

of washers under steering / tie-rod ball studs
Spindle ball stud: 0
Bellcrank ball stud: 0

Spindle Location

- A
 Top
 Middle
 Bottom

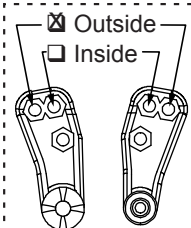

of washers under ball stud:
1

Axle Spacer

- Narrow - inside
 Wide - outside

- Inside
 Middle
 Outside

- Long
 Short

- Long
 Short

Front Shocks

Oil: 32.5 Losi

Piston: 56 Standard / Drilled

Spring: Green Internal: Yes / No

Limiters: Inside-1.5mm(.060") Outside-0

REAR SUSPENSION

Toe-In Inside 3°
 Outside _____

Pivot Support No Shim
 Shim Under Front — # of shims: _____

Ride Height Chassis level with front

Camber - 1°
 +

Rear Hub Spacing Forward
 Center
 Rear

Sway Bar No
 Yes size: _____

Body: BK2

Wing: BK2 wing with 4mm gurney flap

Front Wing: Yes / No

Wing Position

- Forward
 Back

Wing Mount

- Top
 Bottom

- 4
 3
 2
 1

Drive Shafts Dogbones Aluminum
 CVDs Steel

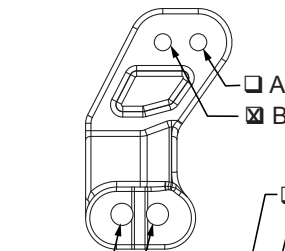

- 1
 2
 3

Rear Shocks

Oil: 32.5 Losi

Piston: 56 Standard / Drilled

Spring: Red Internal: Yes / No

Limiters: Inside-3mm(.120") Outside- _____

Tires

Front: Schumacher Slim Yellow Mini Spikes

Rear: Schumacher Yellow Mini Spikes

Compound

Foam

Losif 4wd firm

Losi Firm

Motor: 10x3 Peak Pinion/Spur: 23 / 78

Battery Position: Forward

Weather Conditions/Notes: Inside and outside row cut off on front tires. 15 grams of lead in front bulkhead.

If car is too twitchy use long rear arm