



SETUP SHEET

Track: Starting setup any track

Driver: Ellis Stafford

Date: 2004

- Indoor
- Outdoor
- Tight / Open

- Slick
- Loose Dirt
- Blue-Groove

- Smooth
- Rough
- Extra-Rough

FRONT SUSPENSION

(Circle or Check the Appropriate Settings)

In
Toe Out 1

Pivot Support: 5F(5°), 7.5F(7.5°), 10F(10°)

- Standard 42F 42R
- Overdrive 41F 42R
- Underdrive 42F 41R

Ride Height Chassis level when rear set

Front Drive: Diff One-Way
Ackerman: Forward Back

Drive Shafts

- Dogbone
- Aluminum Steel
- CVD

Camber X - 1
+ 1

Diff X Plastic Steel

of washers 1

Caster X Stock Other

Sway Bar No Yes size

of washers under steering/tie-rod ball studs

Spindle ball stud: 2

Bellcrank ball stud: 0

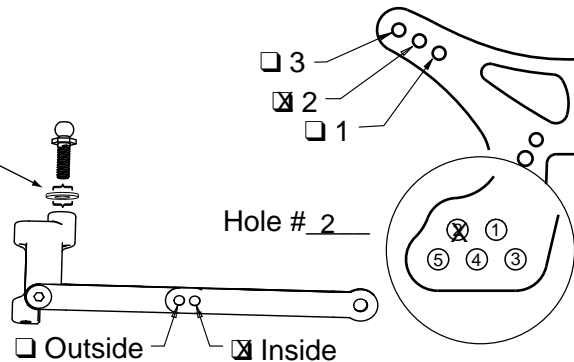

Front Shocks
Oil: 60 wt
Piston: Orange Standard / Drilled
Spring: Black
Internal Spring: No
Limiters: X Inside- B Outside- 0

Notes:

REAR SUSPENSION

Pivot Support: -IR(-1°), IR(1°), 3R(3°)

Toe-In X Inside Std
Outside

Ride Height Arms just below level

Camber -
+

Diff Plastic Steel Drive Shafts Dogbone CVD Sliders Aluminum Steel Plastic

Sway Bar No Yes size

Rear Shocks
Oil: 35 wt
Piston: Blue Standard / Drilled
Spring: Red
Limiters: Inside 3mm Outside-

Hub Spacing X Forward X Middle X Back

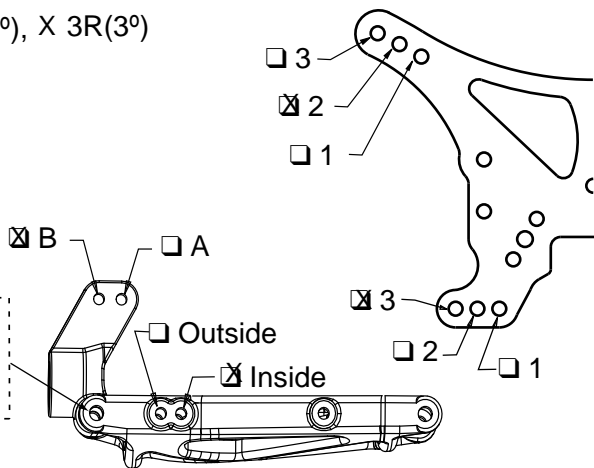

Notes:

BK2 arms and hubs on long pivot

Tires: Compound Foam
Front:
Rear:
Wing Setup: Std

Motor: 9 x 2
Pinion: 18
Spur: 92

Battery Placement: Back Forward Other:

Transponder Position: Wing

Notes: