



# SETUP SHEET

Track: Eden Park Raceway (damp)

Driver: Andy

Date: 7-Nov-2010

Indoor  
 Outdoor  
 Wet /  Dry

Old [ V' !~  
 Concrete  
 Grass

Smooth  
 Rough  
 Extra-Rough

## FRONT SUSPENSION

(Circle or Check the Appropriate Settings)

In  
 Toe  Out 0.5°

Rear driveshafts level

Ride Height chassis level

Camber  - -1 deg°  
 +

Caster  Stock  
 Other 3 deg°

No  
 Sway Bar  Yes size \_\_\_\_\_

Pivot Support:  5F(5°),  7.5F(7.5°),  10F(10°)

Front Drive:

Diff  
 One-Way

Diff  Plastic  
 Steel

Ackerman:

Forward  
 Back

Drive Shafts

Standard 42F 42R  
 Overdrive 41F 42R  
 Underdrive 42F 41R

Dogbone  Aluminum  
 CVD  Steel

# of washers

0

# of washers under steering/tie-rod ball studs

Spindle ball stud: 0

Bellcrank ball stud: 0

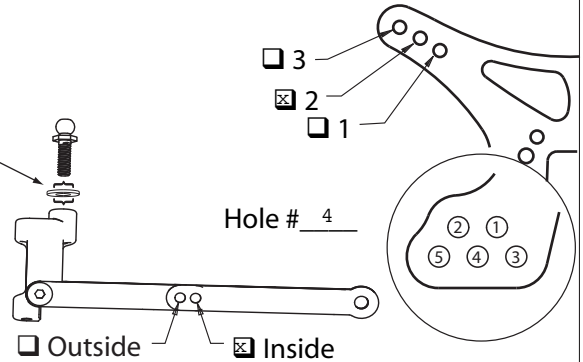

## Front Shocks

Oil: 40 wt Losi

Piston: 56 Red  Standard /  Drilled

Spring: Green

Internal Spring: None

Limiters:  Inside- 1 B Spacer  Outside- None

## Notes:

XXXX Hinge Pin blocks fitted.

## REAR SUSPENSION

Pivot Support:  -IR(-1°),  IR(1°),  3R(3°)

Toe-In  Inside 2 deg°  
 Outside

Rear driveshafts level

Ride Height chassis level

Camber  - -1 deg°  
 +

Diff  Plastic  Steel  
 Drive Shafts  Dogbone  Aluminum  
 CVD  Steel  
 Sliders  Plastic

No

Sway Bar  Yes size Kit Std

Hub Spacing

Forward  
 Middle  
 Back

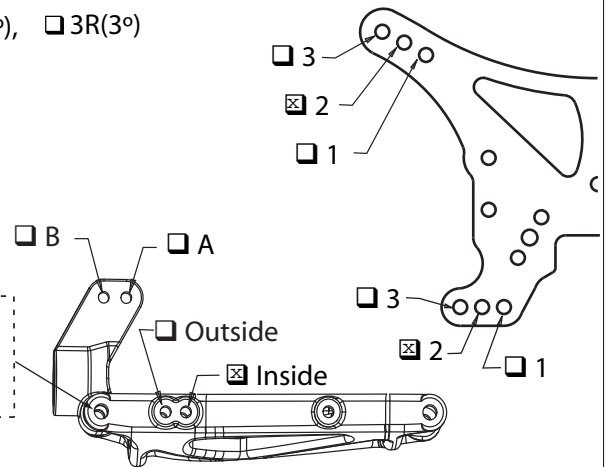

## Rear Shocks

Oil: 30 wt Losi

Piston: 55 Orange  Standard /  Drilled

Spring: Pink

Limiters:  Inside None  Outside-

## Notes:

LOSA3031 Gen2 (BK2) axles fitted to increase rear droop

Rear wishbones are VLA arms - set to VLA Long

Rear Hubs are XXX-CR - Hole Position C

Tires:

Compound

Foam

Front: Schumacher Minispikes Green Mr O Blue

Rear: Schumacher Minispikes Green Mr O Blue

Wing Setup: Aurora - 10mm Gurney

Motor: Xcelorin 5.5T

Pinion: 18

Spur: 92

Battery Placement:  Back  Forward  Other: \_\_\_\_\_

Transponder Position: \_\_\_\_\_

Notes: Castle Mamba Max Pro - Smartsense + 20 deg motor Timing

Spektrum S6040 Servo