



Offert par www.petitrc.fr.st

Setup Sheet

Track: St Denis de l'hôtel - 100% Grass

Driver: Thibault DUBUS

Date: 17 / 09 / 2000

- Indoor Smooth Slippery
- Outdoor Rough High-Bite
- Tight / Open Blue-Groove

FRONT SUSPENSION

(Circle or Check the Appropriate Settings)

Toe In Out 0 °

Ride Height Drive shaft level

Camber - + 1 °

Caster Stock Other °

Sway Bar No Yes size

of washers under steering / tie-rod ball studs
 Spindle ball stud: /
 Bellcrank ball stud: /

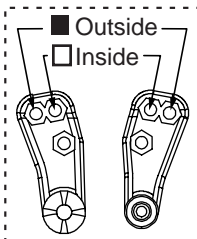

of washers under ball stud:
 1
 2
 3

Front Shocks

Oil: 30

Piston: 5 5 6 Standard / Drilled

Spring: Green

Limiters: Inside- 2mm Outside- /

Spindle Height

- Top
- Middle
- Bottom

Axle Spacer

- Narrow - inside
- Wide - outside

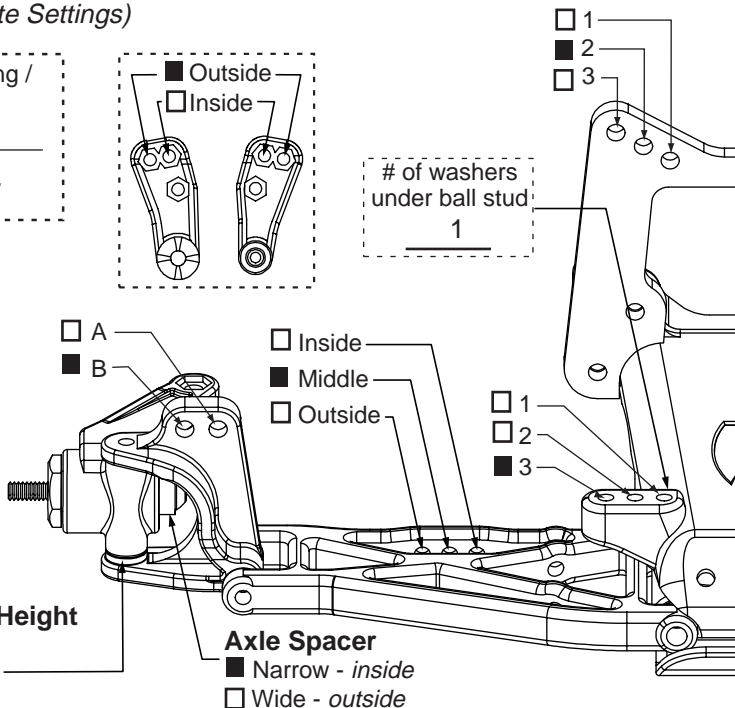

REAR SUSPENSION

Toe-In Inside 3 ° Outside °

Pivot Support 4° No Shim Shim Under Front Shim Under Rear } # of shims: 2

Ride Height Dogs levels

Camber - + 1 °

Drive Shafts Dogbones Aluminum CVDs Steel

Rear Hub Spacing Forward Center Rear Outdrives Steel Plastic

Sway Bar No Yes size

Rear Shocks

Oil: 27,5

Piston: 5 5 6 Standard / Drilled

Spring: Yellow

Limiters: Inside- Outside-

Wing Position

- Forward
- Back

Wing Mount

- Top
- Bottom

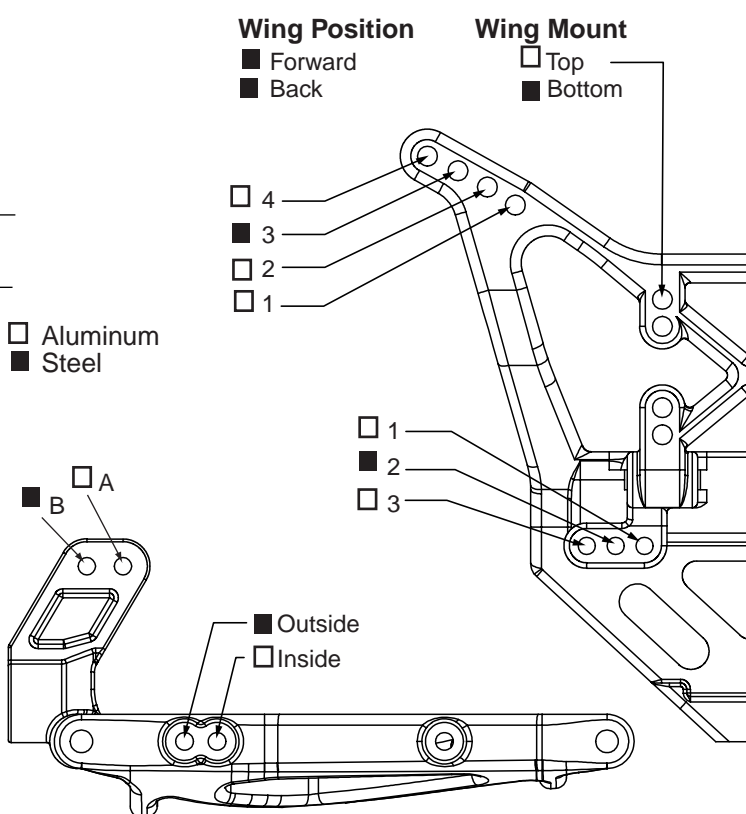

Tires
 Front: Schum Slim Compound Yellow Foam No
 Rear: Schum Ballon Compound Yellow Foam Soft

Motor: 10 x 4 D4 Pinion/Spur: 20 / 82

Battery Position: FORWARD

Notes: 10 Grs in the bulkhead - 2nd in the A main - Team PETIT R/C