

Name: Aaron Kothman		Date: 1/8/17	Event: 30th CRCRC Midwest
City: Jeffersonville		State: Ohio	
Track: Ohio R/C Factory			

Track Conditions	<input checked="" type="checkbox"/> Indoor	<input type="checkbox"/> Tight	<input checked="" type="checkbox"/> Smooth	<input checked="" type="checkbox"/> Hard Packed	<input type="checkbox"/> Blue Groove	<input type="checkbox"/> Wet	<input type="checkbox"/> Grass	<input type="checkbox"/> Low Bite	<input checked="" type="checkbox"/> High Bite
	<input type="checkbox"/> Outdoor	<input checked="" type="checkbox"/> Open	<input type="checkbox"/> Rough	<input type="checkbox"/> Loose/Loamy	<input checked="" type="checkbox"/> Dry	<input type="checkbox"/> Dusty	<input type="checkbox"/> Astro Turf	<input checked="" type="checkbox"/> Med Bite	<input type="checkbox"/> Other _____

Front Suspension

Ride Height: **24mm**

Camber: **-1 deg**

Toe: **+1 deg**

Forward Front Pill: ☐ 1↓ ☐ .5↓ ☒ 0 ☐ .5↑ ☐ 1↑

Rearward Front Pill: ☐ 1↓ ☐ .5↓ ☒ 0 ☐ .5↑ ☐ 1↑

Steering Ackerman: ☐ Long ☒ Short

Bump Steer: **Outer down/Inner down**

Camber Link: **1**

Sway Bar: **2.3mm**

Shock Type: ☐ Bladder ☒ Emulsion Oil: **TLR 40**

Piston: **5 x 1.0**

Spring: **Brown (TLR233020)**

Shock Limiters: **None** Stroke: _____

Overall Shock Length: **89mm**

Shock Location: **3-middle**

Front Diff Fluid: **7000**

Center Diff Fluid: **10000**

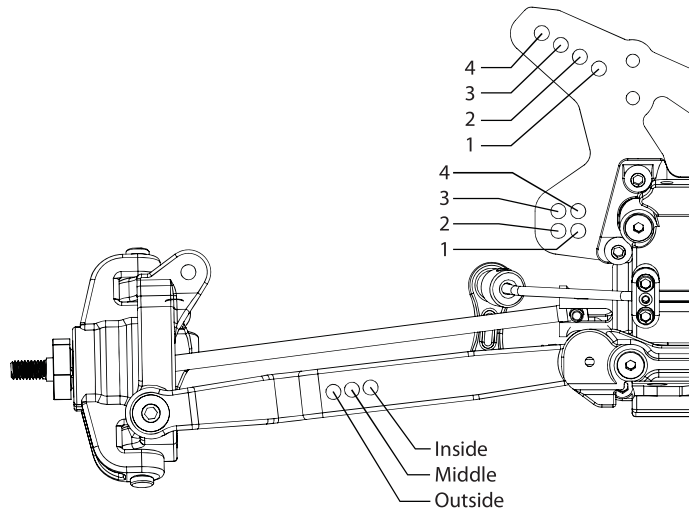

Notes: _____

Aluminum front top brace TLR331008

Rear Suspension

Ride Height: **24mm**

Camber: **-1.5 deg**

Forward Rear Pill: ☐ 1↓ ☐ .5↓ ☒ 0 ☐ .5↑ ☐ 1↑

Rearward Rear Pill: ☐ 1 In ☐ .5 In ☒ 0 ☐ .5 Out ☐ 1 Out

Camber Link: **5-B**

Rear Hub Spacing: **3 front 1 rear**

Sway Bar: **2.2mm**

Shock Type: ☐ Bladder ☒ Emulsion Oil: **TLR 37.5**

Piston: **5 x 1.1**

Spring: **Silver (TLR5171)**

Shock Limiters: **None** Stroke: _____

Overall Shock Length: **95mm**

Shock Location: **2-middle**

Rear Diff Fluid: **5000**

Battery Position: **ESC front - battery rear/middle**

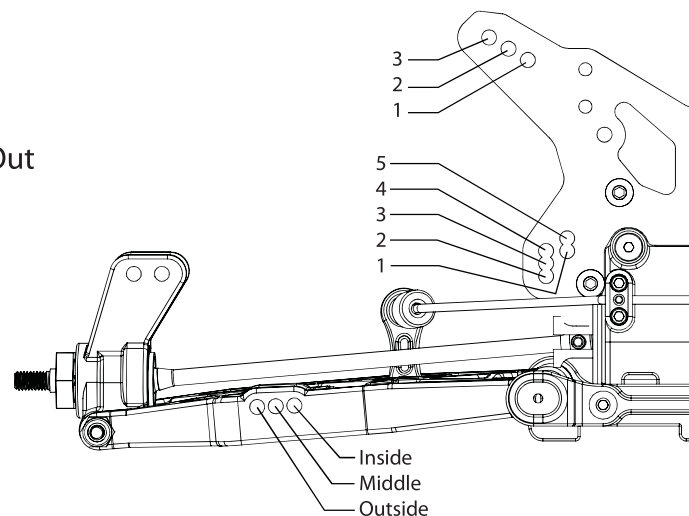

Notes: _____

Electronics

Radio: DX4R	Timing Advance: _____
Servo: S6240	Throttle/Brake Expo: _____
ESC: R10 Pro	Servo Expo: _____
Initial Brake: Drag	Throttle/Brake EPA: 100/75
Drag Brake: 10%	Motor: Orion VST2 550 4.0
Throttle Profile: 9	Pinion: 11 Spur: 40
	Battery: Orion 8000mah

Weight Placement
(Mark with "X")

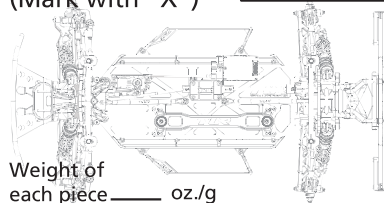

Weight of each piece _____ oz./g

Tires Front:	Compound PL Electron	Insert MC	Additive Stock
Rear:	Compound PL Electron	Insert MC	Additive Stock
Notes:	TQ and Win		