



# Setup Sheet

Driver: Lionel Trebern

Date: 22&23 novembre 2003

Track: Coupe des Champions St Vaast

Indoor  
 Outdoor

Slick  
 Loose-Dirt

Smooth  
 Rough

Tight /  Open

Blue-Groove

Extra-Rough

## Front Suspension (Circle or Check the Appropriate Settings)

In  
Toe  Out 0 °

Ride Height \_\_\_\_\_

Camber  - 2 °  
 +

Caster  Stock  
 Other \_\_\_\_\_ °

Sway Bar  No  
 Yes size \_\_\_\_\_

### Steering Bellcranks

Inner  Outer

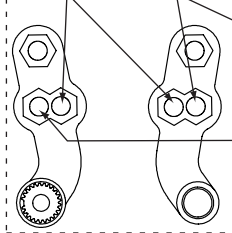

### Rod Length

Stock  
 Other \_\_\_\_\_

# of washers \_\_\_\_\_

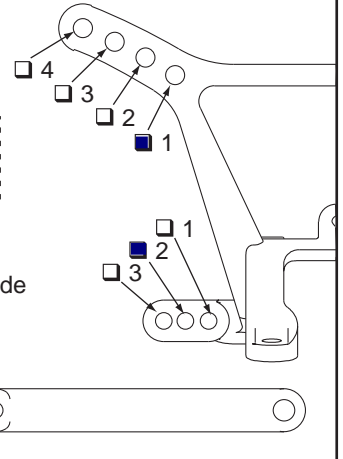
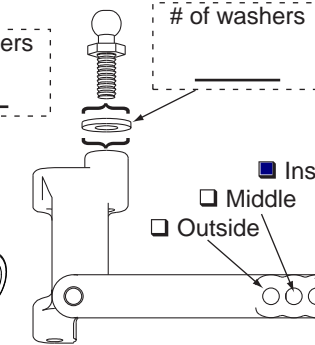
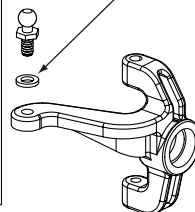

### Front Shocks

Oil: 40

Piston: 54  Standard /  Drilled

Spring: Bleu

Limiters:  Inside- A  Outside- \_\_\_\_\_

## Rear Suspension

Toe-In  Inside  
 Outside 2,5 °

Ride Height \_\_\_\_\_

Camber  - 2 °  
 +

Pivot Support 2  No Shim  
 Shim Under Front  Shim Under Rear

Sway Bar  No  
 Yes size \_\_\_\_\_

### Notes:

---

---

---

### Rear Shocks

Oil: 40

Piston: 54  Standard /  Drilled

Spring: Rouge

Limiters:  Inside- B  Outside- A+B

Hole in Rear Hub  
5

Hole in Bulkhead  
7

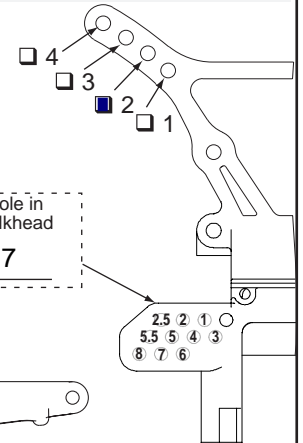
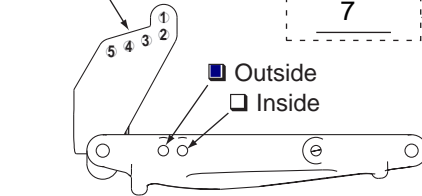

## Tires

Front: Schum Mini Pin 4x2

## Compound

Jaune

## Foam

Schum Bleu

Rear: Schum Mini Pin

Jaune

Schum Bleu

Motor: 12x2

Pinion: 19

Spur: 84

Clicker Adjustment:  Locked  One-Way: \_\_\_\_\_

Battery Placement:  Back  Forward  Other: \_\_\_\_\_

Notes: Paris est magique !!!!!