

Name: <u>Standard Kit Setup</u>		Date: <u>4-20-15</u>	Event: _____
City: _____ State: _____		Track: _____	
Track Conditions <input type="checkbox"/> Indoor <input type="checkbox"/> Tight <input type="checkbox"/> Smooth <input type="checkbox"/> Hard Packed <input type="checkbox"/> Blue Groove <input type="checkbox"/> Wet <input type="checkbox"/> Low Bite <input type="checkbox"/> High Bite		<input type="checkbox"/> Outdoor <input type="checkbox"/> Open <input type="checkbox"/> Rough <input type="checkbox"/> Loose/Loamy <input type="checkbox"/> Dry <input type="checkbox"/> Dusty <input type="checkbox"/> Med Bite <input type="checkbox"/> Other _____	

**Front Suspension**

Toe: 2° Toe Out

Ride Height: 39mm

Camber: -1°

Caster: 15°

Wheel Hex: Standard Hex

Sway Bar: 2.3mm

Piston/Oil: 8 Hole Split 1.2/1.3mm/37

Spring: White 5.8 lbs.

Limiter/Droop: 116mm

Steering Ackerman: Long

Bump Steer: Up

Camber Link: 2

Shock Location: 2/Inside

Receiver Battery Type: \_\_\_\_\_

**Differentials**

Front:  Standard  Smart

Spring Wire Dia: \_\_\_\_\_

Qty of Springs: \_\_\_\_\_

Ramp Plate: \_\_\_\_\_

Grease: \_\_\_\_\_

Diff Fluid: 10,000 wt

Center:  Standard  Smart

Spring Wire Dia: \_\_\_\_\_

Qty of Springs: \_\_\_\_\_

Ramp Plate: \_\_\_\_\_

Grease: \_\_\_\_\_

Diff Fluid: 10,000 wt

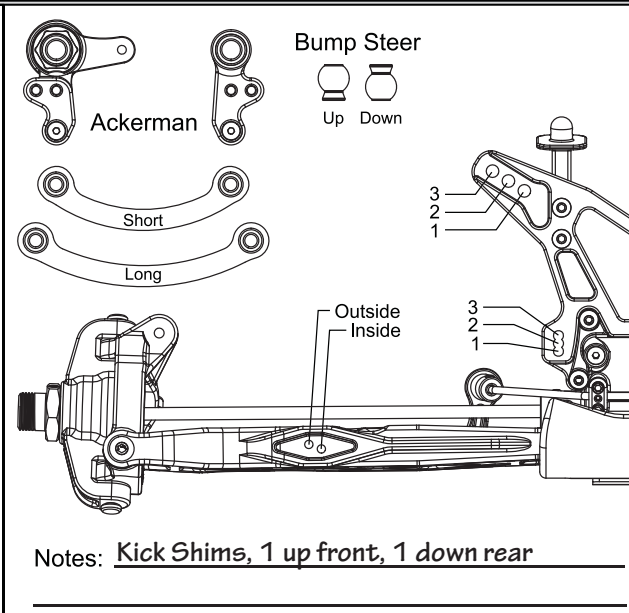

**Rear Suspension**

Roll Center:  HRC  LRC  HRC Fwd/LRC Rear

Toe: 3°

Anti-Squat: 4°

Ride Height: 42mm

Camber: -2°

Rear Hub Spacing: Back

Wheel Hex: Standard Hex

Sway Bar: 2.3mm

Piston/Oil: 8 Hole /1.3mm/37.5 wt

Spring: Grey 5.8 lbs

Limiter/Droop: 128mm

Camber Link: 2/B

Shock Location: 2/Middle

Rear Diff Fluid: 7000 wt

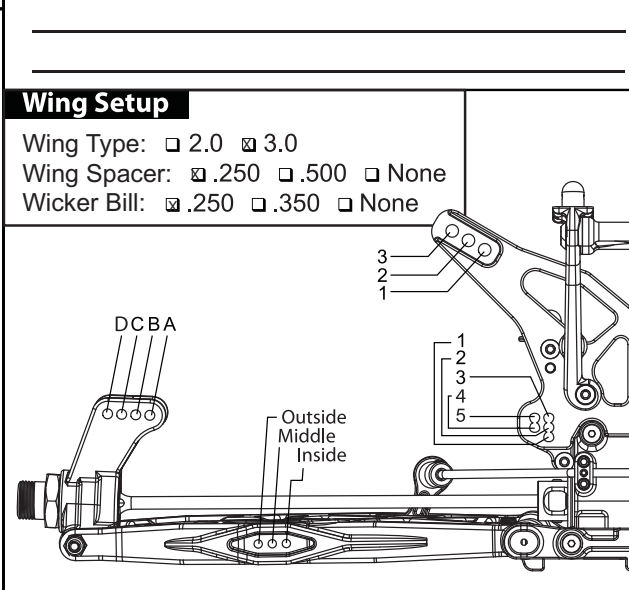

**Electronics**

Radio: DX4R Timing Advance: 0

Servo: S6280 Throttle/Brake Expo: 25%

Pinion: 14 Servo Expo: 25%

Spur: 45 Throttle/Brake EPA: 100/70

Initial Brake: \_\_\_\_\_ Motor: Orion VST2-2100KV

Drag Brake: 5% Battery: 4S 6000mAh

ESC: Orion Vortex R8XPro

Throttle Profile: Fwd/Brk-O

**Tires**

	Type	Compound	Insert
Front:	_____	_____	_____
Rear:	_____	_____	_____
Notes:	_____		