

NAME: \_\_\_\_\_

DATE: \_\_\_\_\_

EVENT: \_\_\_\_\_



CITY: \_\_\_\_\_ STATE: \_\_\_\_\_

TRACK: \_\_\_\_\_

TRACK CONDITIONS Dirt Carpet Tight Smooth Hard Packed Dry Traction: Low Medium High  
Clay Astrotruf Open Rough Loamy Wet Notes: \_\_\_\_\_

**FRONT SUSPENSION**

Toe: \_\_\_\_\_ Camber: \_\_\_\_\_  
 Ride Height: \_\_\_\_\_ Caster Block: 0° 5°  
 Kick Shim(s): 1mm 2mm Wedge (20°)  \_\_\_\_\_  
 VLA Setting: Short Arm Long Arm  
 Front Pivot: Alum Composite Brass  \_\_\_\_\_  
 Pivot Height: SLRC LRC MRC HRC  
 Piston: \_\_\_\_\_ Oil: \_\_\_\_\_  
 Spring: \_\_\_\_\_ Sway Bar: \_\_\_\_\_  
 Limiters - Internal: \_\_\_\_\_ External: \_\_\_\_\_ Stroke: \_\_\_\_\_  
 Shock Eyelet: Std +2 Shock Location: \_\_\_\_\_  
 Spindle Steering Arm: 4 5 6  \_\_\_\_\_  
 Spindle Ball Stud: Std Low Spacers \_\_\_\_\_  
 Draglink Ball Stud: Std Low Spacers \_\_\_\_\_  
 Axle Spacing: 0 +0.5mm +1mm  
 Trail: 2mm 3mm 4mm  
 Camberlink - Inner: 1 2 3 Outer: A B  
 Tower: Stiffezel Carbon Carbon+2mm  \_\_\_\_\_  
 Mud Guard: Soft Std Stiffezel  
 Front Wheel: Std Stiffezel  
 Front Wing: Low High Narrow High Wide

**Stiffezel Parts**

Front Arm Rear Arm  
Chassis Brace / Waterfall  
 \_\_\_\_\_

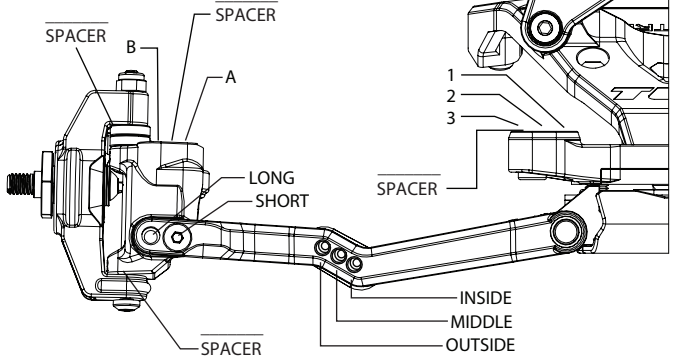

NOTES

**REAR SUSPENSION**

Configuration: Laydown Standup  
 Diff. Height: 0 +1 +1.75 +2.5 +3.5  
 Axle Height: 0 +3  \_\_\_\_\_  
 Toe Plate: LRC LRC -2° HRC HRC -2°  
 Toe Inserts: 2.5 3.0 3.5 4.0 Arrow In Out  
 Anti-Squat Inserts: 0 0.5 1 1.5 2 2.5 3  
 Ride Height: \_\_\_\_\_ Camber: \_\_\_\_\_  
 Hub Spacing: \_\_\_\_\_ Fr \_\_\_\_\_ Rr Hex Width: \_\_\_\_\_  
 Piston: \_\_\_\_\_ Oil: \_\_\_\_\_  
 Spring: \_\_\_\_\_ Sway Bar: \_\_\_\_\_  
 Limiters - Internal: \_\_\_\_\_ External: \_\_\_\_\_ Stroke: \_\_\_\_\_  
 Shock Eyelet: Std +2 Shock Location: \_\_\_\_\_  
 Shock Mounting: Front Rear  
 Tower: Stiffezel Carbon Carbon+2mm  \_\_\_\_\_  
 Camber Block Spacer: 1mm ↓ 0mm 1mm ↑  
 Camberlink - Inner: 1 2 3  
 Camberlink - Outer: A B C D E  
 Battery Position: 1 2 3 4 5  \_\_\_\_\_  
 Wing/Wickerbill: \_\_\_\_\_  
 Wing Angle: 0° 2° 4°  
 Diff. Type: Ball Gear Setting: \_\_\_\_\_  
 Driveshaft CVA Universal Length: \_\_\_\_\_  
Direct Drive Slipper Pads: Torque (Yel) Drive (Org)

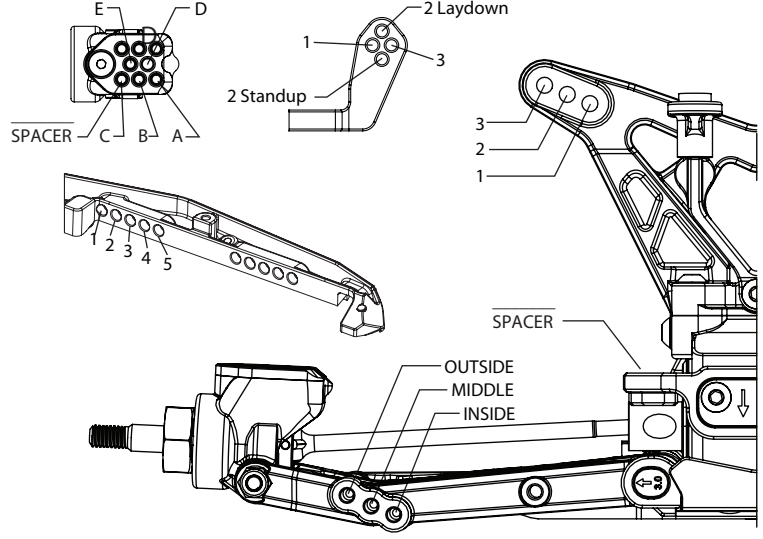

**ELECTRONICS**

Timing Advance: \_\_\_\_\_  
 Radio: \_\_\_\_\_ Steering Expo: \_\_\_\_\_  
 Servo: \_\_\_\_\_ Th/Brake EPA: \_\_\_\_\_  
 ESC: \_\_\_\_\_ Motor: \_\_\_\_\_  
 Initial Brake: \_\_\_\_\_ Pinion/Spur: \_\_\_\_\_  
 Drag Brake: \_\_\_\_\_ Battery: \_\_\_\_\_  
 Th Profile: \_\_\_\_\_ Battery Weight: \_\_\_\_\_

**TIRES** Front Rear

Thread: \_\_\_\_\_  
 Compound: \_\_\_\_\_  
 Insert: \_\_\_\_\_  
 Sauce: \_\_\_\_\_  
 Tread Level: Pin Ghost Pin Slicks

**CHASSIS**

**Electronics Plate**  
Brass, 36g  
Carbon

**Battery Plate**  
19g 26g 37g  \_\_\_\_\_

**Rear Ballast**  
19g 26g

**Anti-Squat Block**  
Brass, 22g  
Aluminium

Total Weight: \_\_\_\_\_  
 FR: \_\_\_\_\_ % RR: \_\_\_\_\_ %

NOTES