

Name: Reno Savoya Date: 01/09/2019 Event: French Nats Rd5
 City: Lyon, France State: Track: CARCA Noeux les Mines



Track Dirt Carpet Tight Smooth Hard Packed Dry Grip Level: Low Medium High
 Conditions: Clay Astro Turf Open Rough Loamy Wet Tread Level: Pin Ghost Pin Slicks

Front Suspension

Toe: 1° out Camber: -1°
 Ride Height: 23 mm Caster Block: 0° 5°
 Kick Shim(s): 2mm 1mm Wedge(20°) Other:
 VLA Setting: Short Arm Long Arm
 Front Pivot: Alum Composite Brass
 Pivot Height: SLRC LRC MRC HRC
 Piston: 2x1.6mm Oil: 37.5 wt
 Limiters: Internal: 2mm External: 0 mm Stroke: 24mm
 Shock Eyelet: Std. +2 Shock Location: 2 - Middle
 Spring: Avid Red Sway Bar: none
 Spindle Steering Arm: 4 5 6
 Spindle Ball Stud: Standard Low Spacers:
 Draglink Ball Stud: Standard Low Spacers:
 Axle Spacing: 0 +.5mm +1mm
 Trail: 2mm 3mm 4mm
 Camber Link, Inner: 1 2 3 Outer: A B
 Tower: Stiffezel Carbon Carbon +2mm
 Mud Guard: Soft Standard Stiffezel
 Front Wheels: Standard Stiffezel
 Front Wing: Low High Narrow High Wide

Stiffezel Parts:
Front Arm Rear Arm
Chassis Brace/Waterfall

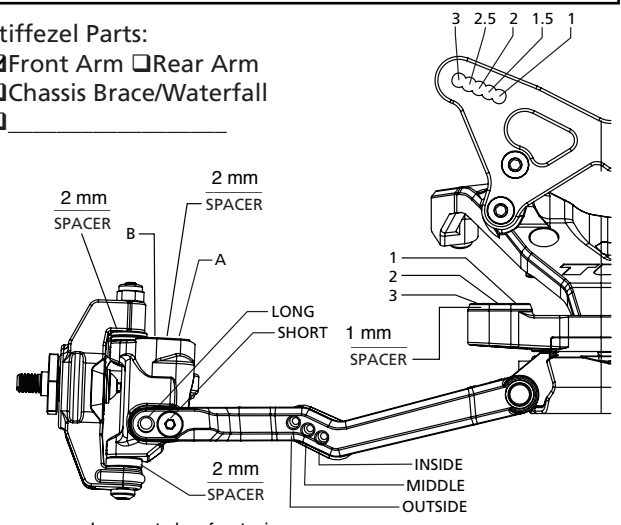

Notes: Jconcepts low front wing

Rear Suspension

Configuration: Laydown Standup
 Diff. Height: 0 +1 +1.75 + 2.5 +3.5
 Axle Height: 0 +1 +2 +3 +4
 Ride Height: 23 mm Camber: -1.5°
 Hub Spacing: 2 mm Fr 1 mm Rr Hex Width: Stock
 Piston: 2x1.7mm Oil: 35 wt
 Spring: LF White TLR233056 Sway Bar: none
 Limiters: Internal: 0 External: 0 Stroke: 31 mm
 Shock Eyelet: Std. +2 Shock Location: 1.5 - middle
 Shock Mounting: Front Rear Shaft Dia.: 3.0 3.5
 Tower: Stiffezel Carbon Carbon +2mm
 Camber Block Spacer: 1mm 0mm 1mm 1mm 1mm 1mm
 Camber Link, Inner: 1 2 3
 Camber Link, Outer: A B C
 Battery Position: 1 2 3 4 5
 Wing/Wickerbill: Stock, line #2
 Wing Angle: 0° 2° 4° Wing Height: Stock (low)
 Diff Type: Ball Gear Setting: 1 rotation
 Gear Diff Gears: Composite Steel Planet Gears: 2 4
 Driveshaft Length: CVA Universal Length: 68 mm
 CV Pin Position: 1 2 3 4
Direct Drive Slipper Pads: Torque (yel) Drive (org)

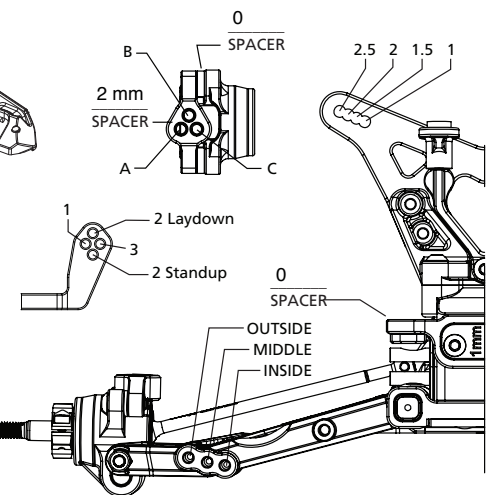
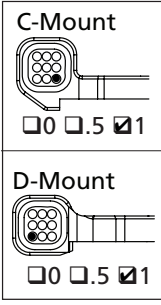
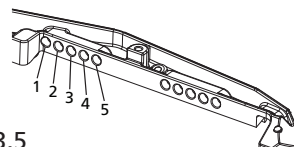
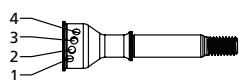

Electronics

Radio: Spektrum Timing Advance: 0
 Servo: Highest DLP750 Steering Expo: Speed -10/-10
 ESC: RC Concept SC10R Throttle/Brake EPA: 100/80
 Motor: RC Concept 7.5T
 Initial Brake: Drag Pinion: 23 Spur: 78
 Drag Brake: 10 Battery: RC Concept Omega 4800
 Throttle Profile: Line Battery Weight:

Tires

	Front	Rear
Thread:	JC Rips	Handout
Compound:	Green	Holeshot M3
Insert:	Stock	JC Dirt Tech
Sauce:	None	None

Notes: ULW Body #TLR230013

Chassis

Electronics Plate Brass, 36g Carbon

Battery Plate 19g 26g 37g

Rear Ballast 16g 25g

C-Pivot Block Brass, 20g Aluminum

Total Weight: 1600g
 FR: % RR: %