

# LAZER ZX7 SETUP SHEET

**KYOSHO**  
THE FINEST RADIO CONTROL MODELS

Name \_\_\_\_\_ Date \_\_\_\_\_ Track / City \_\_\_\_\_ Event \_\_\_\_\_

## Front Suspension

### Shock Position:



### Shock Stay:

- Std.
- Carbon (LAW58)
- \_\_\_\_\_

### Lower Sus Holder Block:

Front \_\_\_\_\_ Rear \_\_\_\_\_

### Lower Sus Holder Spacer:

Front \_\_\_\_\_ mm Rear \_\_\_\_\_ mm

### Upper Arm Position:

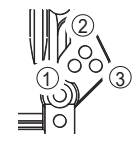

### 4.8mm Ball Stud:

- UM129 (Std)
- 97050M

### Upper Spacer: \_\_\_\_\_ mm

### Camber: \_\_\_\_\_ °

- +

### Spacer: \_\_\_\_\_ mm

### Axle-Height Spacer:

- Up
- Down

### Caster Block:

- 7°
- 10°
- 13°

### Bump Steer Spacer: \_\_\_\_\_ mm

### Toe:

- In \_\_\_\_\_ °
- Out \_\_\_\_\_ °

### Sway Bar:

- None
- \_\_\_\_\_ mm

### Ackerman Spacer: \_\_\_\_\_ mm

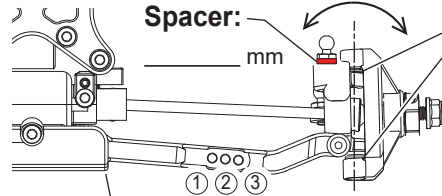

### Shock Position

Wheelbase: Front \_\_\_\_\_ mm

Rear \_\_\_\_\_ mm

### Sus Bushing

- Wide
- Narrow (STD)

## Front Diff

- Gear \_\_\_\_\_
- Ball \_\_\_\_\_

Comments \_\_\_\_\_

## Rear Suspension

### Shock Position:

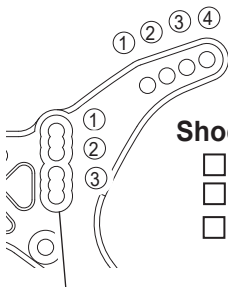

### Shock Stay:

- Std.
- Carbon (LAW59)
- \_\_\_\_\_

### Wing Stay Position

### Lower Sus Holder Block:

Front \_\_\_\_\_ Rear \_\_\_\_\_

### Lower Sus Holder Spacer:

Front \_\_\_\_\_ mm Rear \_\_\_\_\_ mm

### Upper Arm Position:

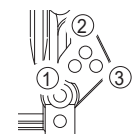

### 4.8mm Ball Stud:

- 97050M (Std)
- UM129

### Upper Spacer: \_\_\_\_\_ mm

### Toe In: \_\_\_\_\_ °

### Camber: \_\_\_\_\_ °

- +

### Sus. Arm:

- LA272
- UM713B
- UM762(Std)

### Hub Carrier:

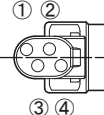

Type-B (UM519)

Type-B2 (UM519-2)

- 0° Type-B (UM519)
- 0° Type-B2 (UM519-2)
- 0° Alu (UMW704-0)
- 0.5° Alu (UMW704-05)
- 1° Alu (UMW704-1)

### Upper Spacer: \_\_\_\_\_ mm

### Sway Bar:

- None
- \_\_\_\_\_ mm

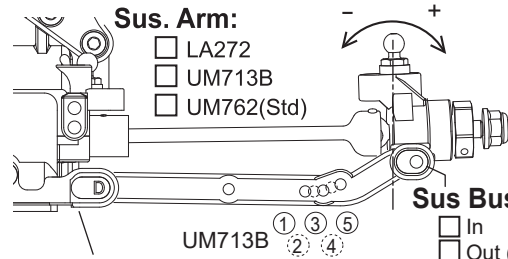

Wheelbase: Front \_\_\_\_\_ mm

Rear \_\_\_\_\_ mm

### Shock Position

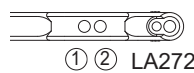

① ② LA272

### Sus Bushing

- In
- Out (Std)

### Wheelbase:

Front \_\_\_\_\_ mm

Rear \_\_\_\_\_ mm

## Center Drive

- Diff. Gear
- Slipper Clutch

Comments \_\_\_\_\_

Notes \_\_\_\_\_

## Shocks

### Front

### Rear

### Piston:

\_\_\_\_\_

### Oil:

\_\_\_\_\_

### Spring:

\_\_\_\_\_

### Limiters:

in \_\_\_\_\_ mm out \_\_\_\_\_ mm

Length (A): \_\_\_\_\_ mm

Top Type:  Alu. (UM719)  UM753-1B (Std)

### Ball End:

Front:  S  M  L

Rear:  S  M  L

### Spring Cup

Front  Rear

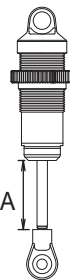

## Chassis

### Centre Bulk

- Front
- Rear
- (Std)

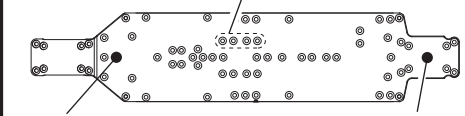

Front \_\_\_\_\_ mm

Ride Height \_\_\_\_\_ mm

Rear \_\_\_\_\_ mm

## Electronics

Motor: \_\_\_\_\_

Pinion/Spur: \_\_\_\_\_

ESC: \_\_\_\_\_

Radio: \_\_\_\_\_

Servo: \_\_\_\_\_

Notes \_\_\_\_\_

## Body & Wing

### Body:

### Wing Dam Height:

\_\_\_\_\_ mm

### Wing:

### Wing Angle:

- 4°
- 7°
- 10°

### Lip Height:

\_\_\_\_\_ mm

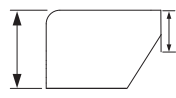

## Material

Screw:  Steel  Titanium

Pinion Gear:  Steel  Aluminium

Shock O-Ring:  O-ring  X-ring  Red  Clear

## Tires

### Front

### Rear

Tire: \_\_\_\_\_

Compound: \_\_\_\_\_

Insert: \_\_\_\_\_

Wheel: \_\_\_\_\_

Notes \_\_\_\_\_

## Track Condition

Am0 - Petric

- Smooth
- Bumpy
- Low Traction
- Med. Traction
- High Traction
- Wet
- Dry
- Sandy
- Soft Dirt
- Grass
- Blue Groove
- Clay
- Dusty
- \_\_\_\_\_

NOTES