

Name \_\_\_\_\_

Date \_\_\_\_\_

Track / City \_\_\_\_\_

Event \_\_\_\_\_

### Front Suspension

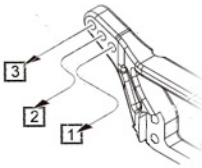

Spacer: \_\_\_\_\_ mm



Bellcrank Spacer: \_\_\_\_\_ mm

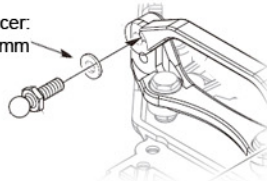

Camber Angle: \_\_\_\_\_ °  
 Toe Angle: \_\_\_\_\_ °  
 Ride Height: \_\_\_\_\_  
 Sway Bar: \_\_\_\_\_

Suspension Holder Spacer:

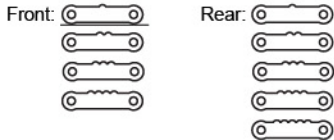

Notes: \_\_\_\_\_

Ball stud position:  
 Stock  
 Kingpin

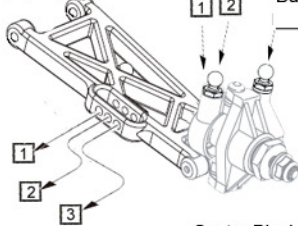

Hub Spacer: \_\_\_\_\_ mm

Bump Steer Spacer: \_\_\_\_\_ mm

Knuckle  
 Standard  
 Opposite

Axle Height Spacer:  
 Up  
 Down

Hex Spacer: \_\_\_\_\_ mm

Caster Block:  
 7°  
 10°

Shock Piston: \_\_\_\_\_  
 Shock Oil: \_\_\_\_\_  
 Shock Spring: # \_\_\_\_\_

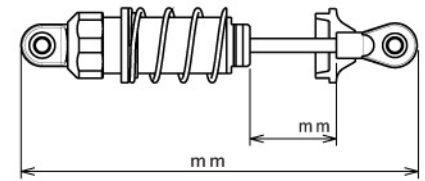

### Rear Suspension

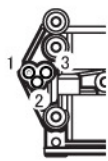
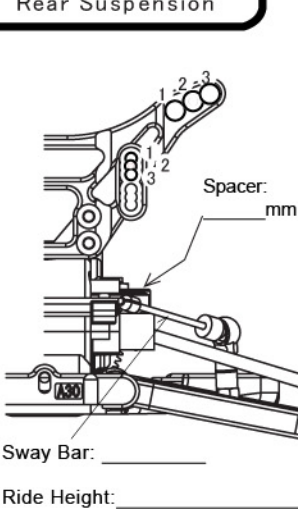

Suspension Holder:

Front: \_\_\_\_\_  
 Rear: \_\_\_\_\_

Suspension Holder Spacer:

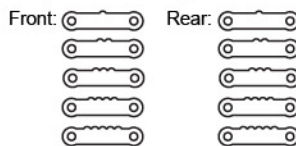

Notes: \_\_\_\_\_

Spacer: \_\_\_\_\_ mm

Hub Carrier Spacer: \_\_\_\_\_ mm

Hub Carrier  
 2°  
 0°

Hub Carrier Height  
 Up  
 Middle  
 Down

Camber Angle: \_\_\_\_\_ °

Hex Spacer: \_\_\_\_\_ mm

Wheelbase  
 Short  
 Medium  
 Long

Shock Piston: \_\_\_\_\_  
 Shock Oil: \_\_\_\_\_  
 Shock Spring: # \_\_\_\_\_

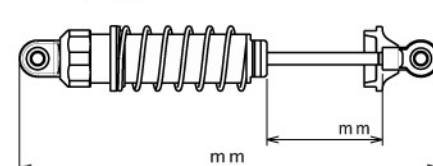

### Tire

Front Tire \_\_\_\_\_  
 Rear Tire \_\_\_\_\_  
 Front Inserts \_\_\_\_\_  
 Rear Inserts \_\_\_\_\_

### Compound

### Others

Motor \_\_\_\_\_  
 Pinion/Spur \_\_\_\_\_ / \_\_\_\_\_  
 Wing \_\_\_\_\_  
 Wing Angle  0°  4°  7°

Center Shaft  
 Oneway  
 Direct

Slipper Sheet  
 Red-White  
 Red-Red  
 White-White

### Track Condition

Smooth  Dry  
 Bumpy  Wet  
 Low Traction  Dusty  
 Med Traction  Indoor  
 High Traction  Outdoor

### Spring Rate

#50	Black	#68	Blue
#55	Orange	#70	Silver
#60	Orange Yellow	#75	Light Green
#65	Yellow	#80	Green

### Gear Ratio

Secondary Gear Ratio 2.5 (16:40)

	16	17	18	19	20	21	22	23	24	25
76	/	11.18	10.56	10.00	9.50	9.05	8.64	8.26	7.92	7.60
78	12.19	11.47	10.83	10.26	9.75	9.29	8.86	8.48	8.13	7.80

### Shock Piston

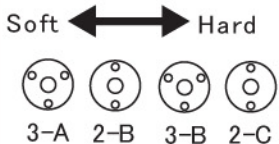

Notes: \_\_\_\_\_

### Sway Bar

1.0	Nickel
1.1	Gold
1.2	Silver
1.3	Copper
1.4	Black
1.5	Golden
1.6	Chromium

### ESC & Battery

ESC: \_\_\_\_\_  
 ESC Settings: \_\_\_\_\_

Battery: \_\_\_\_\_

Battery Position:  
 Front  
 Rear

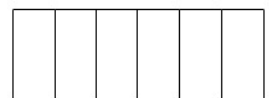

### Comments