

Name  
**Rich Cree**

Date  
**17/01/2010**

Track  
**Maritime Raceway**

Event  
**Petit 2010**

### Front Suspension

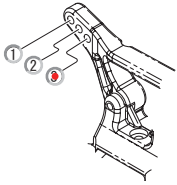

Spacer: 0 mm

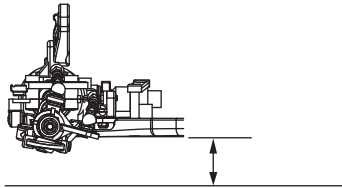

Ride Height 19 mm

Camber Angle: 1°

Toe Angle: 1.5°

Sway Bar: n/a

Front Diff:

- Rigid  
 Oneway  
 Differential, Setting: Tight

Sus. Holder Spacer:

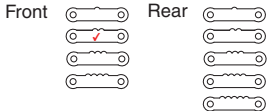

Notes:

Spacer: 0 mm

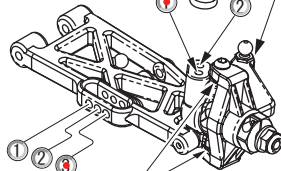

Bump Steer Spacer: 0 mm

Caster Block:  
 7°  
 10°

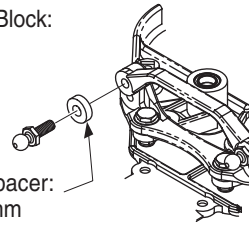

Axle-Height Spacer:  
 Up  
 Down

Bellcrank Spacer: 1 mm

Shock Piston: 3A  
 Shock Oil: # 35wt  
 Shock Spring: # #65 Yellow

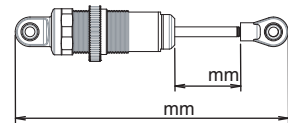

### Rear Suspension

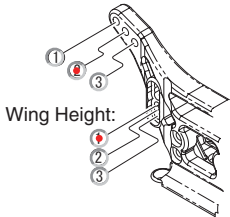

Wing Height:

Spacer: 0 mm

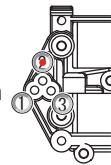

Camber Angle: 1°

Sway Bar: 1.2

Rear Hubs:  
 Type-B (UM519)   
 UMW516-0   
 UMW516-1

Sus. Holder(RF):

- Standard  
 LAW36

IN  OUT

Sus. Holder(RR):

- Standard  
 LAW37

IN  OUT

Ride Height 19 mm

Sus. Holder Spacer:

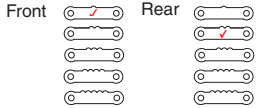

Notes:

Rear Block A2-30

Rear Diff Loose

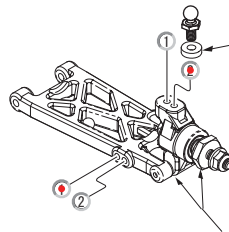

Spacer: 2 mm

Rear Sus. Arm:  
 Standard  
 UM521

Notes:

Wheel Shaft Type

- (UM522-02)  
 (UM510-02)  
 PL-Wheel (UMW502)

Hub Spacer:

F: 1 mm  
 R: 1 mm

Wheel Spacer:  
kit mm

Shock Piston: 3A  
 Shock Oil: # 30wt  
 Shock Spring: # #60 Dark Yellow

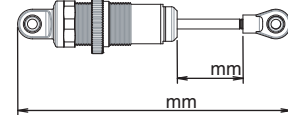

### Tyre

Front Tyre Schu Mini Pin Compound: Yellow

Rear Tyre Schu Mini Pin Compound: Yellow

Front Inserts: Schu Med

Rear Inserts: Schu Med

### Others

Motor: Orion 5.5

Pinion/Spur: 20 / 78

Wing: Blast

Wing Angle:  0°  7°  
 4°

Slipper Type:

- Direct  
 Separates

Slipper Sheet(F-R):

- Red-White  
 Red-Red  
 White-White

### Truck Condition

- Smooth  Dry  
 Bumpy  Wet  
 Low Truction  Dusty  
 Med. Truction  Indoor  
 Higt Truction  Outdoor

### Spring Rate

#50	Black	#68	Blue
#55	Orange	#70	Silver
#60	Orange Yellow	#72	Cobalt Blue
#65	Yellow	#75	Light Green

### Gear Ratio

Gear Ratio **2.5:1**

	16	17	18	19	20	21	22	23	24	25
76	/	11.18	10.56	10.00	9.50	9.05	8.64	8.26	7.92	7.60
78	12.19	11.47	10.83	10.26	9.75	9.29	8.86	8.48	8.13	7.80

### Shock Piston

Soft  $\longleftrightarrow$  Hard

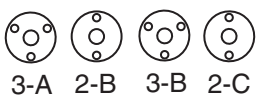

### Sway Bar

1.0	Nickel
1.1	Gold
1.2	Silver
1.3	Copper
1.4	Black
1.5	Golden
1.6	Chromium

### ESC&Battery

ESC: LRP SXX

ESC Setting: \_\_\_\_\_

Battery: Reedy 4300 35c

Battery Position: Front  Rear

Notes:

### Comments