

Name
Nick Caro

Date
17/04/2011

Track
Stotfold

Event
National Rd1

Front Suspension

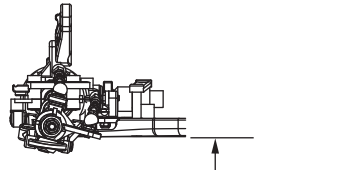
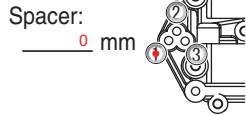
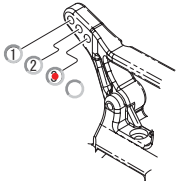

Ride Height **19.5** mm

Camber Angle: _____ -1°

Toe Angle: _____ 0°

Sway Bar: _____

Front Diff:
 Rigid
 Oneway
 Differential, Setting: loose

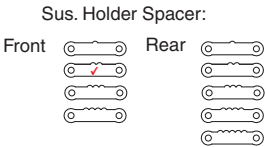

Notes:
 Vega Steering Ackermann Mod..
 Yokomo X Shock Spring 'Green'

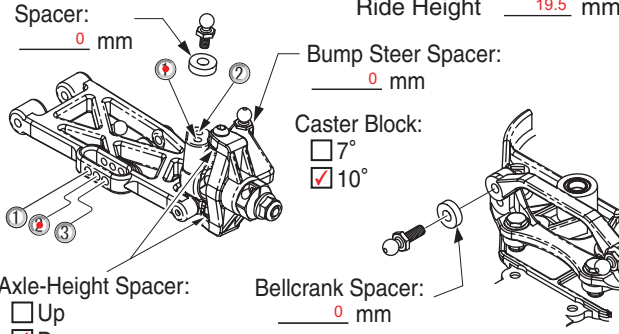

Shock Piston: Big Bore 5 Hole
 Shock Oil: # 40wt
 Shock Spring: #Yokomo BB Green

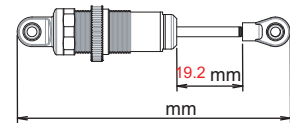

Rear Suspension

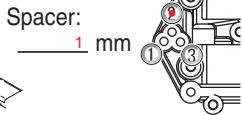
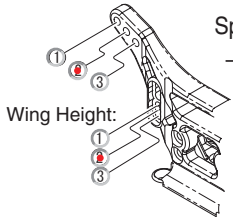

Camber Angle: _____ -1°

Sway Bar: 1.2mm

Sus. Holder(RF):
 Standard
 LAW36

IN OUT A

Sus. Holder(RR):
 Standard
 LAW37

IN OUT E

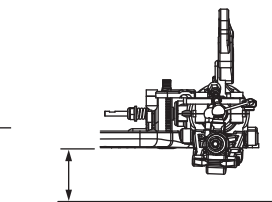

Ride Height **20** mm

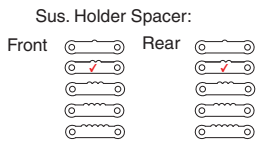

Notes:
 LAW40 Chassis Stiffner.

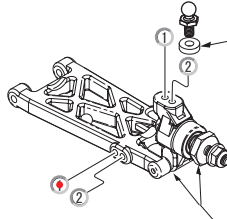

Spacer: _____ mm

Rear Sus. Arm:
 LA255
 LA243
 UM521
 UM521-1

Rear Hubs:
 Type-B (UM519)
 UMW519-2
 UMW516-0
 UMW516-05
 UMW516-1

Wheel Shaft Type
 (UM522-02)
 (UM510-02)
 PL-Wheel I (UMW502)

Notes:
 Long Wheelbase

Hub Spacer:
 F: 2 mm Wheel Spacer:
 R: _____ mm _____ mm

Shock Piston: Big Bore 5 Hole
 Shock Oil: # 27.5wt
 Shock Spring: #X-Gear WHITE/MS #68

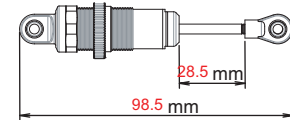

Tyre

Front Tyre Mini Spike Compound: Yellow

Rear Tyre Mini Spike Compound: Yellow

Front Inserts: Mr O's

Rear Inserts: Mr O's

Others

Motor: LRP X12.6.5

Pinion/Spur: 21 / 78

Wing: Blast

Wing Angle: 0° 7°
 4°

Slipper Type:

Direct
 Separates

Slipper Sheet(F-R):

Red-White
 Red-Red
 White-White

Track Condition

Bumpy Dry
 Smooth Wet
 Low Traction Dusty
 Med. Traction Indoor
 High Traction Outdoor

Spring Rate

#50	Black	#68	Blue
#55	Orange	#70	Silver
#60	Orange Yellow	#72	Cobalt Blue
#65	Yellow	#75	Light Green

Gear Ratio

Gear Ratio **2.5:1**

	16	17	18	19	20	21	22	23	24	25
76	/	11.18	10.56	10.00	9.50	9.05	8.64	8.26	7.92	7.60
78	12.19	11.47	10.83	10.26	9.75	9.29	8.86	8.48	8.13	7.80

Shock Piston

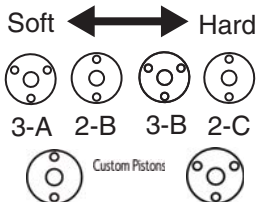

Sway Bar

1.0	Nickel
1.1	Gold
1.2	Silver
1.3	Copper
1.4	Black
1.5	Golden
1.6	Chromium

ESC&Battery

ESC: Vortex Race Spec

ESC Setting: Custom

Battery: LRP 5000 50c

Battery Position: Front Rear

Notes:

Comments

2deg toe (was BBin DDout @ 2deg but narrower..)

1.50 deg Anti Squat (#2FR, #2RR) - LAW40 Chassis Stiffner., Using 50mm Shock shaft.

Slipper set as direct "pinned" - LRP 12.5mm Works Sintered Rotor.