

Name
秋元 宏太

Date
2009/11/8

Truck
加西T&Tサーキット

Event
お別れレース向け

Front Suspension

Camber Angle: -2 °
Toe Angle: OUT:1 °
Sway Bar: None

Front Diff:

Rigid

Oneway

Differential, Setting: **リヤと同じ**

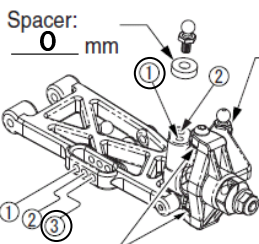
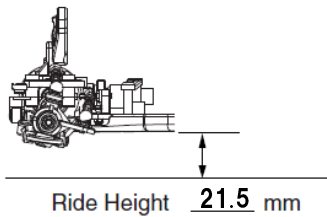
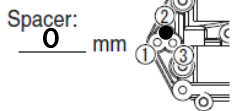
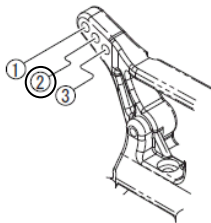

Caster Block:

7°

10°

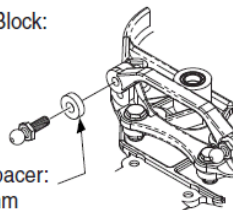

Sus. Holder Spacer:

Front

Rear

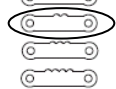

Axle-Height Spacer:

Up

Down

Bellcrank Spacer:

1 mm

Shock Piston: 2C
Shock Oil: # 42.5 ※1
Shock Spring: # ゴールド※1

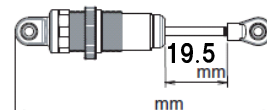

Rear Suspension

Camber Angle: 2 °

Sway Bar: 1.2mm

Sus. Holder(RF):

Standard

LAW36

IN OUT

B

Sus. Holder(RR):

Standard

LAW37

IN OUT

F

Ride Height 22 mm

Wing Height:

Sus. Holder Spacer:

Front

Rear

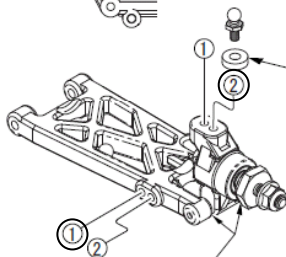
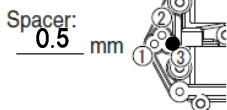
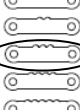
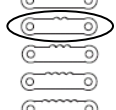

Rear Sus. Arm:

Standard

UM521

Notes: _____

Hub Spacer:

F: 2 mm

R: 0 mm

Wheel Spacer:

0 mm

Shock Piston: 2C
Shock Oil: # 40 ※1
Shock Spring: # ゴールド ※1

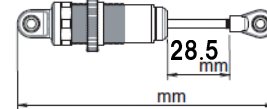

Tire

Front Tire: HoleShot

Rear Tire: HoleShot

Front Inserts: Normal

Rear Inserts: Normal

Compound:

M3

M3

Others

Motor: VORTEX 5.5T

Pinion/Spur: 17 / 78

Wing: Blast-L

Wing Angle: 0° 7°

4°

Slipper Type:

Direct

Separates

Slipper Sheet(F-R):

Red-White

Red-Red

White-White

Truck Condition

Smooth

Bumpy

Low Truaction

Med. Truaction

High Truaction

Dry

Wet

Dusty

Indoor

Outdoor

Spring Rate

#50	Black	#68	Blue
#55	Orange	#70	Silver
#60	Orange Yellow	#72	Cobalt Blue
#65	Yellow	#75	Light Green

Gear Ratio

		Secondary Gear Ratio 2.5 (16:40)									
		16	17	18	19	20	21	22	23	24	25
76			11.18	10.56	10.00	9.50	9.05	8.64	8.26	7.92	7.60
78		12.19	11.47	10.83	10.26	9.75	9.29	8.86	8.48	8.13	7.80

Shock Piston

Soft ← → Hard

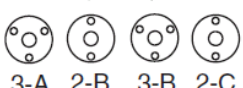

Sway Bar

1.0	Nickel
1.1	Gold
1.2	Silver
1.3	Copper
1.4	Black
1.5	Golden
1.6	Chromium

ESC&Battery

ESC: LRP TC SPEC

ESC Setting: 2.1.1.1

Battry: ORION 4200SHO

Battry Position:

Front

Rear

Comments

※1:ダンパーオイルとスプリングについて

現在はオイル/スプリング共にX-GEAR製を使用。

(※オイルはレッドを使用)