

Name
Gayo

Date
29/09/12

Track
MA

Event
Warm-up Cpe Fce

Front Suspension

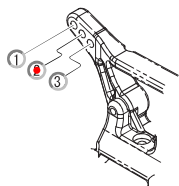

Spacer: 1 mm

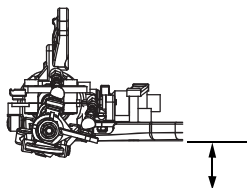
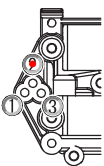

Ride Height 18 mm

Camber Angle: -1°

Toe Angle: 0°

Sway Bar: _____

Front Diff:

Rigid

Oneway

Differential, Setting: Moyen

Sus. Holder Spacer:

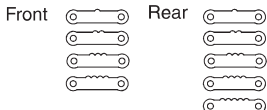

Spacer: 2 mm

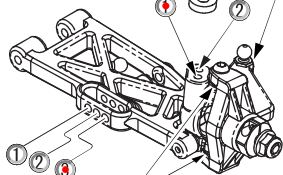

Bump Steer Spacer: 1 mm

Caster Block:

7°

10°

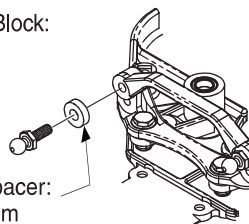

Axle-Height Spacer:

Up
 Down

Bellcrank Spacer: Red + 2 mm

Shock Piston: _____
Shock Oil: # 35wt
Shock Spring: # _____

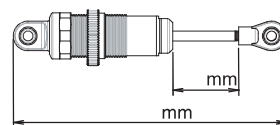

Notes:

Pistons 5x1.30 - ressort Yok vert - rotule -3t
Sur l'humide, ancrage milieu triangle,
rotule serrée
Barre de direction Red Workshop 4mm +
2mm rondelles

Rear Suspension

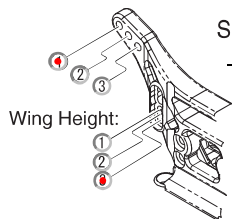

Spacer: 2 mm

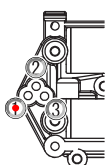

Camber Angle: -1°

Sway Bar: 1.2

Rear Hubs:

Type-B (UM519)

UMW519-2

UMW516 0

UMW516-05

UMW516-1

Sus. Holder(RF):

Standard

LAW36

IN OUT C

Sus. Holder(RR):

Standard

LAW37

IN OUT E

Ride Height 18 mm

Sus. Holder Spacer:

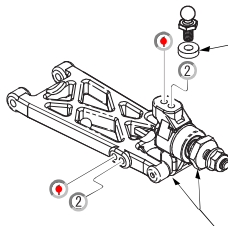
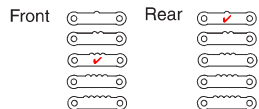

Spacer: 3 mm

Rear Sus. Arm:

LA255

LA243

UM521

UM521-1

Wheel Shaft Type

(UM522-02)

(UM510-02)

PL-Wheel I (UMW502)

Notes:

Diff serré

Hub Spacer:

F: 2 mm

R: 0 mm

Wheel Spacer:

_____ mm

Shock Piston: _____
Shock Oil: # 32.5wt
Shock Spring: # _____

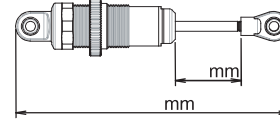

Notes:

Piston 5x1.35 - ressort K Red - Triangles NCG
Cardan FS 62.5mm, spacer côté intérieur
65g entre les packs (Rudebits)

Tyre

Front Tyre Minispike Schum Compound: Jaune

Rear Tyre Minispike Schum Compound: Jaune

Front Inserts: Parpaing PL

Rear Inserts: Parpaing PL

Others

Motor: 6.5 Orion

Pinion/Spur: 24 / 78

Wing: Blast small

Wing Angle: 0° 7°
 4°

Slipper Type:

Direct

Separates

Slipper Sheet(F-R):

Red-White

Red-Red

White-White

Track Condition

Bumpy

Smooth

Low Traction

Med. Traction

High Traction

Dry

Wet

Dusty

Indoor

Outdoor

Spring Rate

#50	Black	#68	Blue
#55	Orange	#70	Silver
#60	Orange Yellow	#72	Cobalt Blue
#65	Yellow	#75	Light Green

Gear Ratio

	16	17	18	19	20	21	22	23	24	25
76	/	11.18	10.56	10.00	9.50	9.05	8.64	8.26	7.92	7.60
78	12.19	11.47	10.83	10.26	9.75	9.29	8.86	8.48	8.13	7.80

Gear Ratio **2.5:1**

Shock Piston

Soft \longleftrightarrow Hard

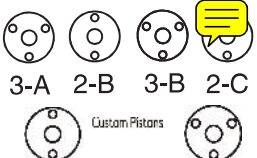

3-A 2-B 3-B 2-C

Custom Pistons

Humide : Pistons 5x1.30 - ressort Yok vert

Sway Bar

1.0	Nickel
1.1	Gold
1.2	Silver
1.3	Copper
1.4	Black
1.5	Golden
1.6	Chromium

ESC&Battery

ESC: Orion R10

ESC Setting: Timing 8, turbo 10,
punch 4

Battery: LRP 5500 90c

Battery Position: Front Rear

Notes:

Comments

Humide : Jaunes neufs -

Sec : usés 50% devant, int/ext coupés