

Name: Team drivers (starting) Date: Aug 13, 2012 Track/City: WCRC Event: 2012 ROAR Super Nats

Front Suspension

- Shock Stay
 Stock (UM511)
 Big Bore (UM525)

Caster 30° 25°
 Spacer
 None
 0.5mm
 1mm

Camber 1°
 Toe 0°

Ackerman Ball Stud Spacer 2 mm

Axle Height Spacer
 Up
 Down
 Bump Steer Spacer 0 mm



Upper Spacer 2 mm

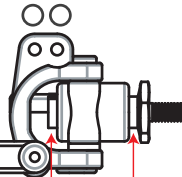

Axle Spacer
 Out
 In mm

Wheelbase
 Long Mid Short

Front Bulkhead Weight Placement
 None (1oz = 28g)

Inside Bulkhead 10 g oz
 On Skid Plate 15 g oz

Comments: Using SP2 front axles w/hex

Rear Suspension

Lower Suspension Holder
 Stock
 Narrow RF (RB5) Aluminum UMW511+UMW512
 Wide RF2 (RB5SP) UMW514+UMW515

Suspension Holder Spacer
 F None 0.5mm 1mm
 R None 0.5mm 1mm

Camber 2°

Hub Type
 Stock 0° Type B -4.7mm (UM519)
 0.5°, +4.7mm (LA244-05)
 Type B, +4.7mm (UM519-2)

Aluminum
 0° (UMW516-0)
 0.5° (UMW516-05)
 1° (UMW516-1)

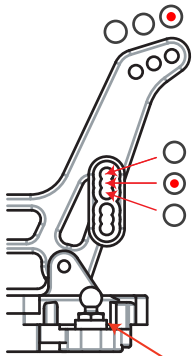

Upper Spacer 1 mm

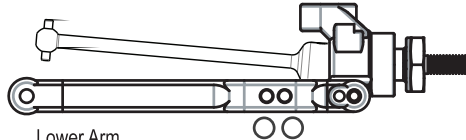
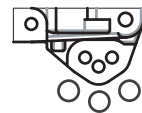

Lower Arm
 Stock (UM521)
 Med, Type B (UM521-1)

Axle Spacer
 Out In mm

Upper Spacer 1 mm
 Wheelbase Short None Sway Bar
 Middle Long mm

Anti-Squat 2°

Comments: Wing mount spaced back with 3mm spacer

Shocks

	Front	Rear
Shock Body	<input type="checkbox"/> Stock (W5194V) <input checked="" type="checkbox"/> Big Bore (W5303V)	<input type="checkbox"/> Stock (W5196V) <input checked="" type="checkbox"/> Big Bore (W5304V)
Shock Piston	<input type="checkbox"/> Stock <input checked="" type="checkbox"/> Big Bore <input checked="" type="checkbox"/> 55	<input type="checkbox"/> Stock <input checked="" type="checkbox"/> Big Bore <input checked="" type="checkbox"/> 55
Shock Oil	<input type="checkbox"/> 32.5 <input checked="" type="checkbox"/> 32.5	<input type="checkbox"/> 27.5 <input checked="" type="checkbox"/> 27.5
Shock Spring	<input type="checkbox"/> Pink <input checked="" type="checkbox"/> Pink	<input type="checkbox"/> Red <input checked="" type="checkbox"/> Red
Limiters	<input type="checkbox"/> In <input type="checkbox"/> Out <input type="checkbox"/> mm	<input type="checkbox"/> In <input type="checkbox"/> Out <input type="checkbox"/> mm
Length	<input type="checkbox"/> A <input checked="" type="checkbox"/> B <input checked="" type="checkbox"/> 19.1 mm	<input type="checkbox"/> A <input checked="" type="checkbox"/> B <input checked="" type="checkbox"/> 27.6 mm
Rear Shock Shaft	<input checked="" type="checkbox"/> Stock (W5193-01) <input type="checkbox"/> ZX-5 (W5183-02)	<input checked="" type="checkbox"/> Stock <input type="checkbox"/> Short (ZX-5) <input checked="" type="checkbox"/> Stock <input type="checkbox"/> Short (ZX-5)

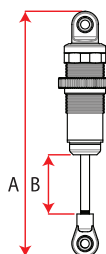

Body/Wing/Chassis

Wing
 Blast-L (LA251)
 Blast-S (LA247)
 Step-L (LA247)
 Step-S (LA247)
 Other _____

Wing Angle 4° 7° 10°

Battery Placement
 Forward
 Back

Body
 Sword (Stock, UMB02)
 Trident (UMB01)
 Other PL Bulldog

Weight Placement (in addition to front end listed above)
 Total Weight

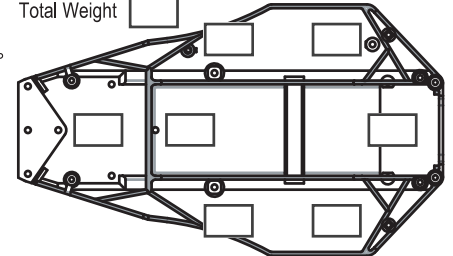

Ride Height
 Front A B 24 mm
 Rear A B 23.5 mm

Other

	Front	Rear	Track Conditions	Traction	Electronics
Tire	<input checked="" type="checkbox"/> Gold Bar Codes	<input checked="" type="checkbox"/> PL Sub MC	<input checked="" type="checkbox"/> Smooth <input checked="" type="checkbox"/> Clay <input type="checkbox"/> Blue Groove	<input type="checkbox"/> Low	Battery <input type="checkbox"/> Spur <input checked="" type="checkbox"/> 78
Insert	<input checked="" type="checkbox"/> PL closed	<input checked="" type="checkbox"/> PL Closed	<input type="checkbox"/> Bumpy <input type="checkbox"/> Grass <input type="checkbox"/> Astroturf	<input checked="" type="checkbox"/> Med	ESC <input checked="" type="checkbox"/> Orion Motor <input checked="" type="checkbox"/> 7.5 Pinion <input checked="" type="checkbox"/> 22
Wheel	<input checked="" type="checkbox"/> stock	<input checked="" type="checkbox"/> stock	<input type="checkbox"/> Loamy <input type="checkbox"/> Wet <input type="checkbox"/> Soft Dirt	<input type="checkbox"/> High	Traction Compound <input type="checkbox"/>
			<input type="checkbox"/> Sandy <input type="checkbox"/> Dry <input type="checkbox"/> Other <input type="checkbox"/>		

Comments: 4-hole 55 pistons made with W5303-08 blanks, using +13mm chassis