

**BJ4 WORLDS EDITION SET-UP SHEET:**

**DRIVER** Ryan Eckert

**DATE** August 5-6 2006

**TRACK/CITY** Jacksonville, FL

**EVENT** 2006 Region 4

**NOTES:**

**Rear sway bar kit used.**  
**No washers on rear camber link.**



**TRACK CONDITIONS:**

SOFT SURFACES:    HARD SURFACES:

SAND / SOIL	WET	<input checked="" type="checkbox"/>
LOAMY	HARD SLICK	<input checked="" type="checkbox"/>
RUTS	ABRASIVE	<input checked="" type="checkbox"/>
WET	BLUE GROOVE	<input checked="" type="checkbox"/>
DRY	BLACK GROOVE	<input type="checkbox"/>
	BROKEN	<input type="checkbox"/>

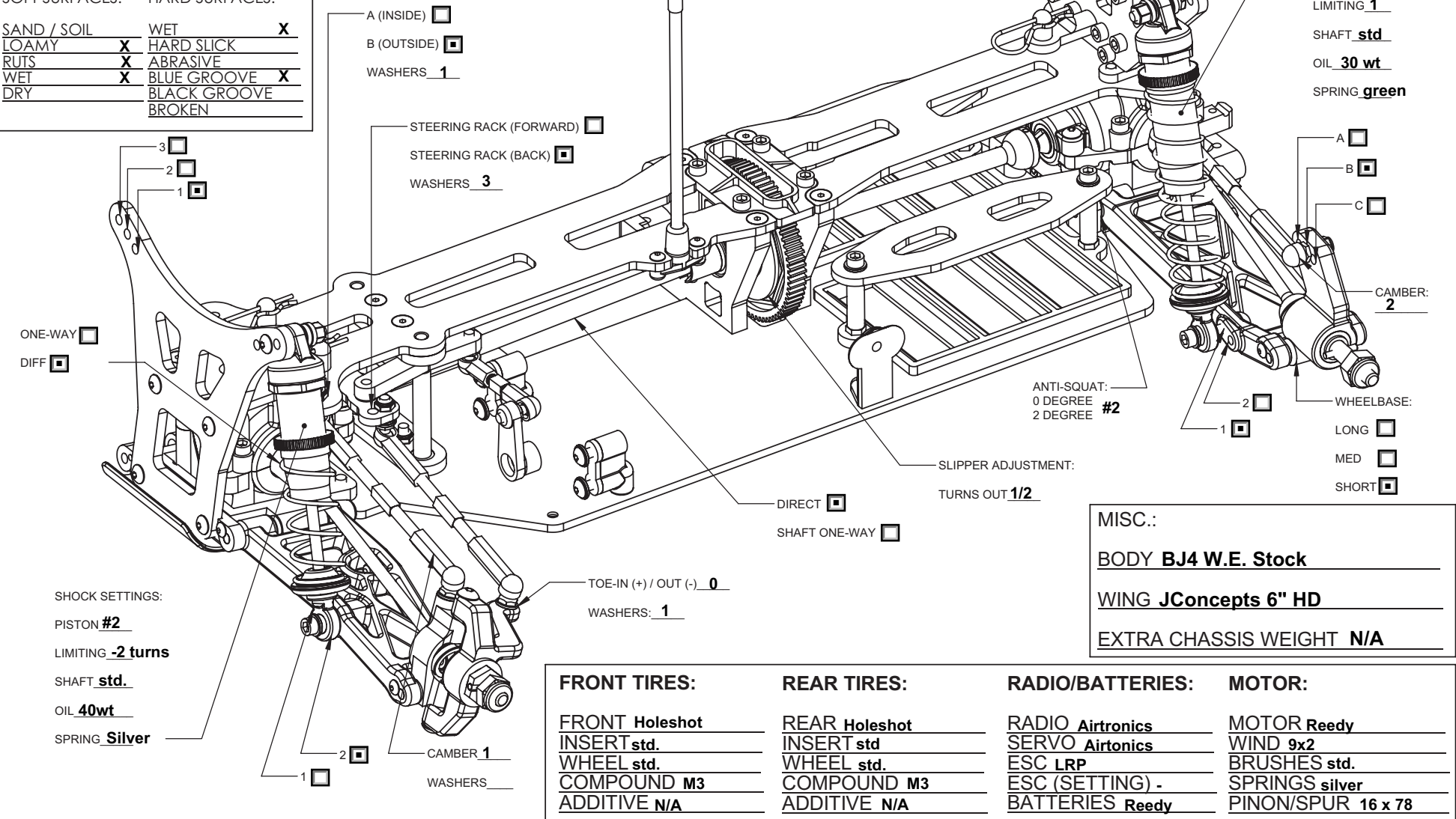

**FRONT TIRES:**  
 FRONT Holeshot  
 INSERT std.  
 WHEEL std.  
 COMPOUND M3  
 ADDITIVE N/A

**REAR TIRES:**  
 REAR Holeshot  
 INSERT std.  
 WHEEL std.  
 COMPOUND M3  
 ADDITIVE N/A

**RADIO/BATTERIES:**  
 RADIO Airtronics  
 SERVO Airtronics  
 ESC LRP  
 ESC (SETTING) -       
 BATTERIES Reedy

**MOTOR:**  
 MOTOR Reedy  
 WIND 9x2  
 BRUSHES std.  
 SPRINGS silver  
 PINON/SPUR 16 x 78

**MISC.:**  
 BODY BJ4 W.E. Stock  
 WING JConcepts 6" HD  
 EXTRA CHASSIS WEIGHT N/A