

Name Ty Tessmann

Date Nov. 14-16

Event Gunsmoke Classic

Track IERC

Track Condition clay, smooth, bumpy, high speed, med bite.

Front

Front kick-up



F/F	F/R	Kick-UP	
.	.	10°	
..	.	9°	
...	.	8°	
.	..	11°	
..	..	10°	
...	..	9°	✓
.	...	12°	
..	...	11°	
...	...	10°	

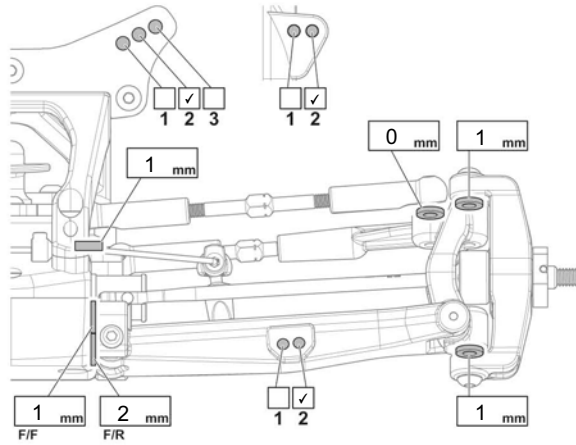

Arm Plates carbon

Ride Height	21	mm
Camber Angle	-.5	°
Toe Angle	.5 out	°
Sway Bar	none	

Shocks

Oil wt.	37.5
Piston	2 x 1.6
Spring	HB gold
*Shock Length	24.5 mm

Notes 1 mm limiter inside
no bladder

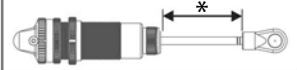

Rear

Rear anti-squat



R/F	R/R	Anti-squat	
.	.	0°	
.	..	1°	
.	...	2°	
..	..	0°	
..	...	1°	✓
...	...	0°	

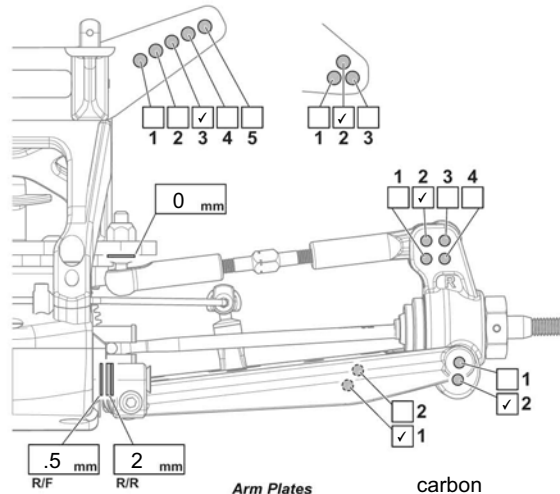

Arm Plates carbon

Ride Height	21	mm
Camber Angle	.5	°
Toe Angle	3.5	°
Sway Bar	copper 1.2	

Shocks

Oil wt.	32.5
Piston	2 x 1.7
Spring	HB Yellow
*Shock Length	30.5 mm

Notes 1mm limiter inside
no bladder

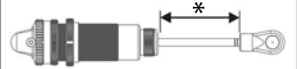

Tires

	Front	Rear
Tire	Proline MC Electron	Proline MC Electron
Insert	closed cell	closed cell

Battery Shvity / Saddle

Position Front / Mid / Back

Motor Orion 5.5

Gearing 21 / 72

Body / Wing Type R / Stock

Diff Oils

	Front	Center	Rear
Brand	Losi	Losi	Losi
Oil wt.	7K	100K	3K

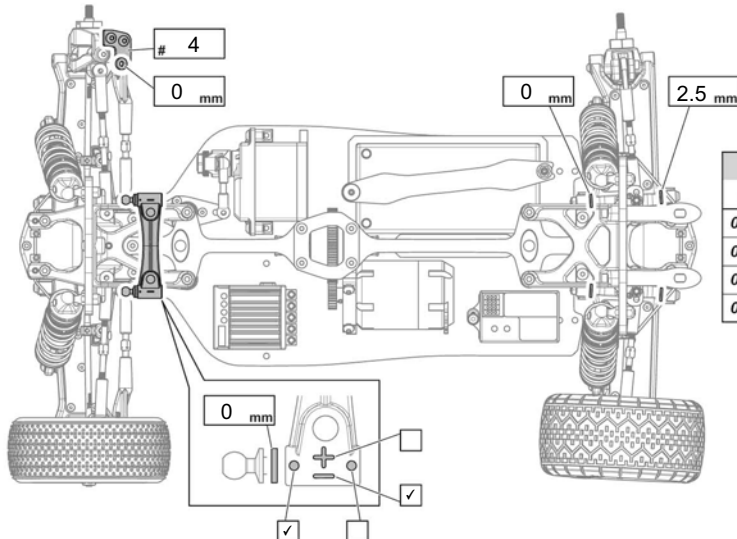

Rear toe-in		
R/F	R/R	Toe-in
0.5mm	0.5mm	2.0°
0.5mm	1.0mm	2.5°
0.5mm	1.5mm	3.0°
0.5mm	2.0mm	3.5°

Wing Height:

- High
- Medium
- Low

Notes Diffs 100% Full, Losi Oils, (c) Rear Tower