

Name Ty Tessmann

Date August 2014

Event 1/10 Offroad Electric Nationals

Track Space Coast, Florida

Track Condition medium traction, bumpy, Dusty, Indoor, Clay.

## Front

### Front kick-up



F/F	F/R	Kick-UP	
•	•	10°	
••	•	9°	
•••	•	8°	
•	••	11°	
••	••	10°	
•••	••	9°	✓
•	•••	12°	
••	•••	11°	
•••	•••	10°	

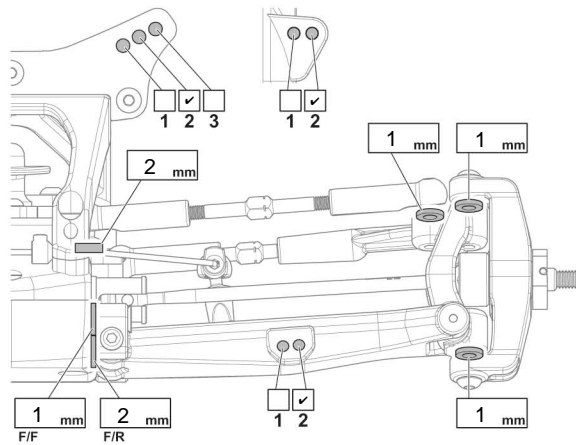

Arm Plates carbon glued

Ride Height	22	mm
Camber Angle	-.5	°
Toe Angle	0	°
Sway Bar	copper 1.2	

### Shocks

Oil wt.	Losi 45
Piston	1.6x2
Spring	HB red
*Shock Length	24 mm

Notes 1mm inside limiter  
no bladder

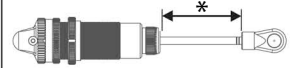

## Rear

### Rear anti-squat



R/F	R/R	Anti-squat	
•	•	0°	
•	••	1°	
•	•••	2°	✓
••	••	0°	
••	•••	1°	
•••	•••	0°	

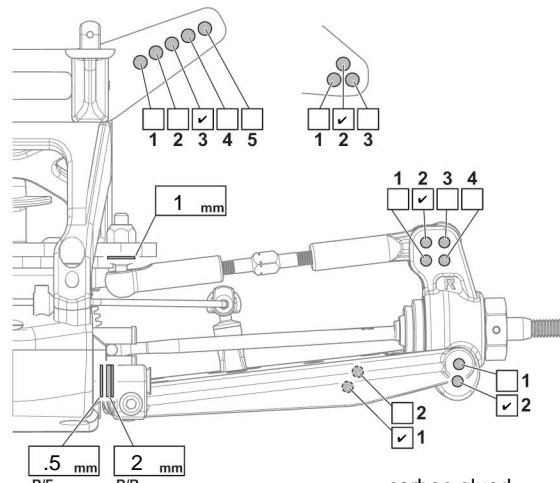

Arm Plates carbon glued

Ride Height	22	mm
Camber Angle	-.5	°
Toe Angle	0	°
Sway Bar	black 1.4	

### Shocks

Oil wt.	losi 42.5
Piston	1.7x2
Spring	HB gold
*Shock Length	32 mm

Notes 0mm inside limiter  
no bladder

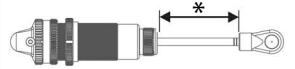

### Tires

	Front	Rear
Tire	Proline scrub mc	Proline Electron mc
Insert	Proline Closed cell	Proline Closed cell

Battery Shvty / Saddle

Position Front / Mid / Back

Motor Orion 5.5

Gearing 21 / 72

Body / Wing Type-R / Stock

### Diff Oils

	Front	Center	Rear
Brand	Losi	Losi	Losi
Oil wt.	7K	100K	3K

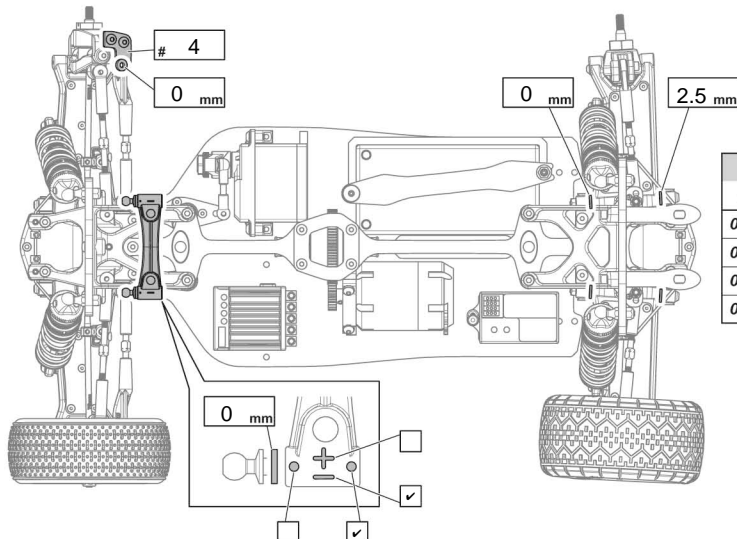

Rear toe-in			
R/F	R/R	Toe-in	
0.5mm	0.5mm	2.0°	
0.5mm	1.0mm	2.5°	
0.5mm	1.5mm	3.0°	
0.5mm	2.0mm	3.5°	✓

### Wing Height:

- High
- Medium
- Low

Notes Rear shock tower C, Aluminum servo horn.