

Track Condition Carpet, Medium Bite Carpet

## Front

Front kick-up			
F/F	F/R	Kick-UP	
○	○	10°	
○○	○	9°	
○○○	○	8°	
○	○○	11°	
○○	○○	10°	
○○○	○○	9°	✓
○	○○○	12°	
○○	○○○	11°	
○○○	○○○	10°	

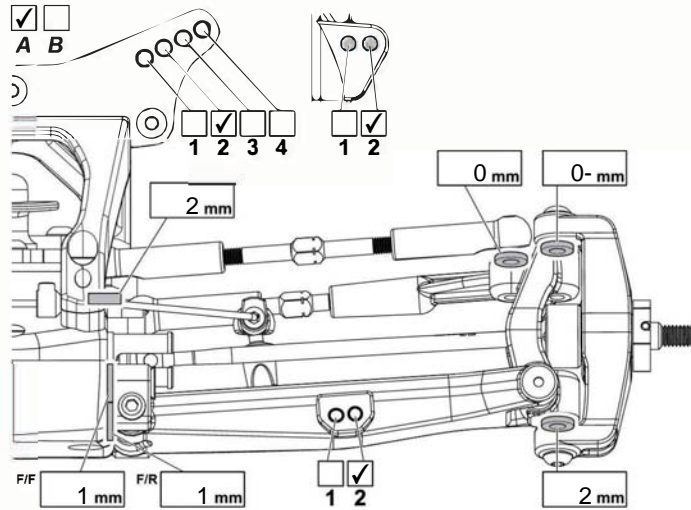

Front Shocks	
Oil wt.	XTR 70wt
Piston	2x1.6
Spring	Gold
Notes	2mm limiter, O-ring outside limiter, Emulsion

Ride Height	15 mm
Camber Angle	1 °
Toe Angle	+0.5 °
Sway Bar	2.0
Shock Length	23 mm



## Rear

Rear anti-squat			
R/F	R/R	Anti-squat	
○	○	0°	✓
○	○○	1°	
○	○○○	2°	
○○	○○	0°	
○○	○○○	1°	
○○○	○○○	0°	

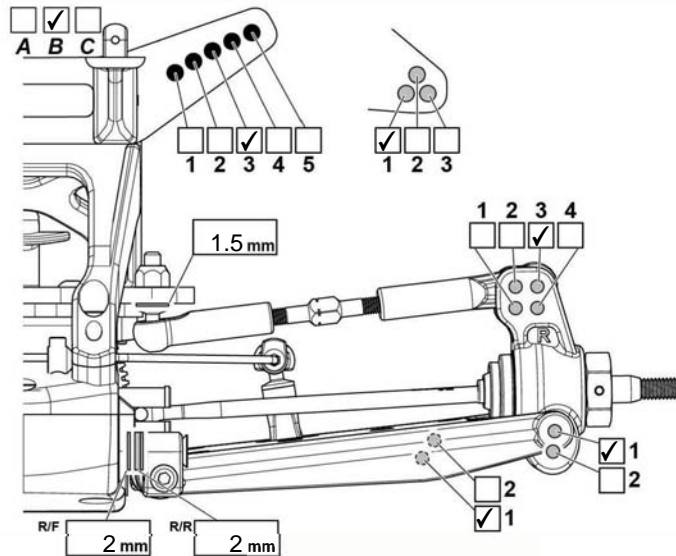

Rear Shocks	
Oil wt.	XTR 40wt
Piston	2x1.7
Spring	Yellow
Notes	Emulsion

Ride Height	15 mm
Camber Angle	2 °
Toe Angle	2 °
Sway Bar	1.8
Shock Length	30 mm



Notes

Prototype Hard Arms Front and Rear with glued carbon.

Tires	
Front	Rear
Tire Wide Stagger	Mini Pin
Insert Medium Blue	Medium Blue

Battery	<input checked="" type="checkbox"/> Shorty <input type="checkbox"/> Saddle
Position	<input checked="" type="checkbox"/> Front <input type="checkbox"/> Mid <input type="checkbox"/> Back
Motor	Front Right Side - 5.0T
Gearing	72 / 21
Body / Wing	Silencer / HB STD

Diff Oils			
	Front	Center	Rear
Brand	XTR	XTR	XTR
Oil wt.	20k	1M	20k

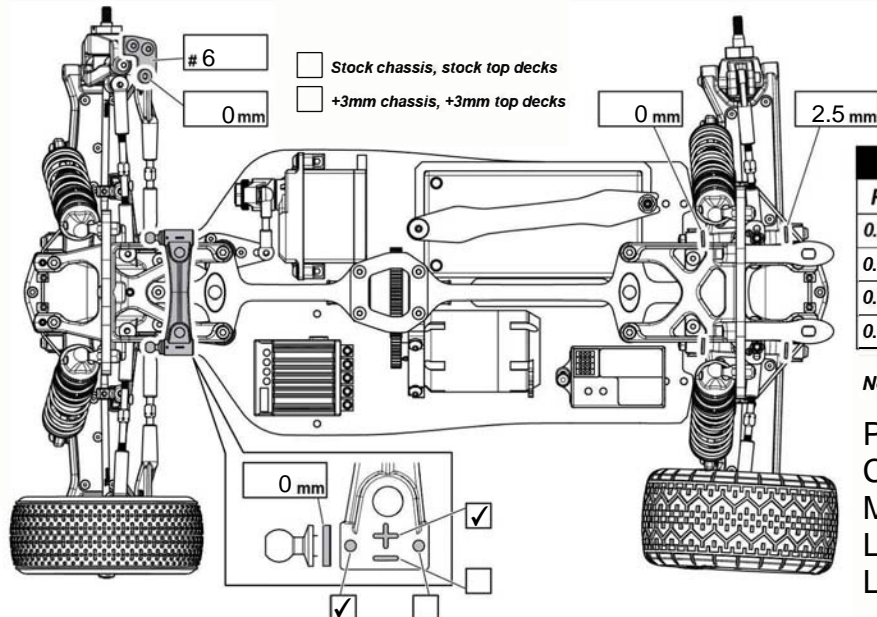

R/F	R/R	Toe-in	
0.5mm	0.5mm	2.0°	✓
0.5mm	1.0mm	2.5°	
0.5mm	1.5mm	3.0°	
0.5mm	2.0mm	3.5°	

Notes

Prototype Chassi +4mm. Motor Front Left, Battery Left Rear.