



D216 Pro Setup Sheet

Driver Ty Tessmann

Date March 2016

Track Leisure Hours

Event Chitown

Track Condition bumpy, med bite

Front

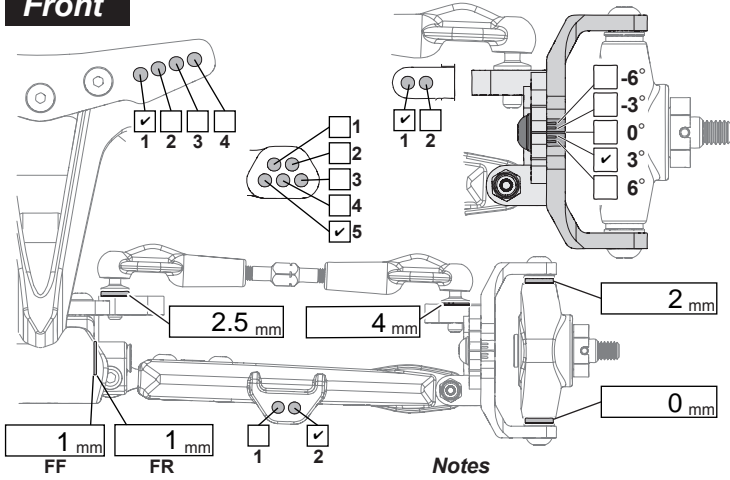

Ride Height 23mm

Camber Angle 0°

Toe Angle .5 out°

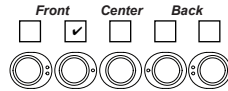

Front Kick-Up

F/F	F/R	Kick-Up	
•	•	22.5°	
••	•	21.2°	
•••	•	20.0°	
•	••	23.8°	
••	••	22.5°	
•••	••	21.2°	
•	•••	25.0°	
••	•••	23.8°	✓
•••	•••	22.5°	

Front Shocks

Oil Weight	<u>35wt</u>
Piston	<u>3 x 1.3</u>
Spring	<u>HB White</u>
*Shock Length	<u>22mm</u>
Notes	<u>4mm inside shock</u>

Rear

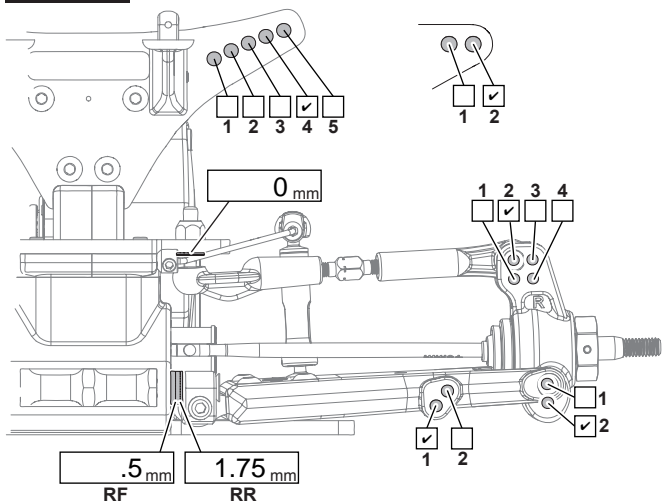

Ride Height 23mm

Camber Angle 0°

Toe Angle 0°

Sway Bar none

Rear Anti-Squat

R/F	R/R	Anti-Squat	
•	•	1.5°	✓
••	•	0.5°	
•••	•	-0.5°	
•	••	3.0°	
••	••	1.5°	
•••	••	0.5°	
•	•••	4.0°	
••	•••	3.0°	
•••	•••	1.5°	

Rear Shocks

Oil Weight	<u>32.5 wt</u>
Piston	<u>2 x 1.6</u>
Spring	<u>HB Gold</u>
*Shock Length	<u>28mm</u>
Notes	<u>3mm inside shock</u>

Notes

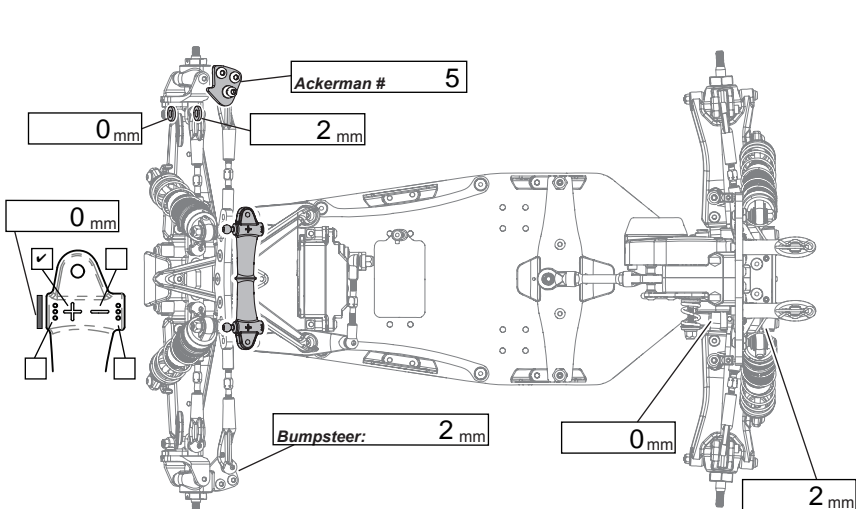

Rear Toe-in

R/F	R/R	Toe-in
0.5mm	1.5mm	1.5°
0.5mm	2.0mm	2.0°
0.5mm	2.5mm	2.5°
0.5mm	3.0mm	3.0°

Differential

Gear Oil Wt.

Ball

Servo

Front Rear

Wing Height

Low Mid High

Tires	Front	Rear
Tire		
Insert		

Battery _____

Motor _____

Pinion _____ Spur _____

Body/Wing _____

Battery Position

Inline • ••

Sideways •• •••

Notes