



NAME Kurt	DATE 2015-02-23	TRACK OCRC Raceway
CITY Hunt. Beach	COUNTRY USA	EVENT 17.5 Stock 3-Gear Gen1
TRACTION LEVEL <input checked="" type="radio"/> HIGH <input type="radio"/> MEDIUM <input type="radio"/> LOW	TRACK TYPE <input checked="" type="radio"/> OPEN <input type="radio"/> MEDIUM <input type="radio"/> TIGHT	TRACK SIZE <input checked="" type="radio"/> LARGE <input type="radio"/> MEDIUM <input type="radio"/> SMALL
CONDITIONS <input type="checkbox"/> WET <input type="checkbox"/> DUSTY <input type="checkbox"/> LOOMY <input type="checkbox"/> DRY <input checked="" type="checkbox"/> GROOVED <input type="checkbox"/> ROUGH	SURFACE <input checked="" type="checkbox"/> INDOORS <input type="checkbox"/> GRAVEL <input type="checkbox"/> CARPET <input type="checkbox"/> OUTDOORS <input type="checkbox"/> ASTRO <input type="checkbox"/> ASPHALT	

### Front Suspension:

**Camber:** 0  
**Total Toe:** 0  
**Ride Height:** 24mm  
**Arm Type:** Flat Arm std  
**Tower Type:** Flat arm std  
**Caster Block Insert:** 0  
**Kick-Up Angle:** 30

**Notes:** Schelle Alum. Steering Bushing

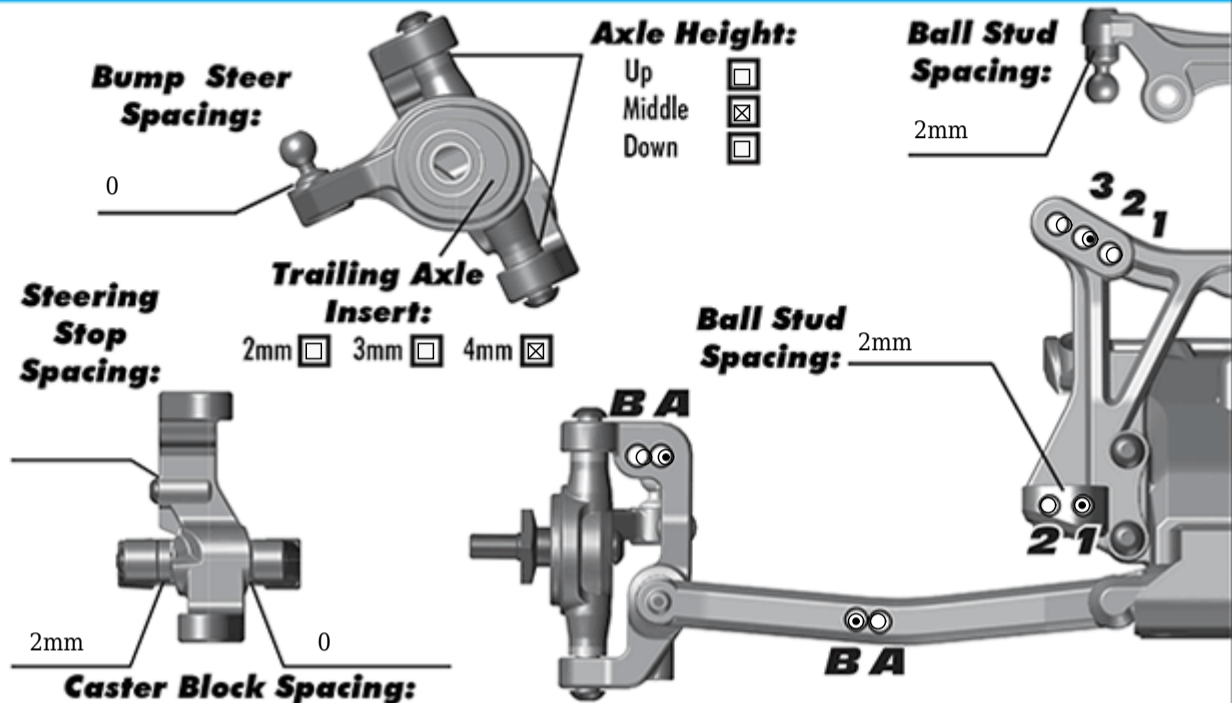

### Rear Suspension:

**Camber:** -1  
**Ride Height:** 24mm  
**Hub Spacing:**  
 Forward  Middle  Back

**Notes:** Schelle Ballstud Mount (middle), flipped -2mm with 3mm washer FT Alum "C" Mount. Schelle Aluminum Rear Hubs, outer ballstud -1mm (0 washer) Same as kit plastic, B-UP

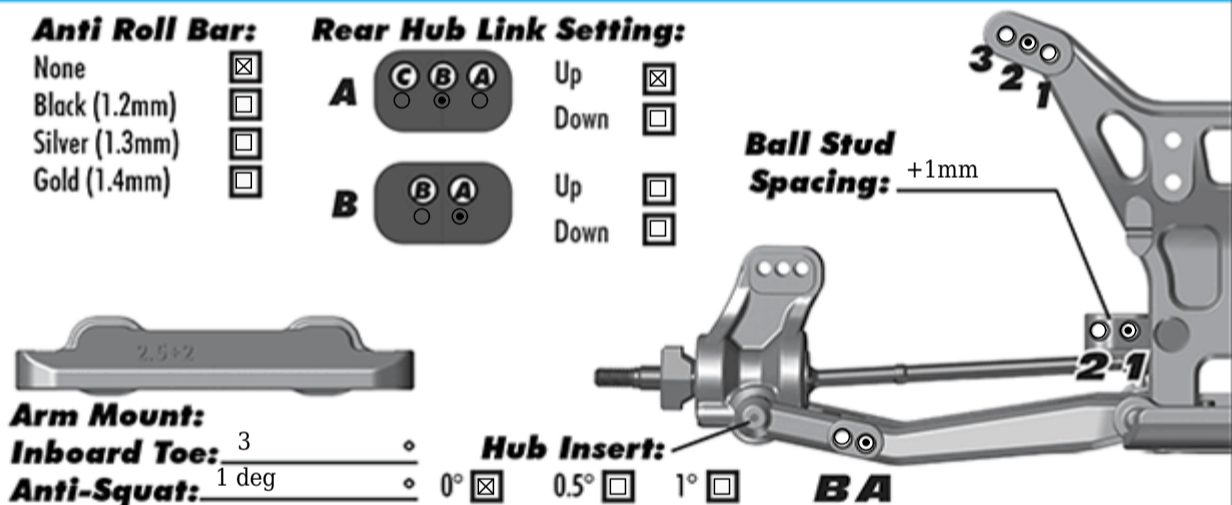

### Electronics:

**Radio:** M11-x **Servo:** Air 94661  
**EPA: Throttle:** 100 % **Brake:** 75 %  
**ESC:** Reedy Blackbox  
**ESC Settings:** 5000-4000hz. 20%drag  
**Motor:** 17.5 Reedy Sonic  
**Wind:** **Timing:** 45deg  
**Pinion:** 31 **Spur:** 72  
**Battery:** Reedy 4100 Shorty, 20A  
**Battery Position:** Back, Servo Tape in

### Drivetrain:

**Differential:**  
**Ball:**   
**Setting:** Std, Schelle balls  
**Gear:**   
**Oil:**

### Slipper Clutch:

**Type:** Schelle Nova  
**# of Pads:** 3  
**Notes:** white-white-red

### Shocks:

	Front	Rear
<b>Piston:</b>	2x1.6 Kit	2x1.6 Bevel
<b>Oil:</b>	30 wt	27.5wt
<b>Spring:</b>	Kyo.White	Kyo White
<b>Limiters:</b>	1	2
<b>Cup Offset:</b>	+5	+5
<b>Stroke:</b>	21.5mm	27mm
<b>Free Length:</b>		
<b>Notes:</b>	Cut front eyelet 1mm	

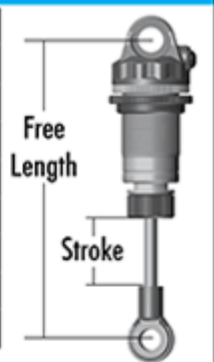

### Track Info:

**Size:** Small  Medium  Large  Extra Large   
**Surfaces:** Dirt  Carpet  Astroturf  Multi Surface   
**Traction:** Low  Medium  High  Very High   
**Moisture:** Dry  Damp  Wet   
**Condition:** Indoor  Outdoor  Dusty  Hard Packed   
 Bumpy  Grooved  Smooth  Loamy

### Tires:

**Tires (F/R):** JConcepts Dirt Web / JC Dirt Web  
**Compound (F/R):** Gold / Gold  
**Insert (F/R):** JC blue / AKA Red  
**Wheel (F/R):** JC / JC  
**Notes:**

### Body & Wing:

**Body:** JC Finisher  
**Wing:** JC Hi Tension  
**Wing Angle:** 0°  3°  6°   
**Notes:** Trim 2nd Line

### Race Results:

**Qualify:** \_\_\_\_\_ **Main:** \_\_\_\_\_  
**Finish:** \_\_\_\_\_ **TQ:**   
**Best Lap Time:** \_\_\_\_\_

### Vehicle Comments:

**Total Vehicle Weight:** Around 1675g