

Front Suspensions:

Camber: -1
Total Toe: 0
Ride Height: 23.5 mm
Arm Type: Flat, Hard #91399
Tower Type: Flat, Standard #91374
Caster Block Insert: 5
Kick-Up Angle: 25° Aluminum #91367
Wheel Hex: Factory Team Aluminum #91411

Notes: Top Plate, Standard #91362
Chassis Plate, Standard #91512
Caster Blocks, Standard #91400 & Steering Blocks, Standard #91404
Steering Set, Plastic #91391

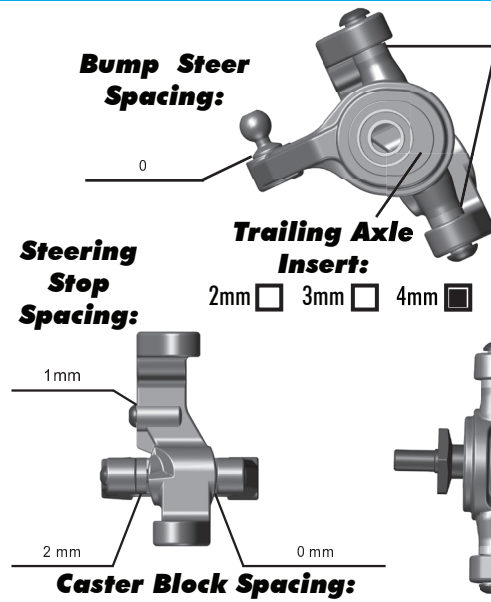

Axle Height:
 Up
 Middle
 Down

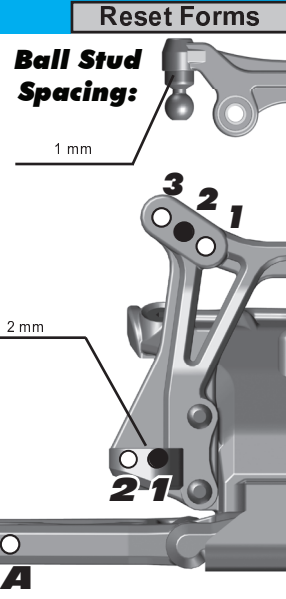

Rear Suspension:

Camber: -2
Ride Height: 23.5 mm
Wheel Hex: Clamping, 7mm #91610
Hub Spacing: Forward Middle Back

Notes: #91413 Rear Arms, Hard
Factory Team Aluminum Hubs #91549 (Back Row Inside +2 mm)
#91522 & #91524 Factory Team Aluminum Arm Mount (C) & (D)

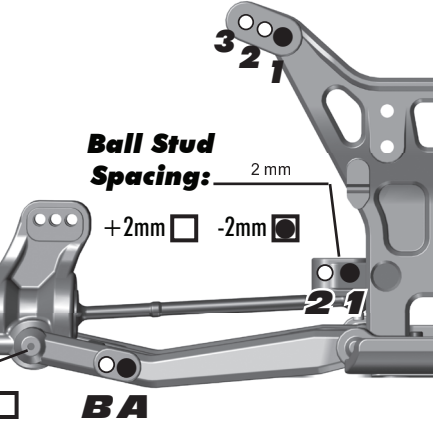
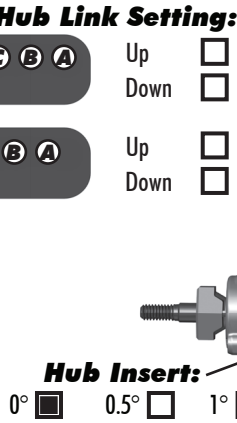
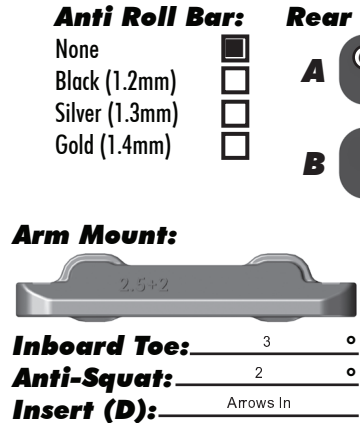

Electronics:

Radio: Airtronics M12 **Servo:** Reedy 1206
EPA: Throttle: 100 % **Brake:** 80 %
ESC: Reedy Blackbox 410R (BEC Voltage 6.0v)
ESC Settings: See Brent Thielke Setup Sheet
Motor: Reedy Sonic M3
Wind: 7.5 **Timing:** 14
Pinion: 23 **Spur:** 81
Battery: Reedy 3800 mAh Wolf Pack #738
Battery Position: Battery 8mm From Back & Taped In

Drivetrain:

Differential:
3 Gear: **4 Gear:**
Ball Diff: **Gear Diff:**
Notes: Tight

Slipper Clutch:
Type: Associated V2 Slipper Plates #7495
of Pads: 2
Notes: B44 Slipper Spring #9739

Shocks:

	Front	Rear
Piston:	2 x 1.6 Flat V2	2 x 1.6 Flat V2
Oil:	32.5 wt	27.5 wt
Spring:	Gray	White
Limiters:	2	2
Cup Offset:	5 mm	5 mm
Stroke:	20.25 mm	27 mm
Free Length:	N/A	N/A
Notes:		

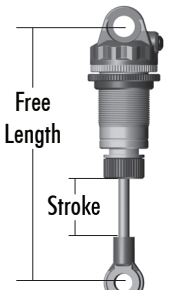

Track Info:

Size: Small Medium Large Extra Large
Surfaces: Dirt Carpet Astroturf Multi Surface
Traction: Low Medium High Very High
Moisture: Dry Damp Wet
Condition: Indoor Outdoor Dusty Hard Packed
 Bumpy Grooved Smooth Loamy

Temperature: Ambient: 65F **Track:** 65F
Notes:

Tires:

Tires (F/R): JConcepts Dirt Webs 2.2 / JConcepts Dirt Webs 2.2
Compound (F/R): Gold / Gold
Insert (F/R): Pro-Line / Pro-Line
Wheel (F/R): Team Associated / Team Associated
Notes: Sticky Kick RC1

Body, Wing & Chassis:

Body: Team Associated Kit #91538
Wing: Team Associated Kit #91471
Wing Angle: 0° 3° 6° 1 mm Under Lower Wing Mount In Tower
Chassis: **#91510 - B5M** **#91511 - B5M Lite**

Race Results:

Qualify: 3 **Main:** A
Finish: TQ:
Best Lap Time: 17.3

Vehicle Comments:

Factory Team Bearing Set #91553; Plastic Shock Caps #91449; Shock Bushings, Aluminum #91446; Ti Screw Kit B5M, #91600; Kashima Shock Bodies #91576 & #91578; V2 Chrome Shock Shafts #91616 & #91620; Front pin brace removed & bumper bent up;
Total Vehicle Weight: 1550g