

### Front Suspensions:

Reset Forms

**Camber:** -1   
**Total Toe:** 0   
**Ride Height:** 24 mm  
**Arm Type:** #91398 Flat, Standard  
**Tower Type:** #91373 Flat, Standard  
**Caster Block Insert:** 5   
**Kick-Up Angle:** 25   
**Wheel Hex:** Lunsford Titanium Front Axle

**Notes:** #91373 Standard Front Hinge Pin Brace  
 #91440 Standard Front Caster Blocks  
 #91404 Standard Steering Blocks  
 #91362 Standard Top Plate  
 #91392 Aluminum Steering Set  
 #91512 Chassis Plate, Standard  
 #91514 Chassis Cradle, Standard

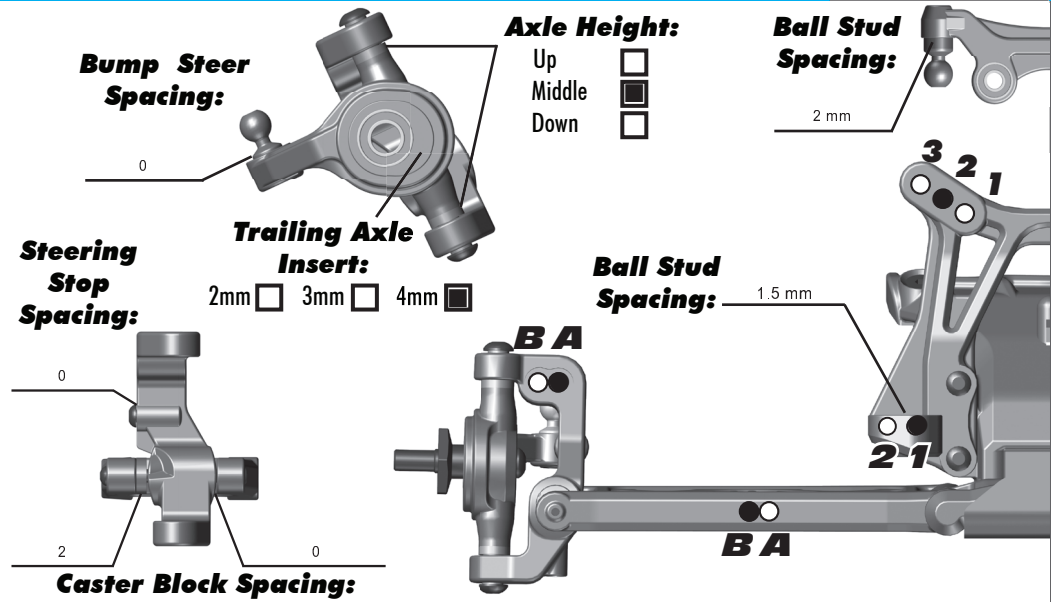

### Rear Suspension:

**Camber:** -1   
**Ride Height:** 24 mm  
**Wheel Hex:** #91410 Clamping Hex 7.0mm  
**Hub Spacing:** Forward  Middle  Back

**Notes:** #91412 Rear Arms, Standard  
 #91548 Factory Team 0° Aluminum Hubs (Back Row Inside + 3 mm)  
 #91520 Factory Team Aluminum Camber Link Mount (Low + 3 mm)  
 #91522 & #91524 Factory Team Aluminum Arm Mount (C) & (D)  
 #91518 Standard Rear Tower  
 #71019 HD Axle

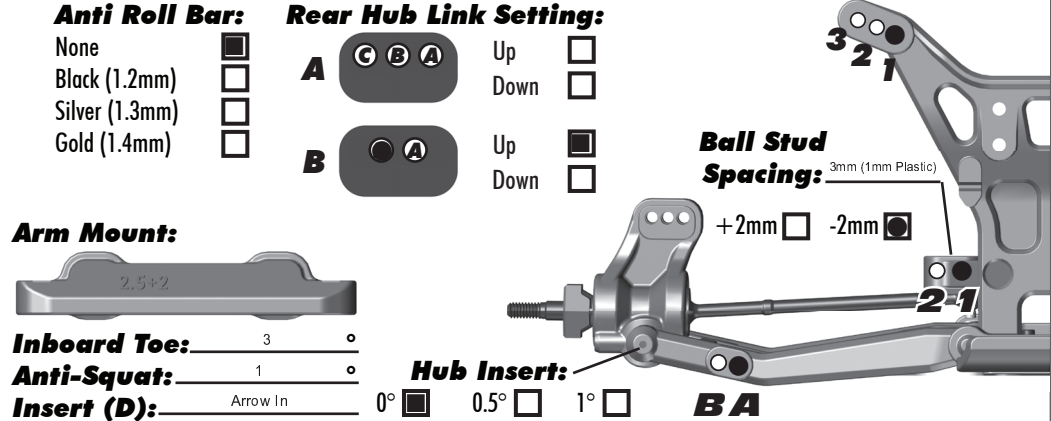

### Electronics:

**Radio:** Airtronics M12 **Servo:** Reedy 1206  
**EPA Throttle:** 100 % **Brake:** 92 %  
**ESC:** Reedy Blackbox 410R  
**ESC Settings:** See Brent Thielke Standard Setup Sheet  
**Motor:** Reedy Sonic Mach2  
**Wind:** 8.0 **Timing:** 20°  
**Pinion:** 22 **Spur:** 81  
**Battery:** Reedy Wolf Pack Shorty #738  
**Battery Position:** 2 Thin Back / 1 Thick Front

### Drivetrain:

**Differential:**  
**3 Gear:**  **4 Gear:**   
**Ball Diff:**  **Gear Diff:**   
**Notes:** Standard To Tight

**Slipper Clutch:**  
**Type:** #7485 Factory Team V2 Slipper Hubs  
**# of Pads:** 2  
**Notes:**

### Shocks:

	Front	Rear
<b>Piston:</b>	3 x 1.4 Flat	3 x 1.4 Tapered
<b>Oil:</b>	35 wt	32 wt
<b>Spring:</b>	X-Gear Gold	AE White
<b>Limiters:</b>	2	2
<b>Cup Offset:</b>	5 mm	5 mm
<b>Stroke:</b>	20.5 mm	27.0 mm
<b>Free Length:</b>	N/A	N/A
<b>Notes:</b>	#91493 X-Rings; #91450 Aluminum Caps	

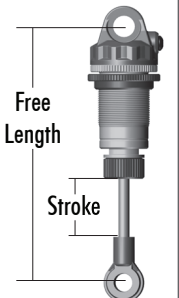

### Track Info:

**Size:** Small  Medium  Large  Extra Large   
**Surfaces:** Dirt  Carpet  Astroturf  Multi Surface   
**Traction:** Low  Medium  High  Very High   
**Moisture:** Dry  Damp  Wet   
**Condition:** Indoor  Outdoor  Dusty  Hard Packed   
 Bumpy  Grooved  Smooth  Loamy

**Temperature:** Ambient: 70° Track: 70°  
**Notes:** Dry and low dust for main event

### Tires:

**Tires (F/R):** JConcepts Dirt Webs / JConcepts Dirt Webs  
**Compound (F/R):** Gold / Gold  
**Insert (F/R):** Pro-Line Closed Cell / AKA Closed Cell  
**Wheel (F/R):** Team Associated Hex 2.2 / Team Associated Hex 2.2  
**Notes:** Broken-in to 1/3 pin height

### Body, Wing & Chassis:

**Body:** Team Associated Kit  
**Wing:** JConcepts High Clearance 6.5" (Pre-Cut)  
**Wing Angle:** 0°  3°  6°  Wing Lip Cut To 2 Lines  
**Chassis:** #91510 - B5M  #91511 - B5M Lite

### Race Results:

**Qualify:** 3 **Main:** A  
**Finish:** 2 **TQ:**   
**Best Lap Time:** 19.2

### Vehicle Comments:

#91551 Factory Team Bearing Set; #91545 Factory Team Graphite Battery Strap; #91446 Factory Team Shock Bushings; #91547 Factory Team Milled Motor Plate; #91600 Factory Team Titanium Screw Kit;  
**Total Vehicle Weight:** 1565g