

**:: Driver:** Steven Hartson **:: Date:** 04/15/12  
**:: Track:** Mike's Hobby Shop  
**:: Event:** JConcepts Spring Indoor Nationals

## Setup Sheet for Team Associated's B4.1

Reset Forms

Rev. 2

### :: Front End

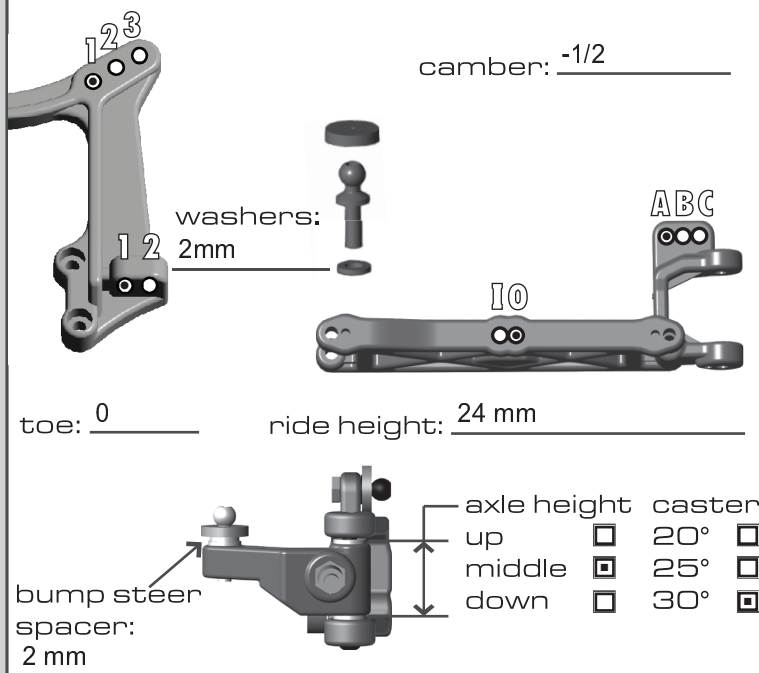

### :: Rear End

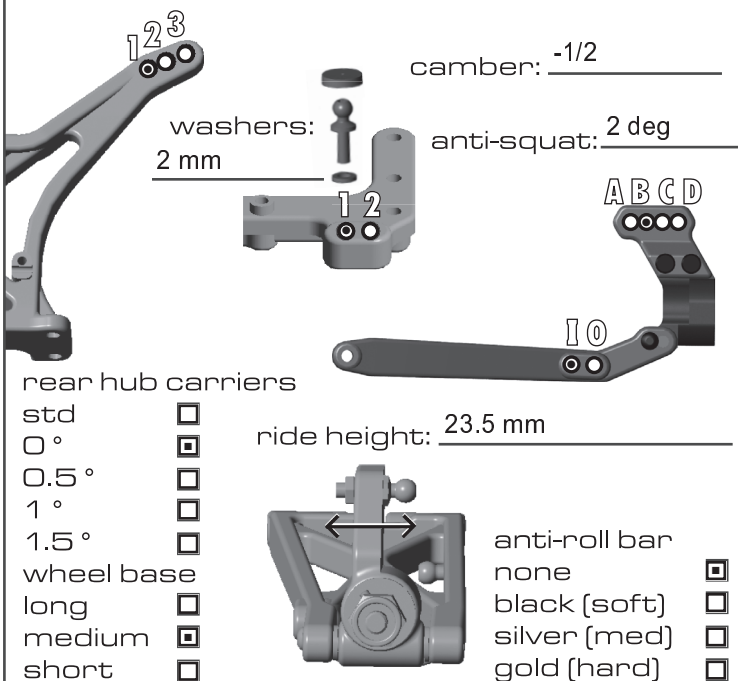

### :: Front Shocks

spring: Brown piston: #2  
 shock oil: 30 wt limiter: 3

### :: Rear Shocks

spring: Green piston: #2  
 shock oil: 27.5 wt limiter: 2

### :: Electronics

motor & wind: LRP X12 8.5 (12.0 rotor)  
 pinion: 23  
 spur gear: 81  
 batteries: Reedy #306 Shorty  
 battery placement: 1 1/2 Pads In The Rear

radio: Futaba 4PKS  
 throttle / brake epa: 100% / 84%  
 throttle / brake expo: 0% 0%  
 esc: LRP SXX V2 (3.0 Software) throttle profile: 1/0/0/5  
 initial brake: - drag brake: -  
 servo: XP 1015 steering expo: 0%

### :: Other

body: JConcepts Finisher wing: JConcepts High Clearance  
 notes: Wing cut to 2 lines

### :: Differential

gear differential ☐ fluid: ☐  
 ball differential ☒

### :: Front Tires

tire: JConcepts Barcodes  
 compound: Green  
 insert: Stock rear foam cut to width  
 wheel: JConcepts Hex

### :: Rear Tires

tire: JConcepts Barcodes v1  
 compound: Green  
 insert: JConcepts Closed Cell 3206-2  
 wheel: JConcepts Hex

### :: Race and Vehicle Comments

qualify: 1 main: A finish: 1 tq: ☒  
 comments: Rear ballast weight; 1/2 oz behind servo; All carbon parts; 12mm  
 Associated prototype shocks; Avid steering rack; "A" rear hub towers

### :: Track Info

smooth: ☒ bumpy: ☐ blue groove: ☐  
 traction: high: ☐ med: ☒ low: ☐  
 soft dirt: ☐ grass: ☐ clay: ☒ wet: ☐  
 dusty: ☐ other: ☐