

WILDFIRE DOB

1/10 4WD ELECTRIC COMPETITION TOURING CAR KIT

SETUP SHEET

Arr0

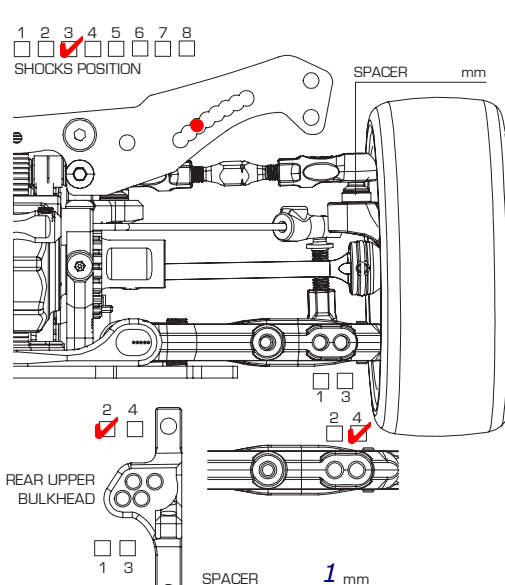
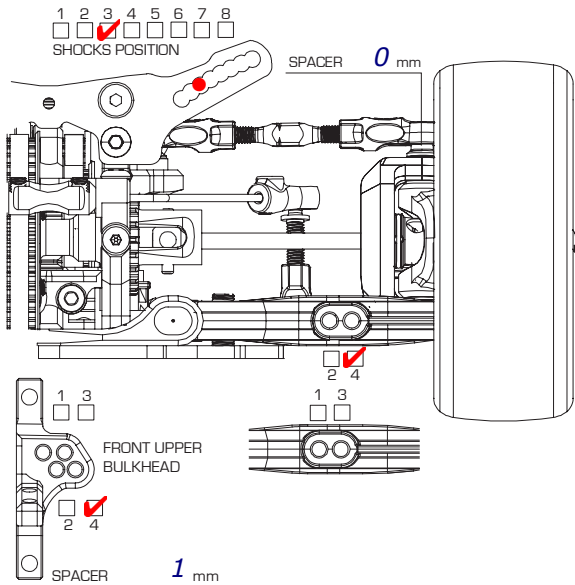

COMPOSITES

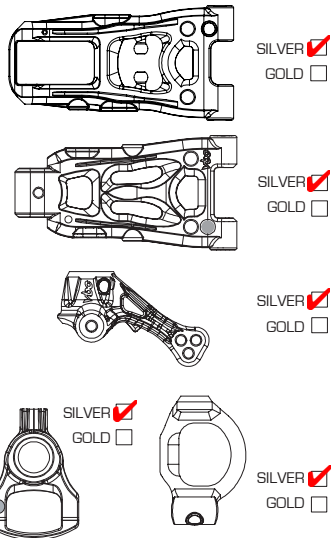

FRONT

GROUND CLEARANCE	<i>5.2</i> mm	DROOP	<i>5.5</i> mm
CAMBER ANGLE	<i>1,75</i> °	TOE ANGLE	<i>1</i> °
CASTER ANGLE	<i>4</i> °	FRONT DRIVE DIFF (OIL)	<i>1/DIRECT</i> <input checked="" type="checkbox"/>
STABILIZER	1.2 <input checked="" type="checkbox"/> 1.4	WHEEL SPACER	<i>0</i> mm
SUSPENSION SHIM (FF)	<i>0</i> mm	SUSPENSION SHIM (FR)	<i>0</i> mm
SUSPENSION MOUNT (FF)	<i>4</i>	SUSPENSION MOUNT (FR)	<i>2</i>
AXLE TYPE / SIZE	TWO-PIECE JOINT / SINGLE JOINT (STEEL/ALUM)		<i>52</i> mm

REAR

GROUND CLEARANCE	<i>5.4</i> mm	DROOP	<i>1</i> mm
CAMBER ANGLE	<i>1.75</i> °	TOE ANGLE	<i>2.5</i> °
REAR DRIVE	DIFF (OIL <i>8.5K</i>)	DRIVE CUP	ALU <input checked="" type="checkbox"/> / STEEL
STABILIZER	1.2 <input checked="" type="checkbox"/> 1.4	WHEEL SPACER	<i>0</i> mm
SUSPENSION SHIM (FF)	<i>0</i> mm	SUSPENSION SHIM (FR)	<i>0</i> mm
SUSPENSION MOUNT (FF)	<i>2</i>	SUSPENSION MOUNT (FR)	<i>4</i>
AXLE TYPE / SIZE	TWO-PIECE JOINT / SINGLE JOINT (STEEL/ALUM)		<i>49</i> mm

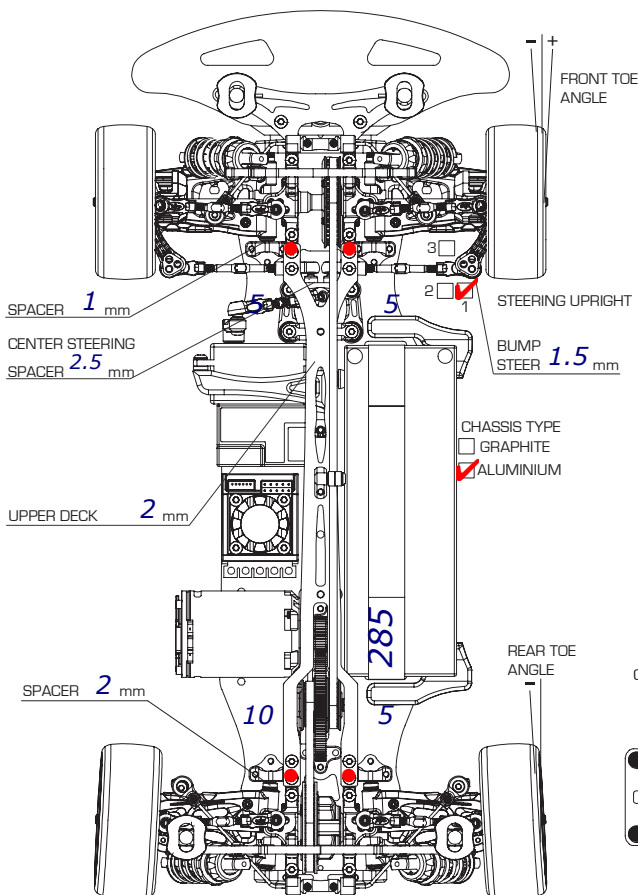

FRONT

SHOCK LENGTH *9* mm

PISTON 3 hole(s) / OTHERS _____

OIL *450*

SPRING *Xray 2.6*

OIL SEALER CAP S / MS / / H

REBOUND *20* %

NOTES *LCG Shocks*



REAR

SHOCK LENGTH *9* mm

PISTON 3 hole(s) / OTHERS _____

OIL *450*

SPRING *2.7*

OIL SEALER CAP S / MS / / H

REBOUND *20* %

NOTES *LCG Shocks*

MOTOR	<i>5.0</i>	SPUR	<i>116 T</i>	PITCH	<i>64</i>	PINION	<i>29</i> T
TIRE	<i>Handout</i>	TIRE INSERT	WHEEL _____				
TIRE ADDITIVE	<i>Spider Grip</i>	BODY	<i>LTC-R</i>	REAR WING	<i>PF Hard Std</i>		
ESC	<i>Fleta Pro</i>	BATTERY	<i>MuchMore 6000</i>				
REMARKS	<i>Additive 10 minutes, 10 gram Bumper</i>						

Chassis Flex Setting (Fill in the Circle)

