

WILDFIRE 008

1/10 4WD ELECTRIC COMPETITION TOURING CAR KIT

SETUP SHEET

Arr0

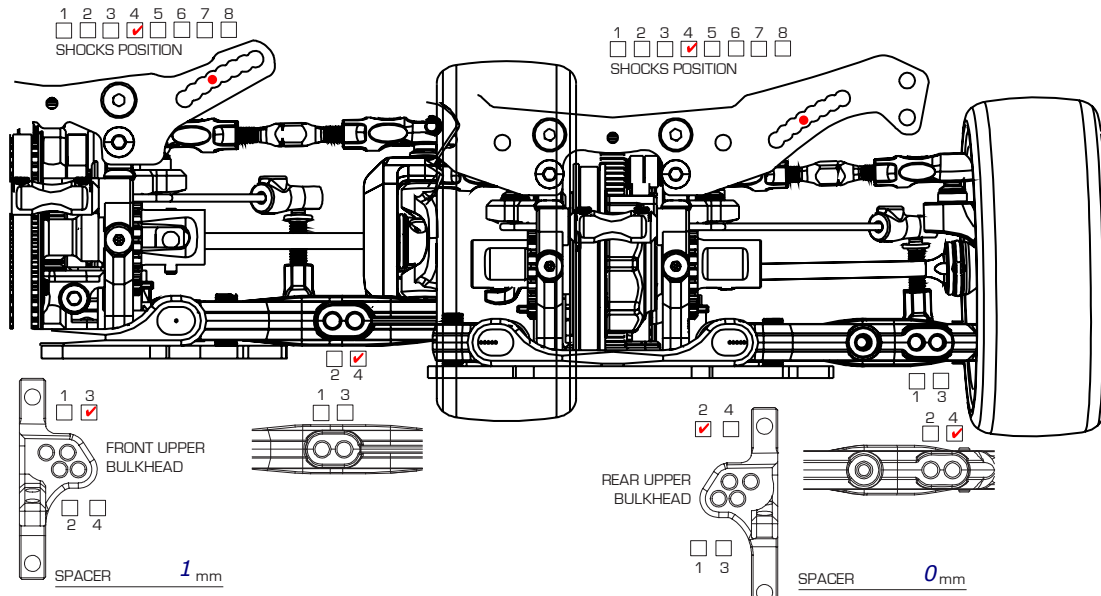

COMPOSITES

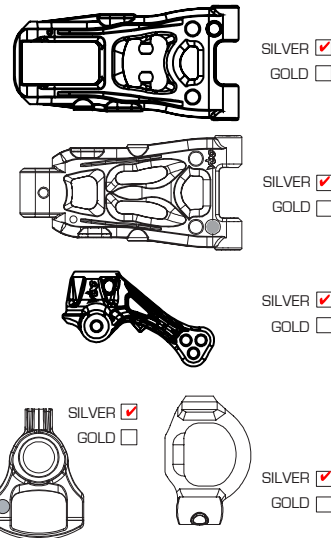

FRONT

GROUND CLEARANCE	<i>5.2</i> mm	DROOP	<i>5.4</i> mm
CAMBER ANGLE	<i>1.5</i> °	TOE ANGLE	<i>1</i> °
CASTER ANGLE	°	FRONT DRIVE DIFF (OIL)	<i>1</i> / DIRECT
STABILIZER	1.2 <i>1.3</i> 1.4	WHEEL SPACER	mm
SUSPENSION SHIM (FF)	<i>0</i> mm	SUSPENSION SHIM (FR)	<i>0</i> mm
SUSPENSION MOUNT (FF)	<i>1 dot</i>	SUSPENSION MOUNT (FR)	<i>3 dot in</i>
AXLE TYPE / SIZE	TWO-PIECE JOINT / SINGLE JOINT (STEEL/ALUM) mm		

REAR

GROUND CLEARANCE	<i>5.4</i> mm	DROOP	<i>0.5</i> mm
CAMBER ANGLE	<i>2</i> °	TOE ANGLE	<i>3</i> °
REAR DRIVE	DIFF (OIL <i>2000</i>)	DRIVE CUP	ALUMINIUM / STEEL
STABILIZER	1.2 <i>1.3</i> 1.4	WHEEL SPACER	mm
SUSPENSION SHIM (FF)	<i>0</i> mm	SUSPENSION SHIM (FR)	<i>0</i> mm
SUSPENSION MOUNT (FF)	<i>1 dot</i>	SUSPENSION MOUNT (FR)	<i>5 dot</i>
AXLE TYPE / SIZE	TWO-PIECE JOINT / SINGLE JOINT (STEEL/ALUM) mm		

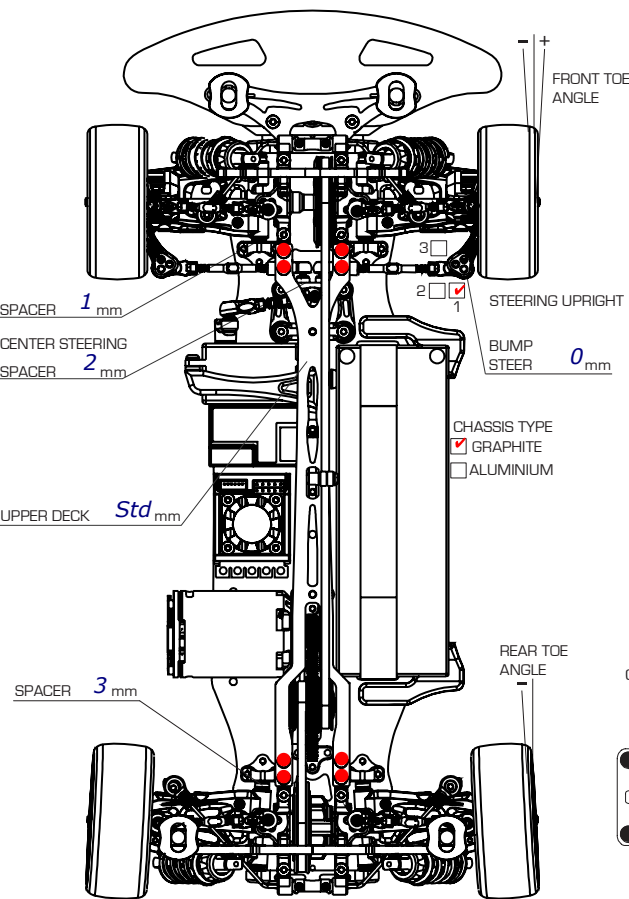

FRONT

SHOCK LENGTH	<i>59</i> mm
PISTON	<input checked="" type="checkbox"/> 4 hole(s) / OTHERS
OIL	<i>Fast race 350</i>
SPRING	<i>Jsb 3.0</i>
OIL SEALER CAP	S / MS / <i>M</i> / H
REBOUND	<i>25</i> %
NOTES	



REAR

SHOCK LENGTH	<i>59</i> mm
PISTON	<input checked="" type="checkbox"/> 4 hole(s) / OTHERS
OIL	<i>Fast race 350</i>
SPRING	<i>Jsb 3.0</i>
OIL SEALER CAP	S / MS / <i>M</i> / H
REBOUND	<i>25</i> %
NOTES	

MOTOR	<i>Lrp x20 13.5 t</i>	SPUR	<i>100 T</i>	PITCH	<i>65</i>	PINION	<i>40</i> T
TIRE	<i>Lrp g32</i>	TIRE INSERT		WHEEL			
TIRE ADDITIVE		BODY	<i>Mt nazda 3</i>	REAR WING	<i>Mt rigid wing</i>		
ESC	<i>Lrp competition</i>	BATTERY	<i>Lrp 5800 stock spec</i>				
REMARKS							

Chassis Flex Setting (Fill in the Circle)

