

# WILDFIRE DO6

1/10 4WD ELECTRIC COMPETITION TOURING CAR KIT

## SETUP SHEET



DRIVER **Sandro Kuriger** DATE **14.-18.10.2014**

TRACK NAME **IIC Las Vegas 17.5** RESULT

COMPOSITION (IN  OR/OUTDOOR) BEST LAP **11.599**

HUMIDITY TRACK TEMP

GRIP  MEDIUM  SURFACE  SMOOTH  BUMPY

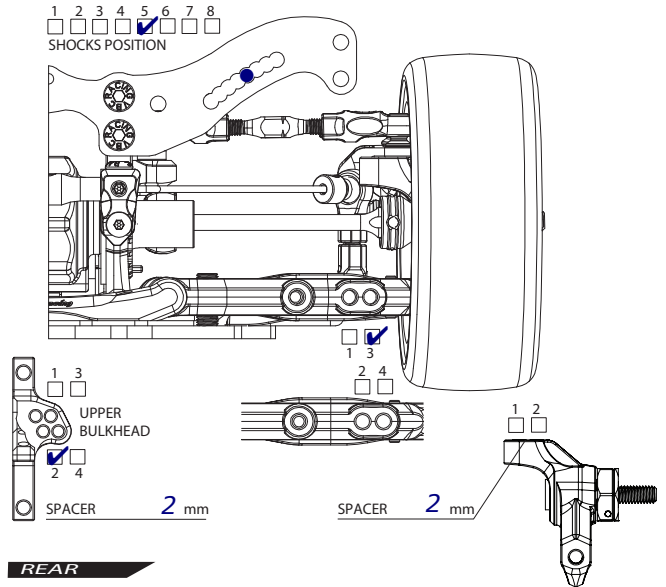
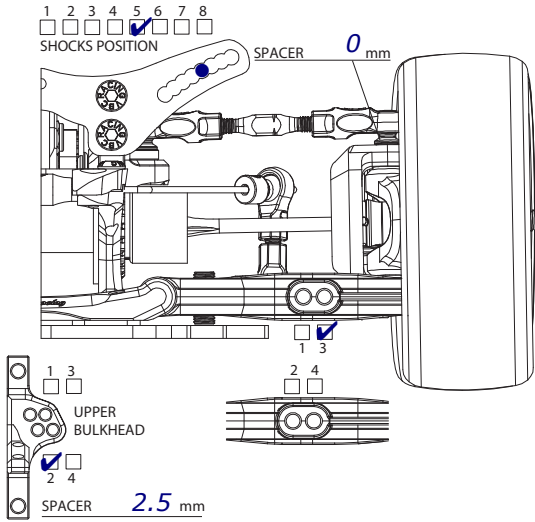

### FRONT

GROUND CLEARANCE	5 mm	DROOP	5.8
CAMBER ANGLE	1.5 °	TOE ANGLE	1 °
CASTER BLOCK	4 °	FRONT DRIVE	DIFF (OIL) ) / DIRECT <input checked="" type="checkbox"/>
STABILIZER	1.2 <input checked="" type="checkbox"/>	1.4	WHEEL SPACER 0.5 mm
SUSPENSION SHIM (FF)	0.5 mm	SUSPENSION SHIM (FR)	1 mm
SUSPENSION MOUNT (FF)	F10	SUSPENSION MOUNT (FR)	C05
WHEELBASE	FRONT 3	REAR 1	BELT TENSION
AXLE TYPE / SIZE	TWO PIECE JOINT / SINGLE JOINT (STEEL/ALUM) mm		

### REAR

GROUND CLEARANCE	5.25 mm	DROOP	4.8
CAMBER ANGLE	2 °	TOE ANGLE	3 °
REAR DRIVE	DIFF (OIL 3000 )	DRIVE CUP	ALUMINUM/STEEL <input checked="" type="checkbox"/>
STABILIZER	1.2 <input checked="" type="checkbox"/>	1.4	WHEEL SPACER 0 mm
SUSPENSION SHIM (RF)	0.5 mm	SUSPENSION SHIM (RR)	0.5 mm
SUSPENSION MOUNT (RF)	C0	SUSPENSION MOUNT (RR)	E30
WHEELBASE	FRONT 3	REAR 1	BELT TENSION
AXLE TYPE / SIZE	TWO PIECE JOINT / SINGLE JOINT (STEEL/ALUM) 49 mm		

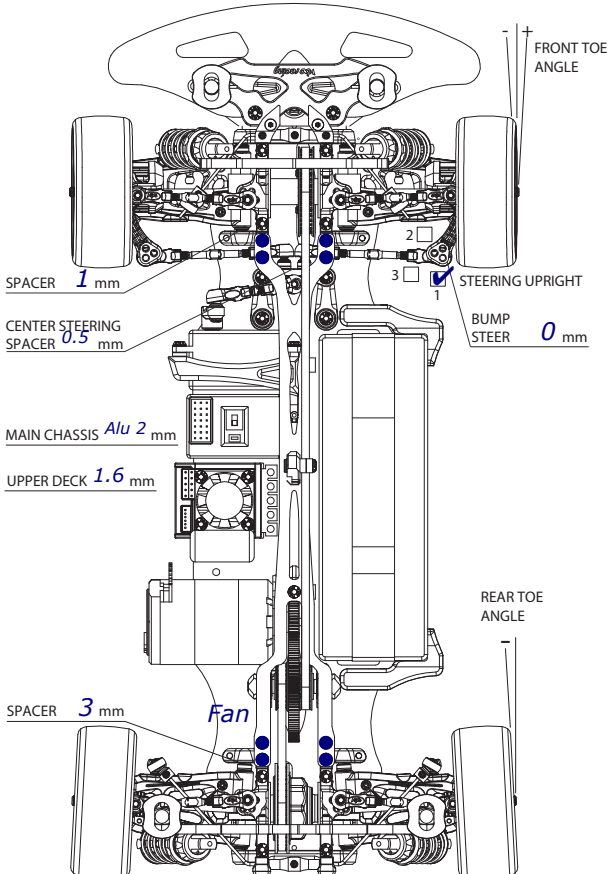

### FRONT

SHOCK LENGTH	60 mm
PISTON	3 <input checked="" type="checkbox"/> holes / OTHERS
OIL	450 WRP
SPRING	Ride blue
OIL SEALER CAP	S / <input checked="" type="checkbox"/> / M / H
REBOUND	0 %
NOTES	Hole in Cap

### REAR

SHOCK LENGTH	60 mm
PISTON	3 <input checked="" type="checkbox"/> holes / OTHERS
OIL	550 WRP
SPRING	Ride Grey
OIL SEALER CAP	S / <input checked="" type="checkbox"/> / M / H
REBOUND	0 %
NOTES	Hole in Cap



MOTOR	R1 wurks 17.5	SPUR	98 T	PINION	T	PITCH	64
TIRE	Gravity Hand Out	TIRE INSERT		WHEEL			
TIRE ADDITIVE	SXT	TIME	5 min	TIRE WARMER			
ESC	Muchmore FLETA Pro	ESC SETTING	Blinky				
BATTERY	skConcept 6000	BODY	PF Speed 6	REAR WING	MR33 with Cutout		

### REMARKS

Additive rear full, front half, Glue on Sidewall front  
 Alum Spoolshaft, Hard Spooloutdrives