

WILDFIRE DOB

1/10 4WD ELECTRIC COMPETITION TOURING CAR KIT



DRIVER Delisé Nicolas DATE 05/01/2014
 TRACK NAME Modelifun RESULT 2nd
 COMPOSITION Carpet (INDOOR/OUTDOOR) BEST LAP 13.195
 HUMIDITY _____ TRACK TEMP _____
 GRIP HI MEDIUM LOW SURFACE SMOOTH BUMPY

SETUP SHEET

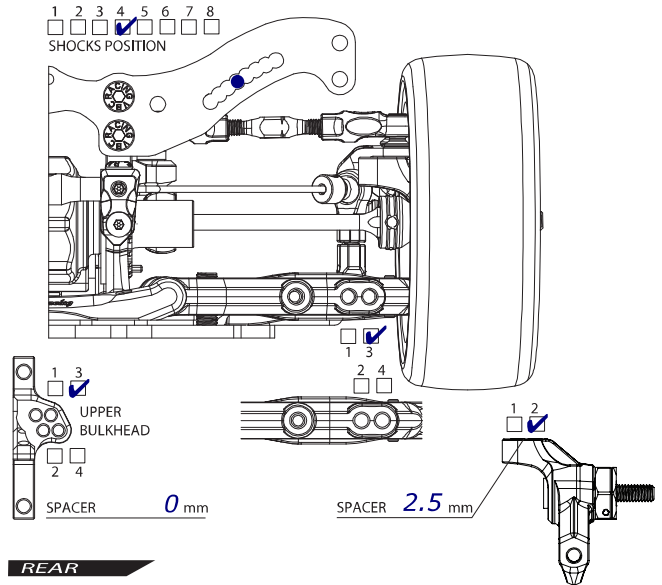
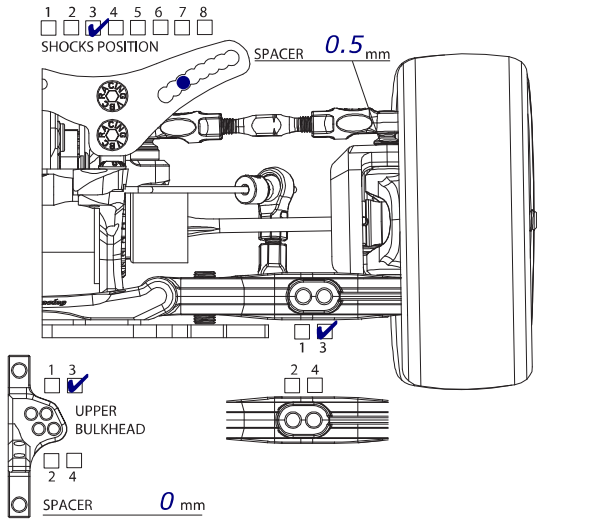

FRONT

GROUND CLEARANCE 5 mm DROOP 6
 CAMBER ANGLE 1.5° TOE ANGLE 2°
 CASTER BLOCK 4° FRONT DRIVE DIFF (OIL) / DIRECT
 STABILIZER 1.2 1.4 WHEEL SPACER 0 mm
 SUSPENSION SHIM (FF) 1 mm SUSPENSION SHIM (FR) 1 mm
 SUSPENSION MOUNT (FF) f00 SUSPENSION MOUNT (FR) -C10
 WHEELBASE FRONT REAR 1 BELT TENSION _____
 AXLE TYPE / SIZE TWO PIECE JOINT / SINGLE JOINT (STEEL/ALUM) _____ mm

REAR

GROUND CLEARANCE 5.4 mm DROOP 1.5
 CAMBER ANGLE 1.5° TOE ANGLE 3.5°
 REAR DRIVE DIFF (OIL 2000) DRIVE CUP ALUMINUM/STEEL
 STABILIZER 1.3 1.4 WHEEL SPACER 0 mm
 SUSPENSION SHIM (RF) 1 mm SUSPENSION SHIM (RR) 1 mm
 SUSPENSION MOUNT (RF) C15 SUSPENSION MOUNT (RR) e20
 WHEELBASE FRONT 2 REAR 2 BELT TENSION _____
 AXLE TYPE / SIZE TWO PIECE JOINT / SINGLE JOINT (STEEL/ALUM) _____ mm

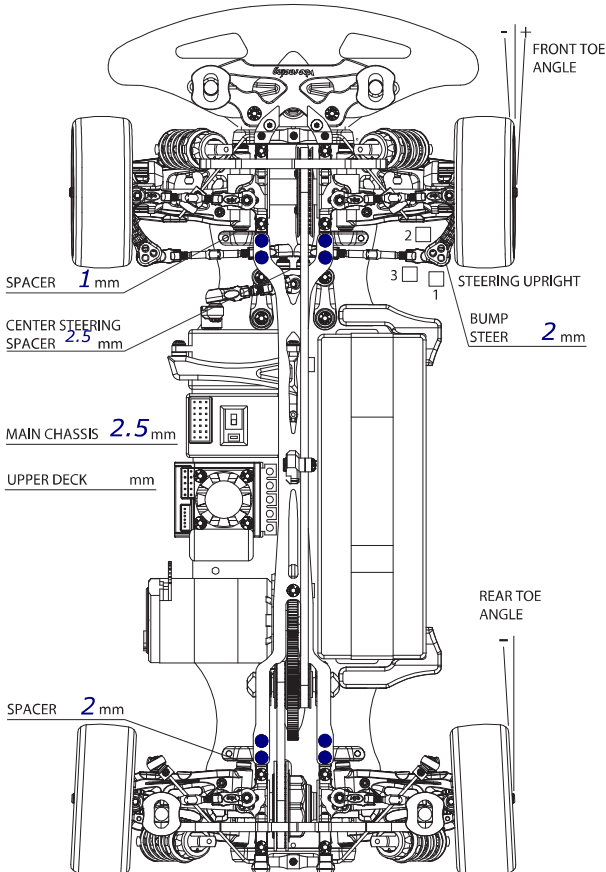

FRONT

SHOCK LENGTH _____ mm
 PISTON 4 holes / OTHERS _____
 OIL 350
 SPRING Orange
 OIL SEALER CAP S / MS / M / H _____
 REBOUND 20%
 NOTES _____

REAR

SHOCK LENGTH _____ mm
 PISTON 4 holes / OTHERS _____
 OIL 350
 SPRING Red
 OIL SEALER CAP S / MS / M / H _____
 REBOUND 20%
 NOTES _____

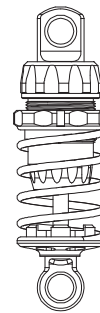

MOTOR HW 5.5T SPUR 116 T PINION 21 T PITCH 64
 TIRE Ride REX30 TIRE INSERT _____ WHEEL _____
 TIRE ADDICTIVE ETS TIME 20min TIRE WARMER _____
 ESC HW V3.1 ESC SETTING _____
 BATTERY _____ BODY Mazda Speed LW REAR WING _____
 REMARKS _____