

WILDFIRE

1/10 4WD ELECTRIC COMPETITION TOURING CAR KIT



DRIVER Patrick Poon DATE 24 Feb 2013
 TRACK NAME TITC 2013, RC Addict RESULT _____
 TRACK SURFACE Asphalt GRIP CONDITION HI MED LOW
 HUMIDITY _____ TRACK TEMP 65C

SETUP SHEET

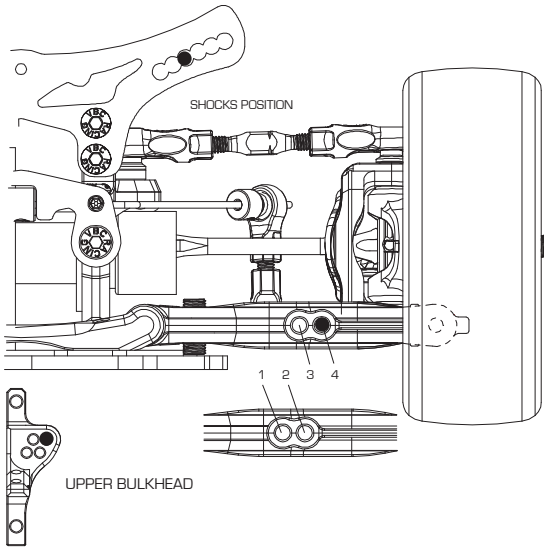

FRONT

GROUND CLEARANCE	<u>5</u> mm	REBOUND	<u>0%</u>
CAMBER ANGLE	<u>-1.5</u> °	TOE ANGLE	<u>-1</u> °
CASTER BLOCK	°	FRONT DRIVE DIFF (OIL)	<u>DIRECT</u>
STABILIZER	1.2 1.3 1.4	WHEEL SPACER	<u>0</u> mm
FRONT SUSPENSION MOUNT SHIM	<u>1</u> mm	REAR SUSPENSION MOUNT SHIM	<u>1</u> mm
FRONT SUSPENSION MOUNT	<u>F0</u>	REAR SUSPENSION MOUNT	<u>C0</u>
DOWNSTOP	<u>5</u> mm		

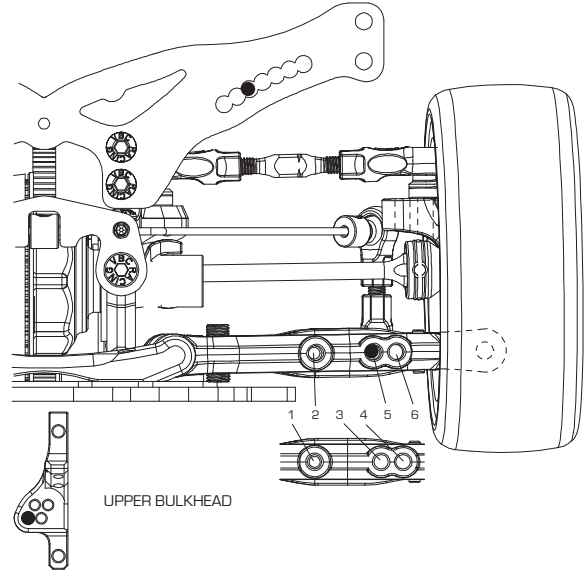

REAR

GROUND CLEARANCE	<u>5.5</u> mm	REBOUND	<u>0%</u>
CAMBER ANGLE	<u>-1.5</u> °	TOE ANGLE	<u>2</u> °
		FRONT DRIVE DIFF (OIL)	<u>7000cst</u>
STABILIZER	1.2 <u>1.3</u> 1.4	WHEEL SPACER	<u>0</u> mm
FRONT SUSPENSION MOUNT SHIM	<u>1</u> mm	REAR SUSPENSION MOUNT SHIM	<u>1</u> mm
FRONT SUSPENSION MOUNT	<u>Y05 X05</u>	REAR SUSPENSION MOUNT	<u>E25</u>
DOWNSTOP	<u>5</u> mm		

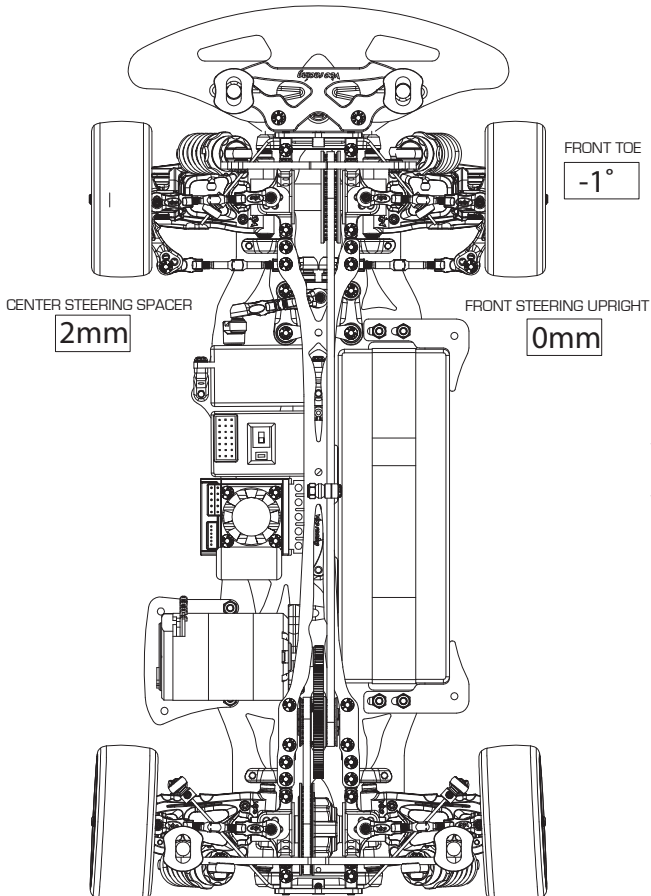

FRONT

SHOCK LENGTH	<u>64mm</u>
PISTON	1 2 <u>3</u> hole(s)
OIL	<u>300</u>
SPRING	<u>VBC Green</u>



REAR

SHOCK LENGTH	<u>64mm</u>
PISTON	1 2 <u>3</u> hole(s)
OIL	<u>300</u>
SPRING	<u>VBC Green</u>

MOTOR	<u>4.5T Team Silverback</u>	SPUR	<u>116T 64P</u>	PINION	<u>27</u>
TIRE	<u>Ride 26027 REX34</u>	TIRE INSERT		WHEEL	
TIRE ADDITIVE	<u>LRP Carpet</u>	BODY	<u>LTC-R</u>	BATTERY	<u>Silverback</u>
REMARKS	<u>TITC 2013 Modified Class</u>				
