

# LIGHTNING12

1/12 SCALE ELECTRIC COMPETITION CAR KIT

## SETUP SHEET

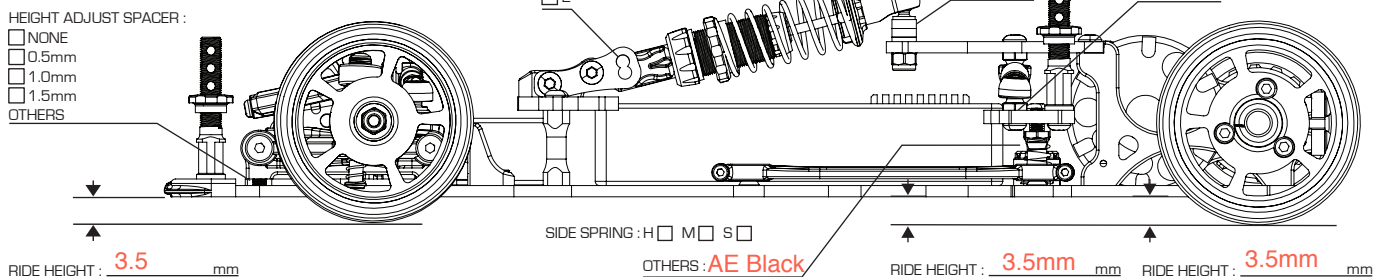
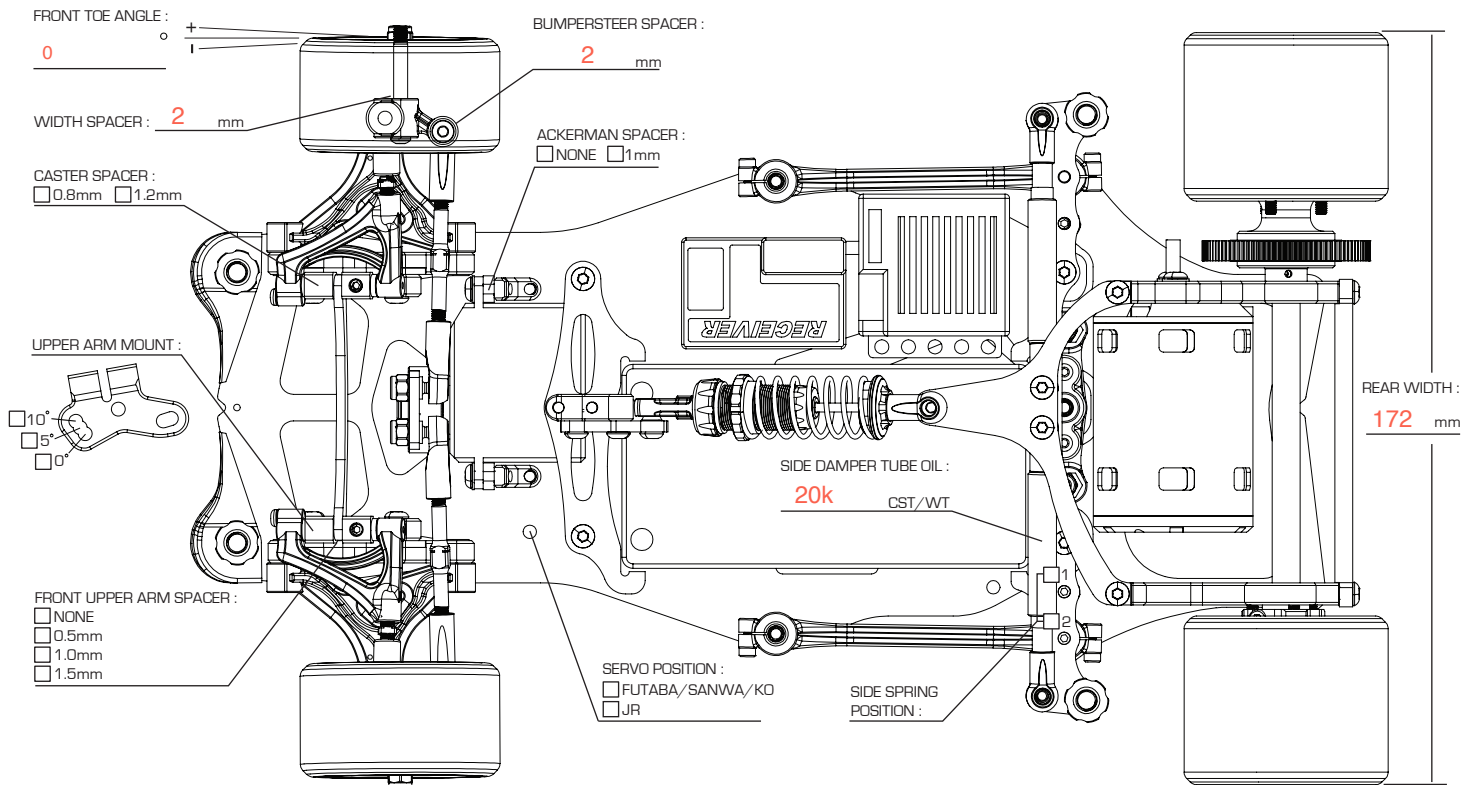

### FRONT

CAMBER ANGLE: **-0.5**

SPACER: **0** mm

FRONT SPRING: H  M  S  OTHERS: **AE .20**

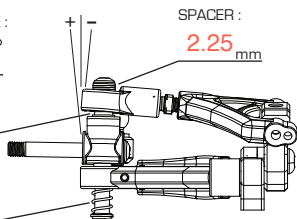

### TBX SHOCK



SHOCK LENGTH: **73mm** mm

### REAR AXLE

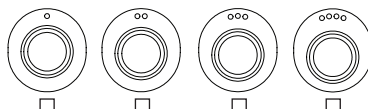
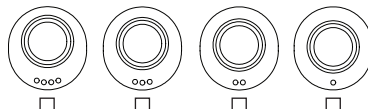

PISTON: 2  3  HOLE(S) / OTHERS

OIL: **400 cst** CST/WT

SPRING: H  M  S  / OTHERS

REBOUND: **50** %

AXLE SHIMS: mm

MOTOR: **Reedy 3.5**

ROTOR: **Standard**

TIMING:

SPUR:

PITCH/

T PINION:

PITCH/

T ROLLOUT:

ESC: **LRP Flow**

SETUP:

BATTERY: **Silverback**

STEERING EXPD: **0**

BRAKE E.P.: **0**

THROTTLE EXPD: **0**

BODY: **Protoform AMR**

WEIGHT: **747g**

REMARKS: **Easy to drive, slight understeer**

### FRONT TIRES

TIRE: **Jaco Pink**

DIAMETER: **39.5** mm

WHEEL: **Jaco**

TIRE TREATMENT: **Jack**

TREATMENT TIME: **15min**

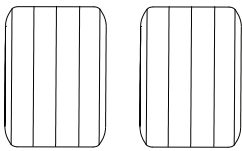

SURFACE TREATED: **1/3 inside**

NOTES:

### REAR TIRES

TIRE: **Jaco Pink**

DIAMETER: **41.5** mm

WHEEL: **Jaco**

TIRE TREATMENT: **Jack**

TREATMENT TIME: **15min**

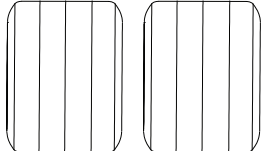

SURFACE TREATED: **Full**

NOTES: