

1

Gear Differential Assembly

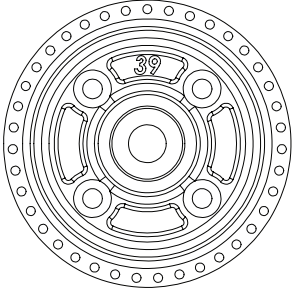

Gear Diff Housing A-03-VBC-2005 x 1

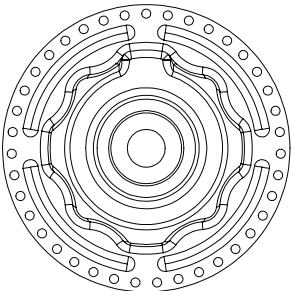

Gear Diff Pulley 39T A-03-VBC-2006 x 1

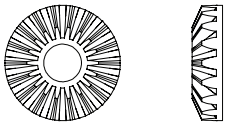

Diff Gear 18T A-03-VBC-0019 x 2

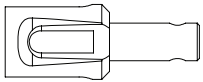

Lightweight Hardened Gear Diff Cup B-02-VBC-0099 x 2

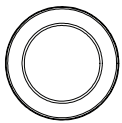

10x15 Ball Bearing C-02-BB-1510-B x 2

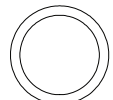

10x13x0.2mm Shim x 4



15x0.3 Shim B-02-VBC-0077 x 2



M2x10 Shaft Pin B-02-VBC-0020 x 2



Diff Shaft Sealer O-Ring B-03-VBC-0006 x 2

Differential Left Side

Apply small amount of diff oil

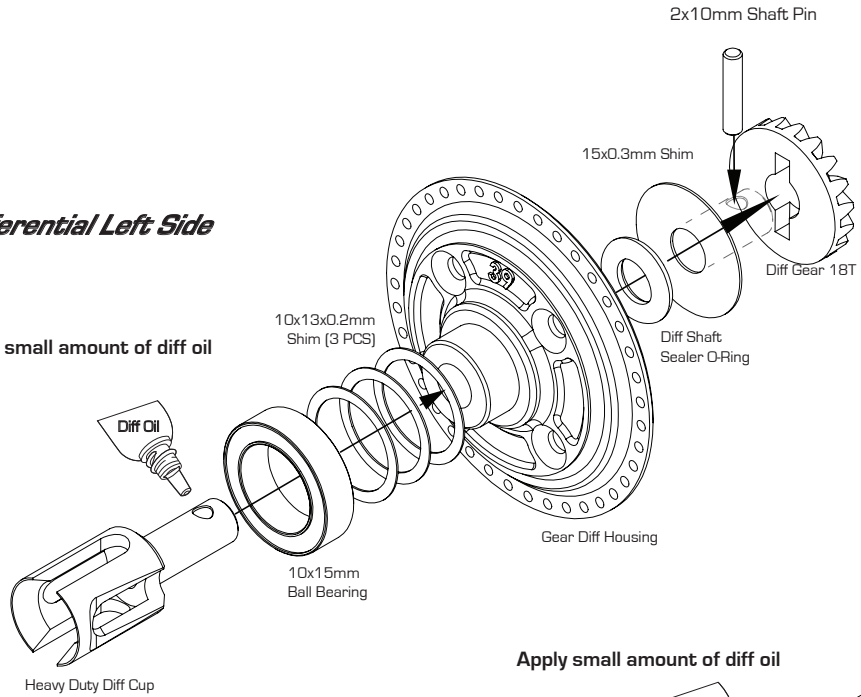

Differential Right Side

Apply small amount of diff oil

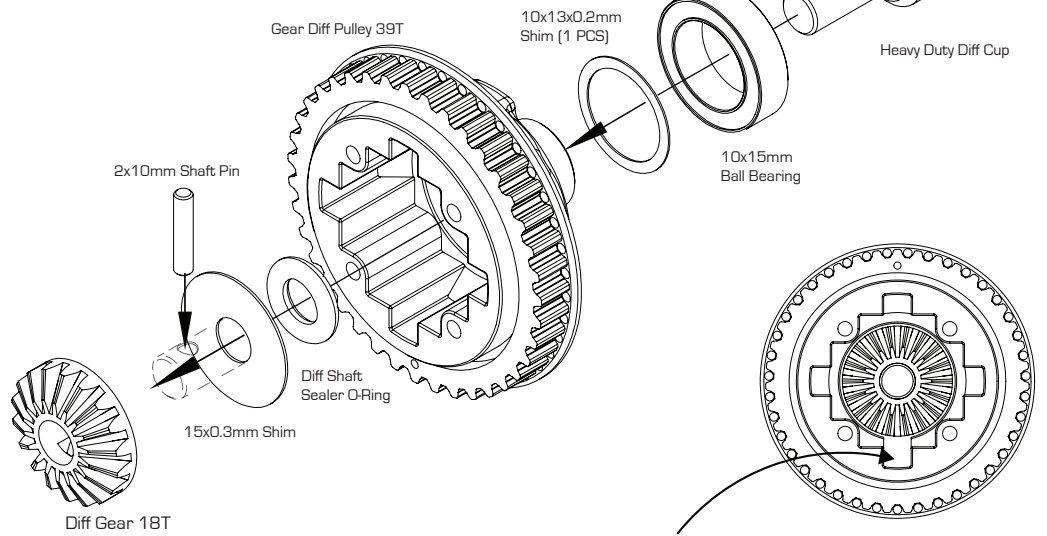

NOTICE : Insert 2x10mm Shaft Pin Direction

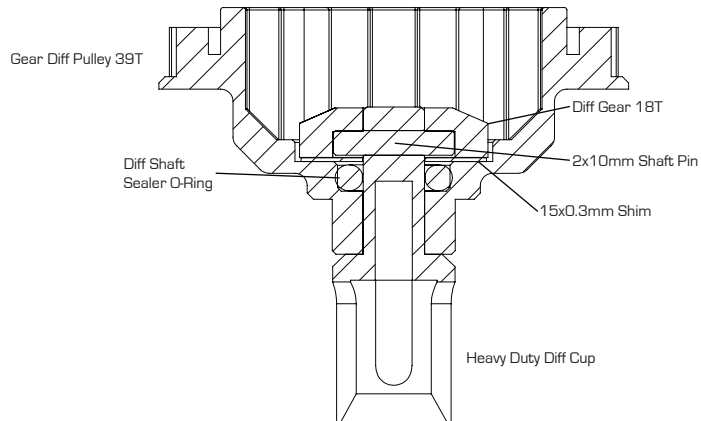

Differential Left Side Assembly Cross Section

2

Gear Diff Assembly Continue

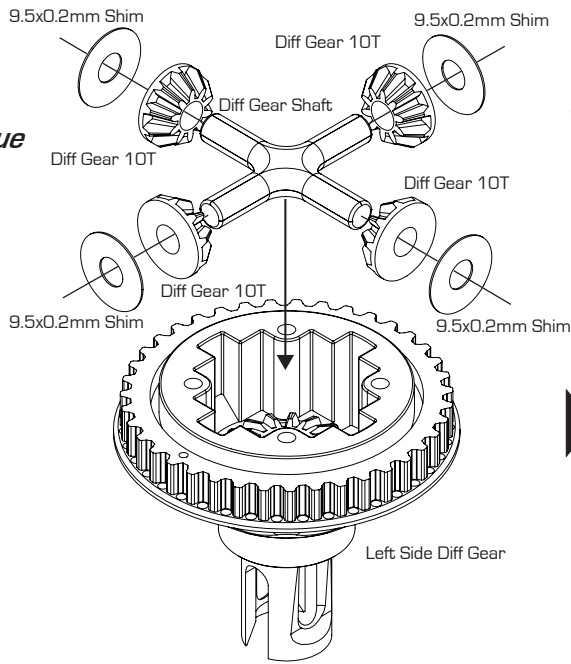
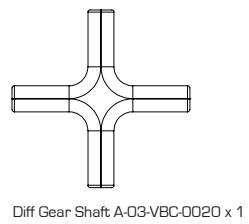
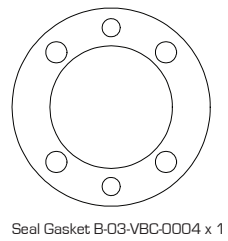
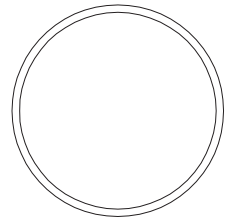
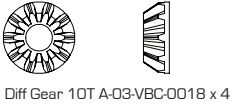

Fill with supplied gear diff oil until the gear diff are fully submerged

Diff Housing Sealer O-Ring put inside the gap

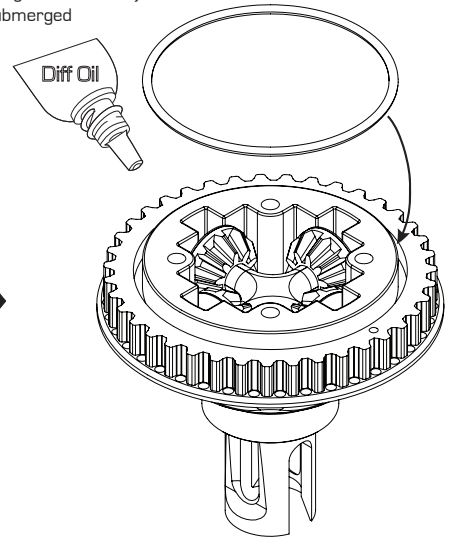

COMPLETED ASSEMBLY GEAR DIFF

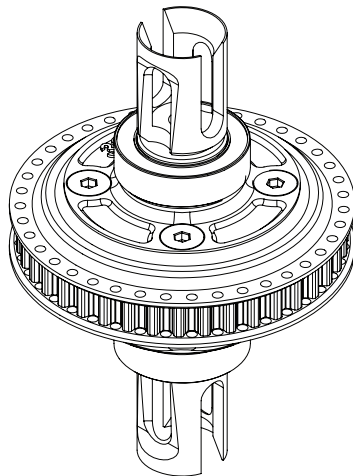

M2.6x10mm Flathead Screw

