

PHOTON SETUP RECORD

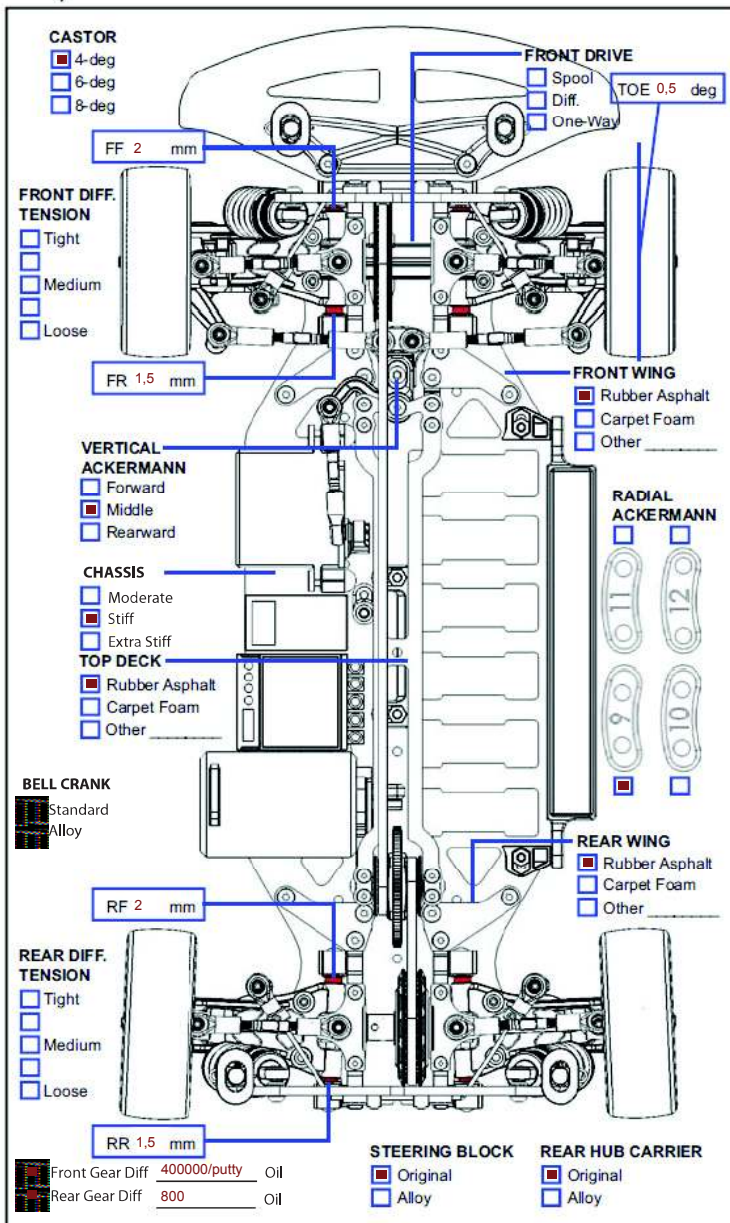

Name: Michael Spiering Date: 10.07.2011 Track: ETS Andernach

Condition: medium/high Grip Temperature: 25 Asphalt Carpet



MARK POSITION

1.0mm 2 holes 1.2mm 2 holes
 1.0mm 3 holes 1.2mm 3 holes

FRONT MEASUREMENTS		FRONT SHOCKS	
RIDE HEIGHT	4,8 mm	OIL WEIGHT	Corally 65 wt
CAMBER ANGLE	2 deg	PISTON	Standard/Optimal <input checked="" type="checkbox"/>
DROOP	1,5 mm	BLADDER	std
WHEEL HUBS	std mm	SPRING	306
WHEEL SPACER	0 mm	NOTE	1mm hole in cap 0 rebound

MARK POSITION

1.0mm 2 holes 1.2mm 2 holes
 1.0mm 3 holes 1.2mm 3 holes

REAR MEASUREMENTS		REAR SHOCKS	
RIDE HEIGHT	5,2 mm	OIL WEIGHT	Corally 65 wt
CAMBER ANGLE	2,5 deg	PISTON	Standard/Optimal <input checked="" type="checkbox"/>
DROOP	7 mm	BLADDER	std
WHEEL HUBS	std mm	SPRING	306
WHEEL SPACER	0 mm	NOTE	1mm hole in Cap 0 rebound

MOTOR	SP 13,5		FRONT	REAR
SPUR GEAR	70		BRAND	Ride 36 Ride 36
PINION GEAR	35		COMPOUND	handout handout
BATTERY	GM 6200 60C		INSERT	handout handout
BODY SHELLS	Mazda Speed 6 Light		WHEEL	handout handout
WING	std		TIRE TREATMENT	MuchMore MuchMore
ESC SETTING	no settings			

FL FR RL RR

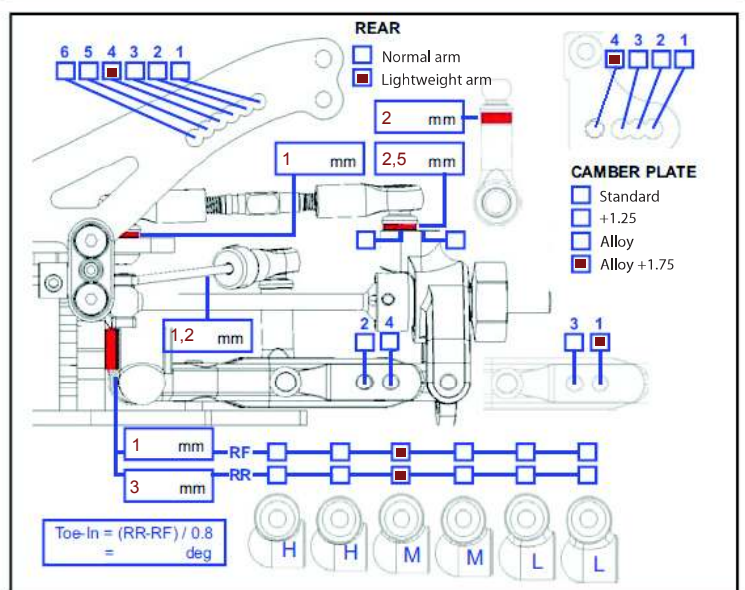
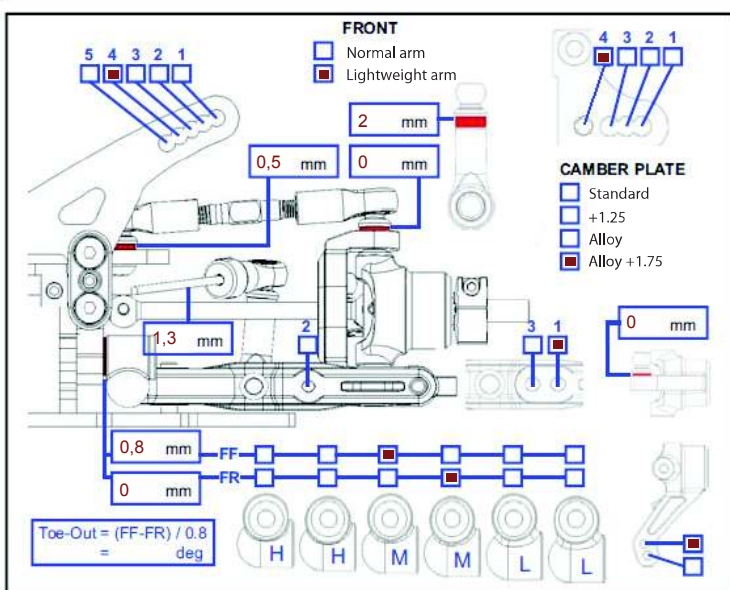

Photon Editable Setup Sheet V2 by Claudio Cantoni & FRAMEGA info@framega.com

