

# PHOTON SETUP RECORD

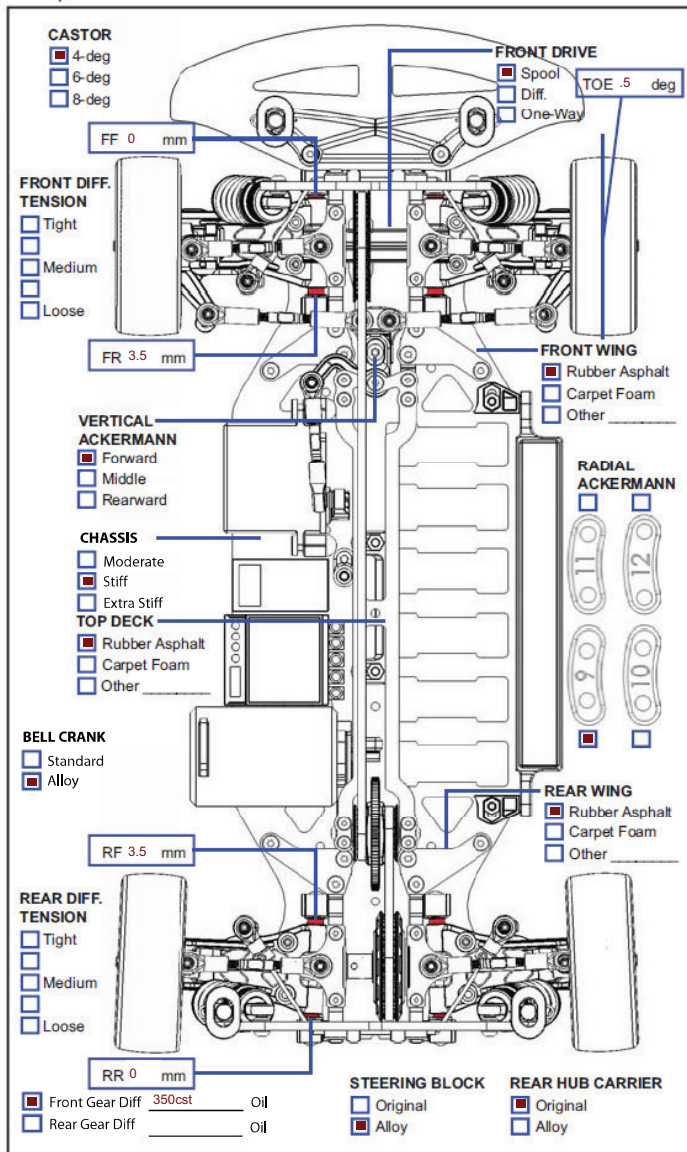

Name: Brent Klingforth Date: 05-06-12 Track: HobbyTown FC

Condition: Low grip Temperature: 65 F  Asphalt  Carpet



**MARK POSITION**

1.0 mm 2 holes  1.2 mm 2 holes   
 1.0 mm 3 holes  1.2 mm 3 holes

FRONT MEASUREMENTS			FRONT SHOCKS		
RIDE HEIGHT	6	mm	OIL WEIGHT	45	wt
CAMBER ANGLE	1	deg	PISTON	Standard/Optional	
DROOP	2	mm	BLADDER	std	
WHEEL HUBS	std	mm	SPRING	344	
WHEEL SPACER	0	mm	NOTE		

**MARK POSITION**

1.0 mm 2 holes  1.2 mm 2 holes   
 1.0 mm 3 holes  1.2 mm 3 holes

REAR MEASUREMENTS			REAR SHOCKS		
RIDE HEIGHT	6	mm	OIL WEIGHT	40	wt
CAMBER ANGLE	1.5	deg	PISTON	Standard/Optional	
DROOP	3	mm	BLADDER	std	
WHEEL HUBS	std	mm	SPRING	289	
WHEEL SPACER	0	mm	NOTE		

MOTOR	17.5			
SPUR GEAR	84			
PINION GEAR	44			
BATTERY				
BODY SHELLS	LTC-R			
WING				
ESC SETTING	No timing			

	FRONT	REAR
BRAND	Muchmore	Muchmore
COMPOUND	28	28
INSERT		
WHEEL		
TIRE TREATMENT	none	none

FL FR RL RR

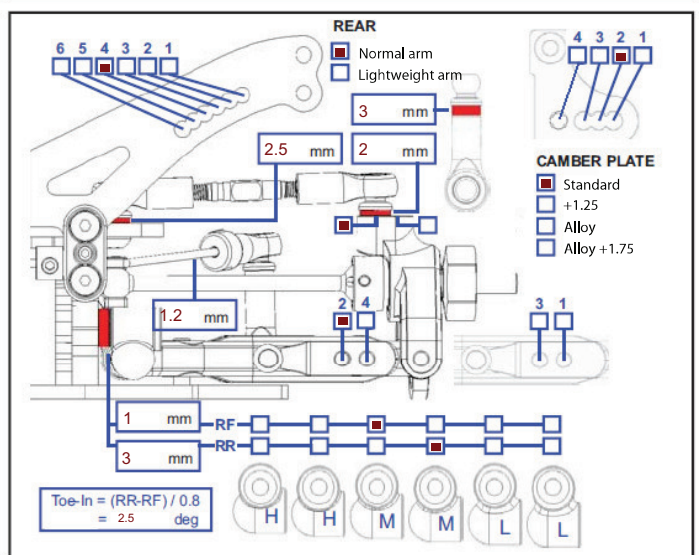
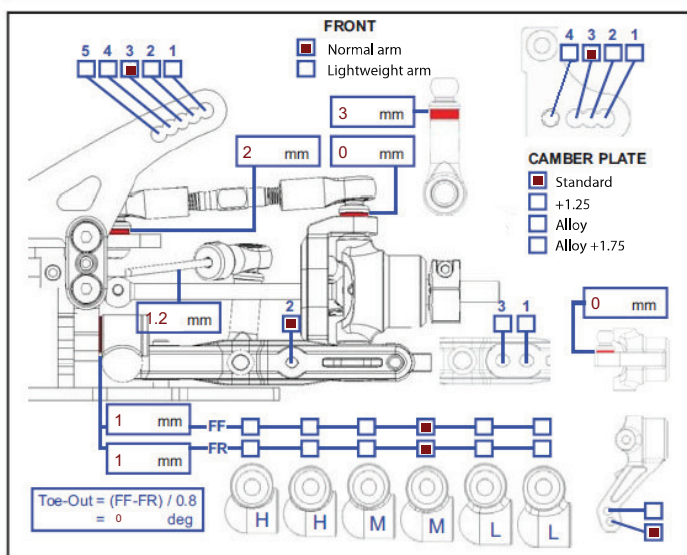

Photon Editable Setup Sheet V2 by Claudio Cantoni & FRAMEGA info@framega.com

Removed inner top deck screws, loosened rear wing screws. Was using Muchmore Absolute 28's car is very fast in the morning. If track temps increase by 30+deg from morning temps switch to 32's.

