

TRACK CONDITIONS

Type: Carpet Asphalt Size: Open Med. Tight
 Place: Indoor Outdoor Traction: High Med. Low
 Surface: Smooth Med. Bumpy Track Temp/Air Temp: _____ / _____

Note: Dry setup / Saturday

FRONT SUSPENSION

Track Width: _____ mm Gear Diff _____ wt
 Toe Angle: 1 ° One Way
 Caster: 4 ° Spool
 Camber: 1.5 °
 Ride Height: 5.4 mm Anti-Roll Bar: \varnothing 1.3 mm
 Down Stop: 6 mm

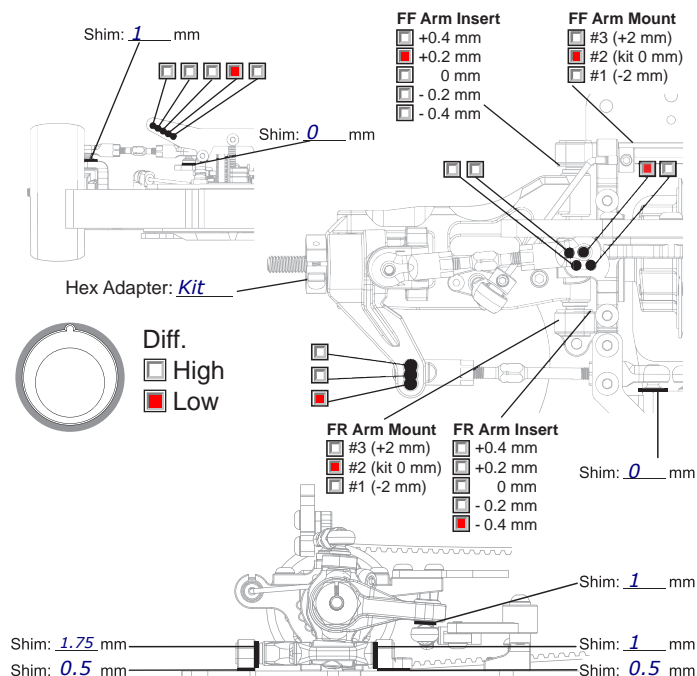

REAR SUSPENSION

Track Width: _____ mm Gear Diff 5'000 LRP wt
 Toe Angle: 2.7 °
 Camber: 1.5 °
 Ride Height: 5.6 mm
 Down Stop: 4 mm Anti-Roll Bar: \varnothing 1.2 mm

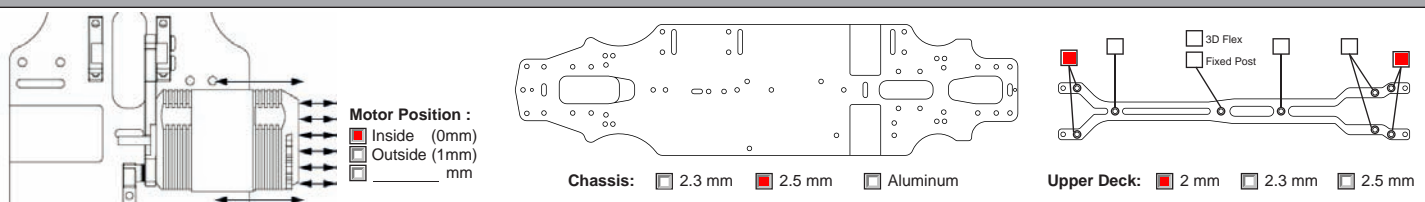
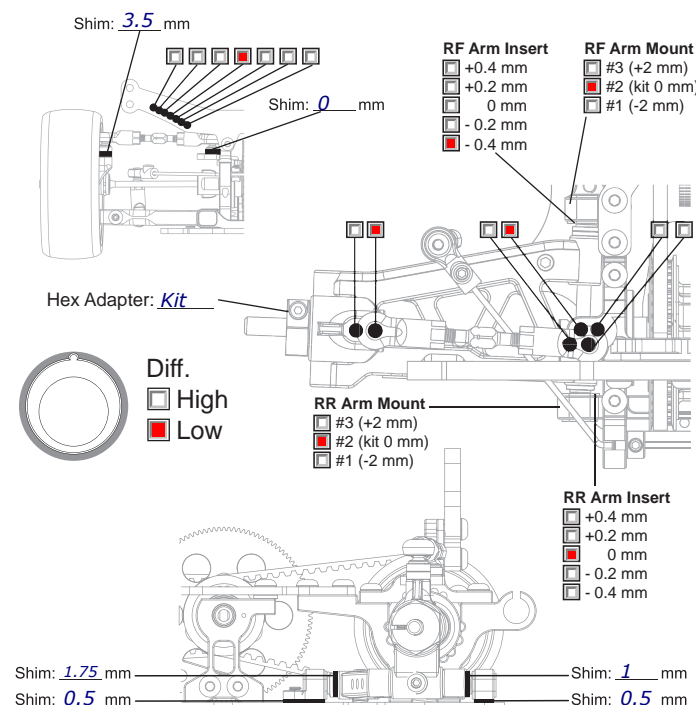

ELECTRONICS

Servo: _____
 ESC: LRP Works Team
 Battery: IP6000

MOTOR

Brand: Trinity
 Turns: 10.5
 Timing: _____

ESC

Punch: _____
 Initial Brake: _____
 Drag Brake: _____
 ESC Timing Turbo Timing

DRIVE RATIO

Spur $\frac{T}{T} \times 1.9 =$ 0.00
 Pinion

TIRES

Insert: MuchMore Volante
 Wheel: _____
 Shore/deg: _____
 Compound: 36
 Tire Temp: _____
 Tire additive: Hudy

Treated Area

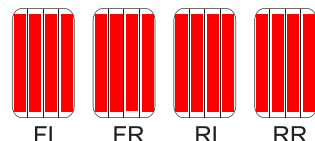

SHOCKS

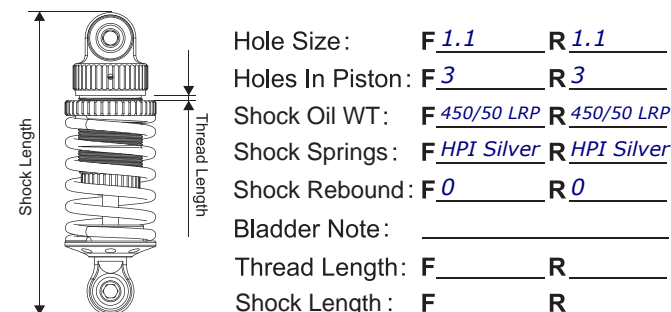

BODY

