

TRACK CONDITIONS

Type: Carpet Asphalt Size: Open Med. Tight
 Place: Indoor Outdoor Traction: High Med. Low
 Surface: Smooth Med. Bumpy Track Temp/Air Temp: 23 / 20

Note: 3rd Final. Good grip and rotation through corners. Additive 20min, rub dry and heat again for 5min.

FRONT SUSPENSION

Track Width: _____ mm Gear Diff _____ wt
 Toe Angle: 1 ° One Way
 Caster: 4 ° Spool
 Camber: 1,5 °
 Ride Height: 5,2 mm Anti-Roll Bar: Ø 1,3 mm
 Down Stop: 6 mm

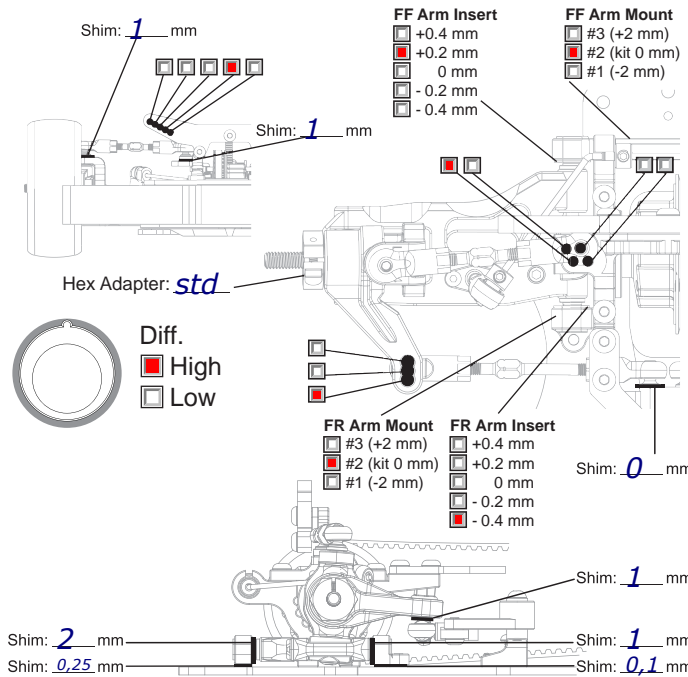

REAR SUSPENSION

Track Width: _____ mm Gear Diff 2000 wt
 Toe Angle: 2,5 °
 Camber: 1,5 °
 Ride Height: 5,4 mm
 Down Stop: 5 mm Anti-Roll Bar: Ø 1,2 mm

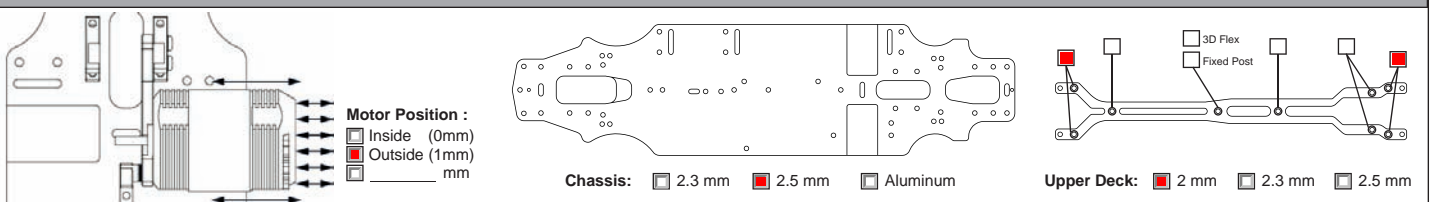
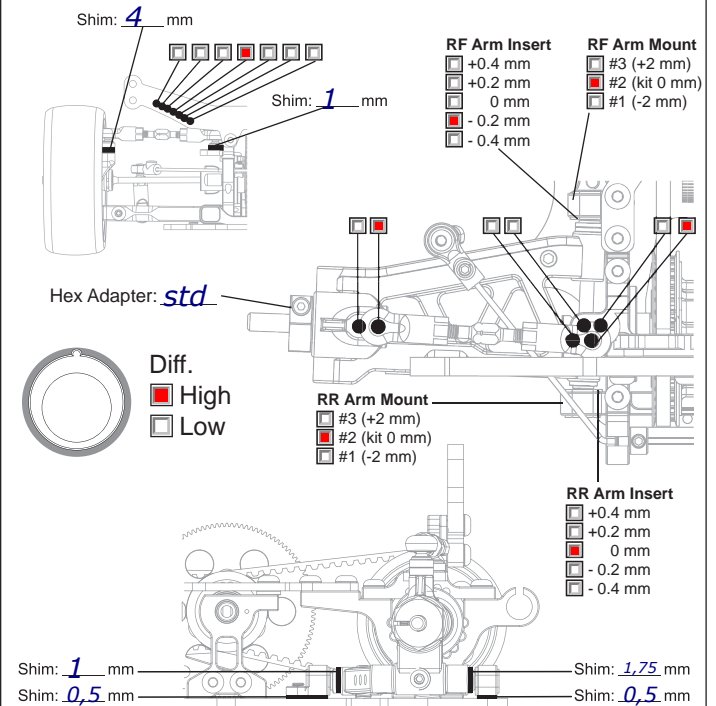

ELECTRONICS

Servo: Sanwa
 ESC: Fleta euro
 Battery: LRP 5800

MOTOR

Brand: MuchMore
 Turns: 13,5
 Timing: 0

ESC

Punch: 9
 Initial Brake: drag
 Drag Brake: 0
 ESC Timing Turbo Timing
blinky

DRIVE RATIO

Spur 76 T
 Pinion 32 T $\times 1.9 =$ 4.51

TIRES

Insert: _____
 Wheel: Sorex 32R
 Shore/deg: _____
 Compound: _____
 Tire Temp: 60
 Tire additive: HRC 6002
 Treated Area

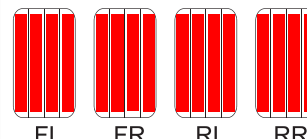

SHOCKS

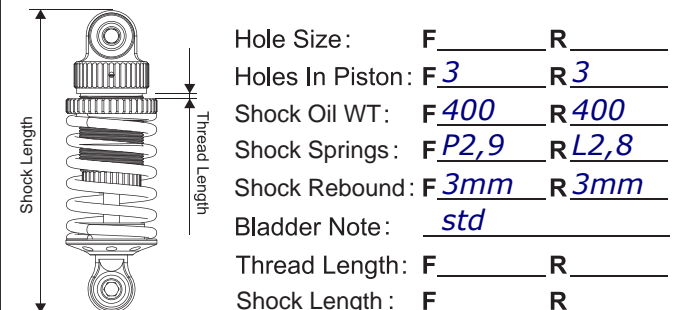

BODY

