

**TRACK CONDITIONS**

Type :  Carpet  Asphalt      Size:  Open  Med.  Tight  
 Place :  Indoor  Outdoor      Traction:  High  Med.  Low  
 Surface:  Smooth  Med.  Bumpy      Track Temp/Air Temp: \_\_\_\_\_ / \_\_\_\_\_  
 Note: \_\_\_\_\_

**FRONT SUSPENSION**

Track Width: \_\_\_\_\_ mm       Gear Diff \_\_\_\_\_ wt  
 Toe Angle: 1 °       Spool  
 Caster: 4 °  
 Camber: 2 °  
 Ride Height: 5,2 mm      Anti-Roll Bar: Ø 1.3 mm  
 Down Stop: 5,6 mm

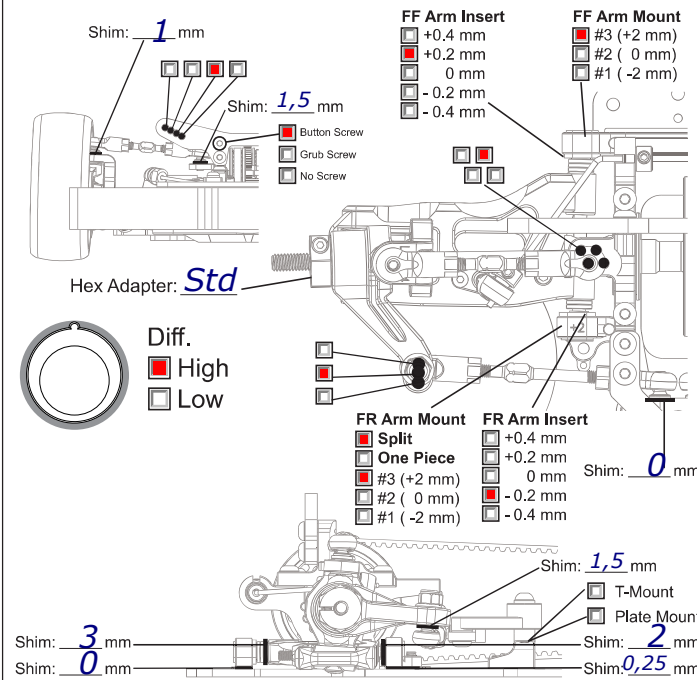

**REAR SUSPENSION**

Track Width: \_\_\_\_\_ mm      Gear Diff 5000 wt  
 Toe Angle: 2,7 °  
 Camber: 2 °  
 Ride Height: 5,4 mm  
 Down Stop: 4,6 mm      Anti-Roll Bar: Ø 1,3 mm

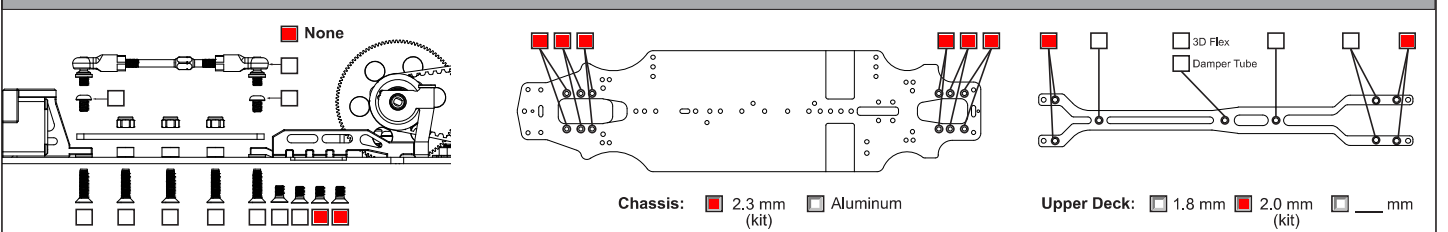
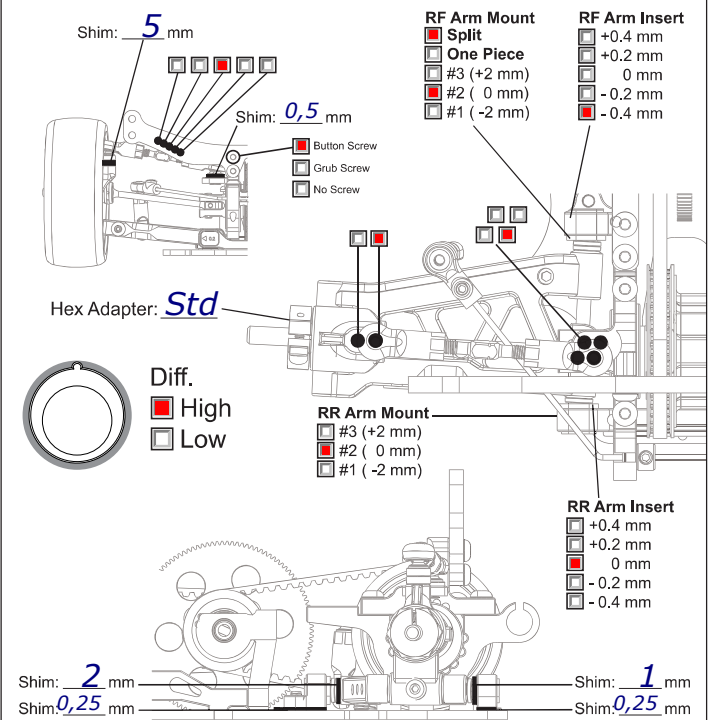

**ELECTRONICS**

Servo: Kopropo bsx2 response  
 ESC: Nosram hd  
 Battery: 6400 nosram

**DRIVE RATIO**

Spur 110 T  
 Pinion 27 T  $\times 1.9 =$  7.74

**MOTOR**

Brand: Lrp 4.5T  
 Turns: \_\_\_\_\_  
 Timing: \_\_\_\_\_

**TIRES**

Insert: \_\_\_\_\_  
 Wheel: Team Power 35  
 Shore/deg: \_\_\_\_\_  
 Compound: \_\_\_\_\_  
 Tire Temp: \_\_\_\_\_  
 Tire additive: Cs high grip  
 Treated Area

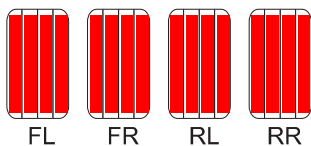

**SHOCKS**

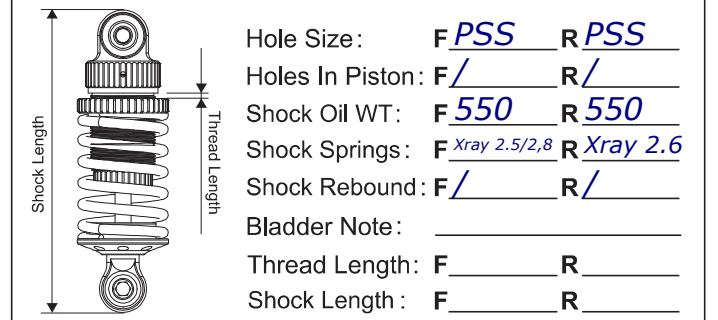

**ESC**

Punch: \_\_\_\_\_  
 Initial Brake: \_\_\_\_\_  
 Drag Brake: \_\_\_\_\_  
 ESC Timing  Turbo Timing

**BODY**

